



Brompton Park Crescent, SW6

£634 Per week

A modern two double bedroom, two bathroom in the gated development of Brompton Park Crescent. This property has built in storage in both bedrooms, wooden flooring throughout and a separate utility room. It also has two balconies, lift access and access to the amenities of the development which include a gym and pool.

The apartment is situated within this sought after and superb gated development offering extensive facilities and is located within a short walk of West Brompton and Fulham Broadway stations.

Features

- Two Bedrooms
- Two Bathrooms
- Wooden Flooring
- Swimming Pool
- Gym
- Gated Development

Brompton Park Crescent, London, SW6

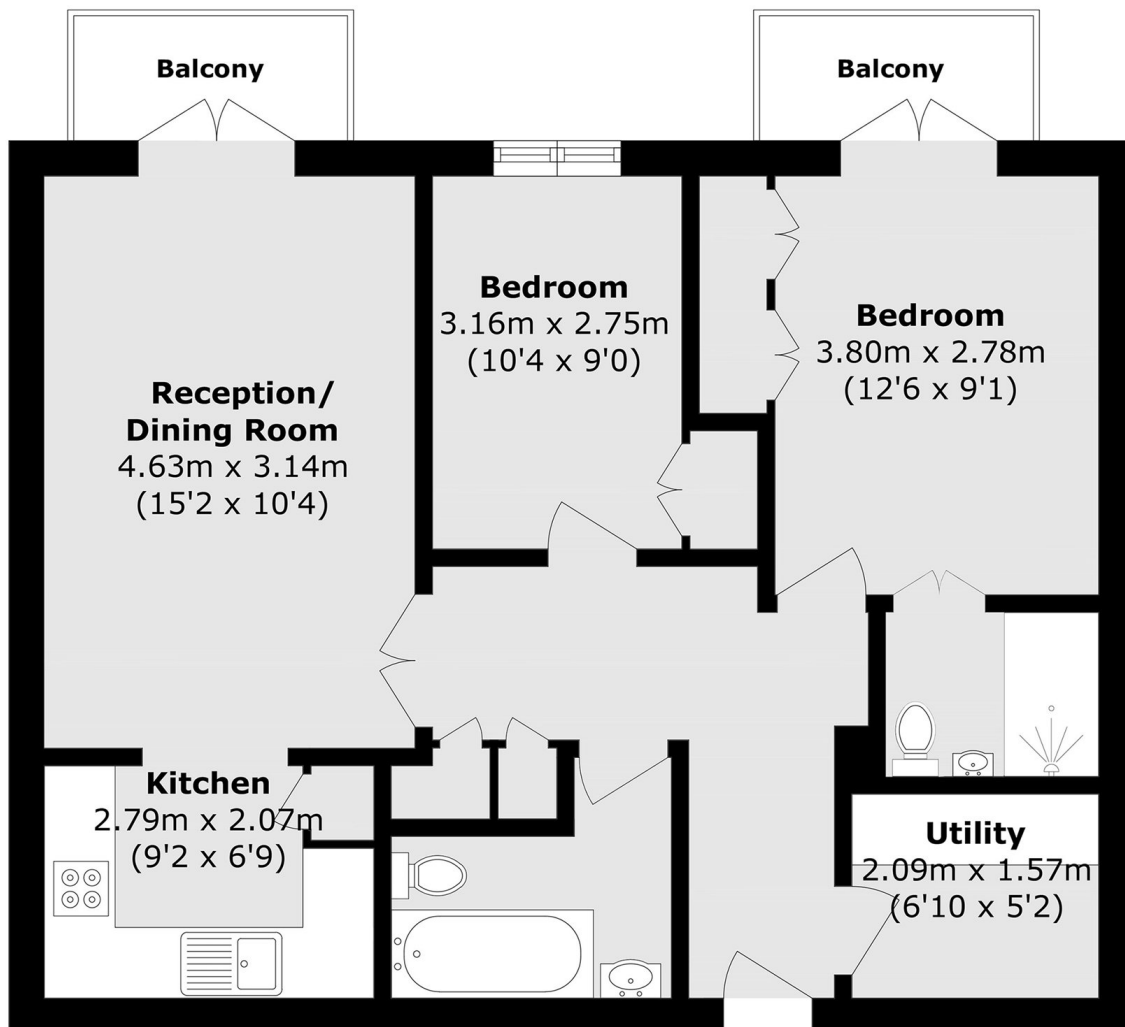

Total area (approx.): 62.2 sq. m (669.5 sq. ft)

Balcony area (approx.): 5.3 sq. m (57.0 sq.ft)