



London Road, Carlisle **£169,995**





YOUR MOVE





London Road, Carlisle

£169,995

Property Description

** A THREE BEDROOM, TWO RECEPTION ROOM TRADITIONAL SEMI DETACHED HOUSE SITUATED TO THE SOUTH OF THE CITY WITH GARDENS, DRIVEWAY AND GARAGE ** The double glazed and gas central heated accommodation briefly comprises spacious entrance hall with storage area and access to downstairs WC, front reception room with bay window, rear reception room and bright kitchen with access to the rear. To the first floor there are three good size bedrooms, bathroom and separate WC. Outside there are front and rear gardens, driveway and small garage. EPC Grade C.

Our View

We are pleased to offer for sale this traditional semi detached house conveniently situated to the south of the city close to local amenities and the M6 motorway. This property would be great for a family looking for spacious accommodation, gardens and driveway.

Location

Located to the South of the City within easy access of local shops, schools, retail parks, supermarkets and bus routes. Access to the M6 junction 43.



EPC Grade C
For full EPC please contact the branch



Ground Floor

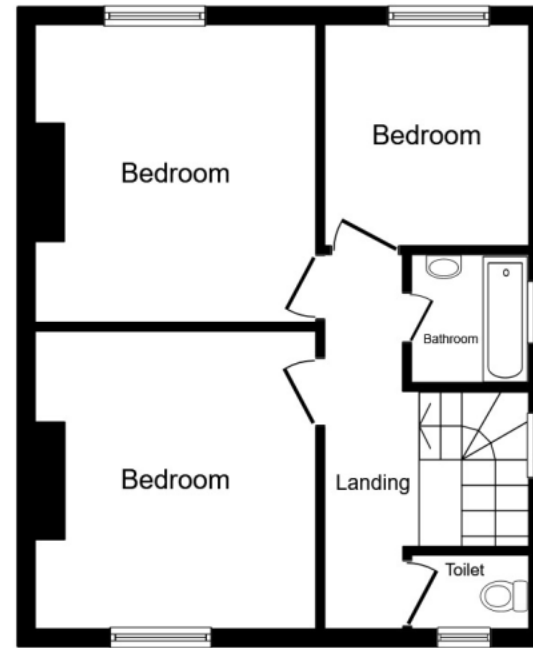

First Floor

Total floor area 90.0 sq. m. (969 sq. ft.) approx

This floor plan is for illustrative purposes only. It is not drawn to scale. Any measurements, floor areas (including any total floor area), openings and orientation are approximate. No details are guaranteed, they cannot be relied upon for any purpose and they do not form part of any agreement. No liability is taken for any error, omission or misstatement. A party must rely upon its own inspection(s).
Plan produced for Your Move. Powered by www.focalagent.com

IMPORTANT NOTE TO PURCHASERS: We endeavour to make our sales particulars accurate and reliable, however, they do not constitute or form part of an offer or any contract and none is to be relied upon as statements of representation or fact. The services, systems and appliances listed in this specification have not been tested by us and no guarantee as to their operating ability or efficiency is given. All measurements have been taken as guide to prospective buyers only, and are not precise. Floor plans where included are not to scale and accuracy is not guaranteed. If you require clarification or further information on any points, please contact us, especially if you are travelling some distance to view. Fixtures and fittings other than those mentioned are to be agreed with the seller.

Your Move is a trading name of your-move.co.uk, registered in England at Newcastle House, Albany Court, Newcastle Business Park, Newcastle upon Tyne NE4 7YB (number 01864469).

19 Fisher Street, Carlisle, CA3 8RF

01228 537333 * carlisle@your-move.co.uk

*Calls may be recorded and/or monitored for training and/or security purposes.

