



Guide Price
£425,000

Freehold

2x  1x  1x 

**Priors Close,
Southbourne, West
Sussex, PO10**

OVER 60?

Secure this property
for up to **59% less!**

cubitt & west
Helping you move forwards



Main features

- Immaculately presented semi detached bungalow
- Potential to extend further STP
- Double bedrooms
- Stylish fitted kitchen / breakfast room
- Garage & driveway
- Highly requested location

Accommodation

GROUND FLOOR

Entrance Hall

Lounge : 16'11 x 11'11 (5.16m x 3.63m)

Kitchen/Diner: 11'11 x 11'3 (3.63m x 3.43m)

Bedroom 1: 11'11 x 9'11 (3.63m x 3.02m)

Bedroom 2: 12'5 x 11'11 (3.79m x 3.63m)

Bathroom

Lean-To : 27'10 x 4'1 (8.49m x 1.25m)

OUTSIDE

Front & Rear Gardens

Garage & Driveway

Ground Floor
Approx. 92.8 sq. metres (998.7 sq. feet)

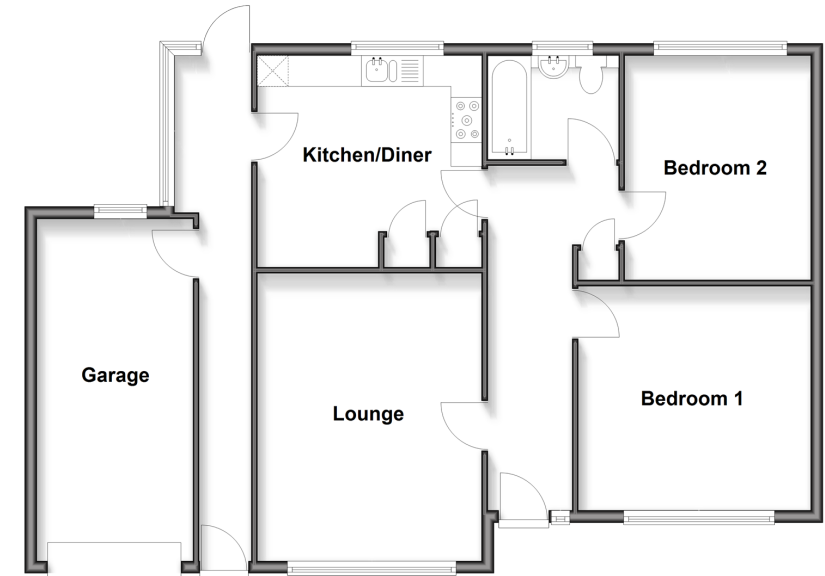

Call Emsworth - 01243 377888 ■ cubittandwest.co.uk

- Legal advice should be taken to verify fixtures/fittings, planning, alterations and/or lease details
- Appliances & services are untested, dimensions are approximate and floor plans are not to scale
- Through a Homewise Home For Life Plan people aged 60+ can secure this property for up to 59% less, by purchasing a Lifetime Lease



44607866/20260105/SR/KC