



COCKBURN
ESTATE AND LETTINGS AGENTS

cockburn-online.co.uk

Avery Hill Road, New Eltham, SE9

Offers Over £255,000

🛏 2 🚿 1 🛋 1



- Chain Free Sale
- Quiet Residential Block Of Just Four Flats
- Private Allocated Parking
- Walking Distance To New Eltham Railway Station
- Excellent Bus Links Keeping You Connected With Greenwich, Eltham & Chislehurst
- Two Bedroom Ground Floor Apartment
- Long Lease Length
- Communal Garden Space
- Ideally Located For New Eltham Village Shops, Eateries & Amenities
- Council Tax Band C - Royal Borough of Greenwich



*** CHAIN FREE SALE ***

Introducing Avery Hill Road - An Ideal First Time Purchase Or
Buy To Let Investment!

Lease Length 169 Years | Service Charge £1,800.00 Per Annum
| Ground Rent £135.00 Per Annum (approx)

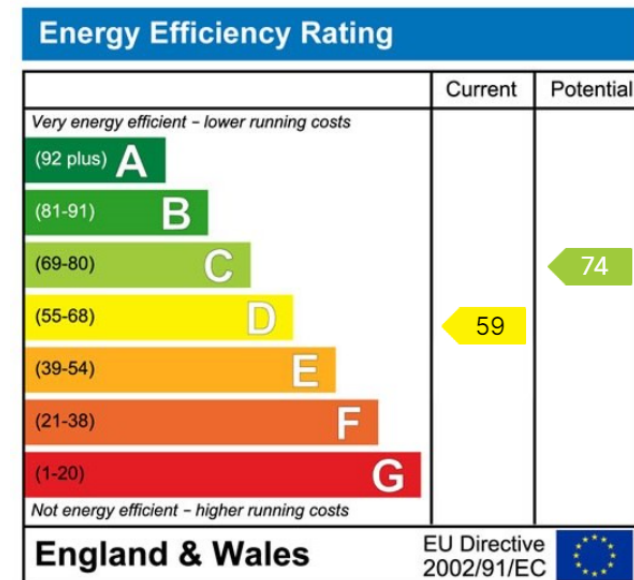
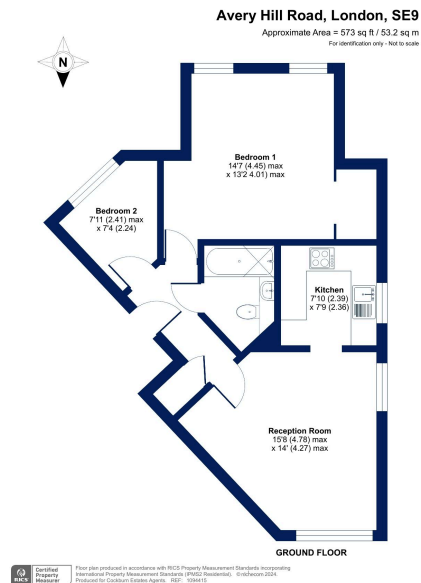

Cockburn EA

352 Footscray Road,
London, SE9 2EB

t: 020 8859 8590