



# Coster Avenue, London N4

£485,000 Leasehold







## Description

Nestled in the heart of Woodberry Down, Hartingtons Court represents contemporary urban living at its finest. This prestigious gated development offers an exceptional lifestyle package creating a resort-style atmosphere within the capital.

This immaculately presented one-bedroom apartment showcases sleek, contemporary design with a sophisticated neutral palette throughout. The open-plan living space is flooded with natural light, enhanced by floor-to-ceiling windows that frame views across the development. The modern kitchen features integrated appliances and stylish cabinetry, whilst the bedroom provides a peaceful retreat with ample storage. The contemporary bathroom is finished to an impressive standard with quality fixtures and fittings. A private balcony extends the living space outdoors, perfect for morning coffee or evening relaxation.

Woodberry Down has undergone one of London's most significant regenerations, transforming into a sought-after waterside neighbourhood. The area is distinguished by the stunning Woodberry Wetlands nature reserve, offering 11 hectares of natural beauty with reservoirs, woodland, and wildlife just moments from home. The surrounding streets are served by an emerging selection of cafes, restaurants, and local amenities, whilst nearby Finsbury Park provides extensive parkland and vibrant community life.

Transport connections are exceptional, with Finsbury Park Station providing Victoria and Piccadilly line services alongside National Rail links to King's Cross, Moorgate, and beyond. Manor House station offers additional Piccadilly line access, whilst excellent bus routes connect to Angel, Highbury, and central London. Cycling routes through the wetlands and park offer alternative commuting options.

Whether seeking a stylish first home, a premium base in the capital, or a sound investment opportunity, this apartment delivers contemporary luxury with unparalleled amenities in one of North London's most exciting regeneration areas.

- Large private balcony
- Abundant natural light
- Secure gated development
- Excellent transport connectivity
- Finsbury Park moments away
- Modern luxury living

# Floorplan

543 sq ft | 50 sq m

## Hartingtons Court, N4

Approximate Gross Internal Area = 50.5 sq m / 543 sq ft

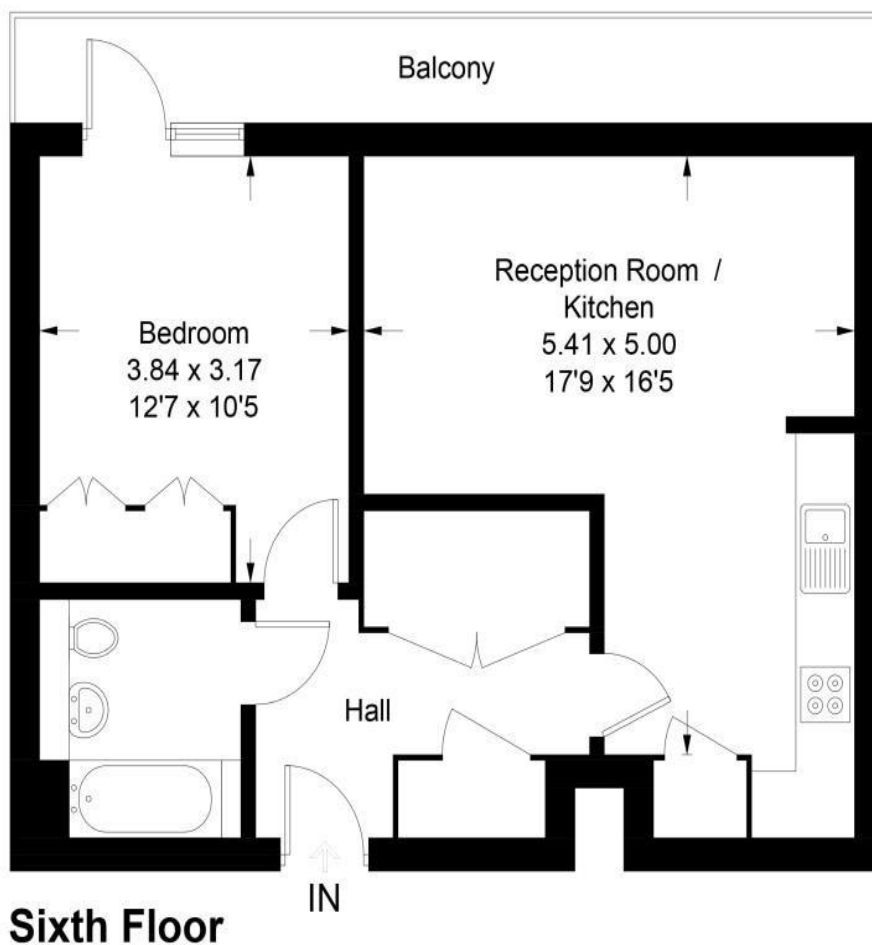

Illustration for identification purposes only, measurements are approximate, not to scale. Fourlabs.co © (ID1305633)

Finsbury Park  
Woodberry Park,  
London N4 2BL  
0203 147 1964  
lettingsfinsburypark@eu.jll.co

*Urban living, your way.*

[jll.co.uk/residential](http://jll.co.uk/residential)

© 2019 Jones Lang LaSalle IP, Inc. All rights reserved. All information contained herein is from sources deemed reliable; however, no representation or warranty is made to the accuracy thereof.

