

Aylsham Drive

Ickenham • Middlesex • UB10 8UN

PCM: £1,650 PCM



coopers
est 1986

A LARGER THAN AVERAGE TWO bedroom apartment, situated on the POPULAR Brackenbury Village development which is ideally located for West Ruislip Station (Central Line & Overground). This EXCEPTIONAL property is also within WALKING DISTANCE of Ickenham Station (Metropoltian & Piccadilly Lines), Ickenham Village with its vast array of shops & amenities and several local schools. Briefly comprising two well-proportioned double bedrooms, spacious lounge, kitchen/breakfast room and family bathroom. This superb property also benefits from gas central heating, double glazing, allocated parking and secure entry phone system.

Top Floor

Close To West Ruislip Tube Station

Close To Ickenham Tube Station

Gas Central Heating

Entry Phone System

Off Street Parking

Spacious Throughout

Parking

Unfurnished

Available Date

20th June 2026

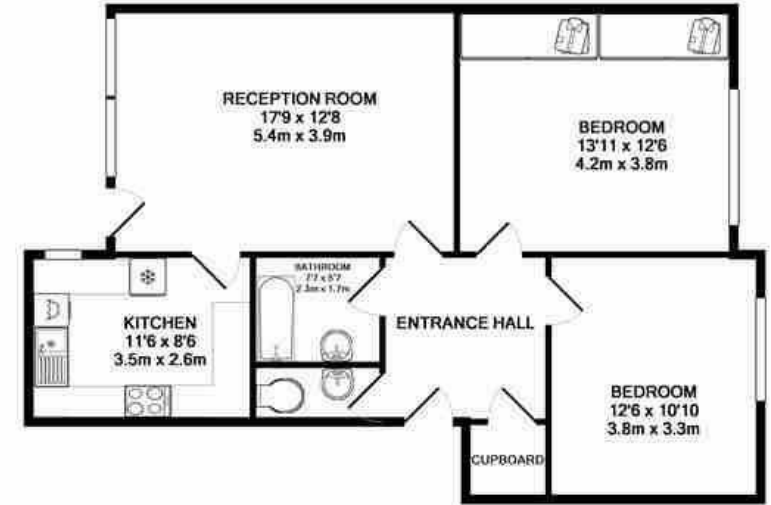

TOTAL APPROX. FLOOR AREA 783 SQ.FT. (72.7 SQ.M.)
 Whilst every attempt has been made to ensure the accuracy of the floor plan contained here, measurements of doors, windows, rooms and any other items are approximate and no responsibility is taken for any error, omission, or mis-statement. This plan is for illustrative purposes only and should be used as such by any prospective purchaser. The services, systems and appliances shown have not been tested and no guarantee as to their operability or efficiency can be given.
 Made with Metropix ©2014.

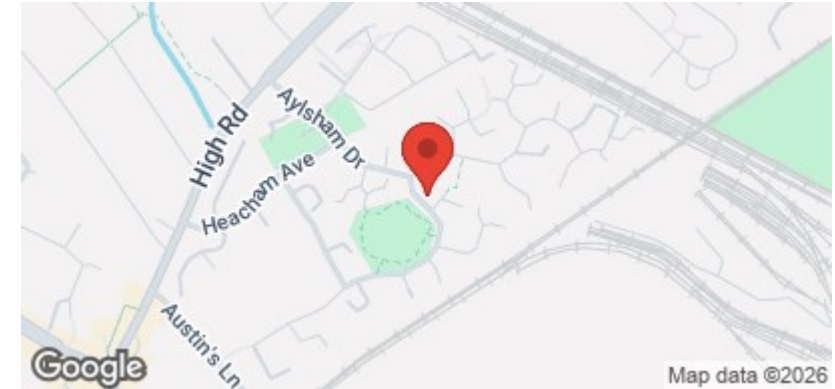

01895 625 625
 126-128 High Street, Ruislip,
 Middlesex, HA4 8LL
 rl@coopersresidential.co.uk

CoopersResidential.co.uk

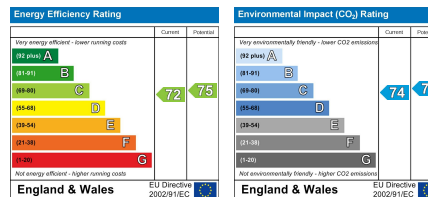

Important Notice: These particulars, whilst believed to be accurate are set out as a general outline only for guidance and do not constitute any part of an offer or contract. Intending purchasers should not rely on them as statements or representation of fact, but must satisfy themselves by inspection or otherwise has the authority to make or give any representation or warranty in respect of the property.

