



White Laithe Close, Leeds    £129,995

 **YOUR MOVE**  
Barrett Hynes



**IMPORTANT NOTE TO PURCHASERS:** We endeavour to make our sales particulars accurate and reliable, however, they do not constitute or form part of an offer or any contract and none is to be relied upon as statements of representation or fact. The services, systems and appliances listed in this specification have not been tested by us and no guarantee as to their operating ability or efficiency is given. All measurements have been taken as guide to prospective buyers only, and are not precise. Floor plans where included are not to scale and accuracy is not guaranteed. If you require clarification or further information on any points, please contact us, especially if you are travelling some distance to view. Fixtures and fittings other than those mentioned are to be agreed with the seller.



## Description

**\*\*NO CHAIN\*\*** A good sized end terrace property situated within this very popular area which is ideally placed for the regions amenities and road networks. The property which has a gas central heating system and double glazed windows briefly comprises the following accommodation: Entrance porch, dining kitchen, spacious living room with French doors leading out to the rear garden, three first floor bedrooms and a bathroom. Externally there are enclosed gardens to the front and rear and a single garage. EPC rating D

## Council Tax

## EPC

EPC Rating D

For full EPC please contact the branch.

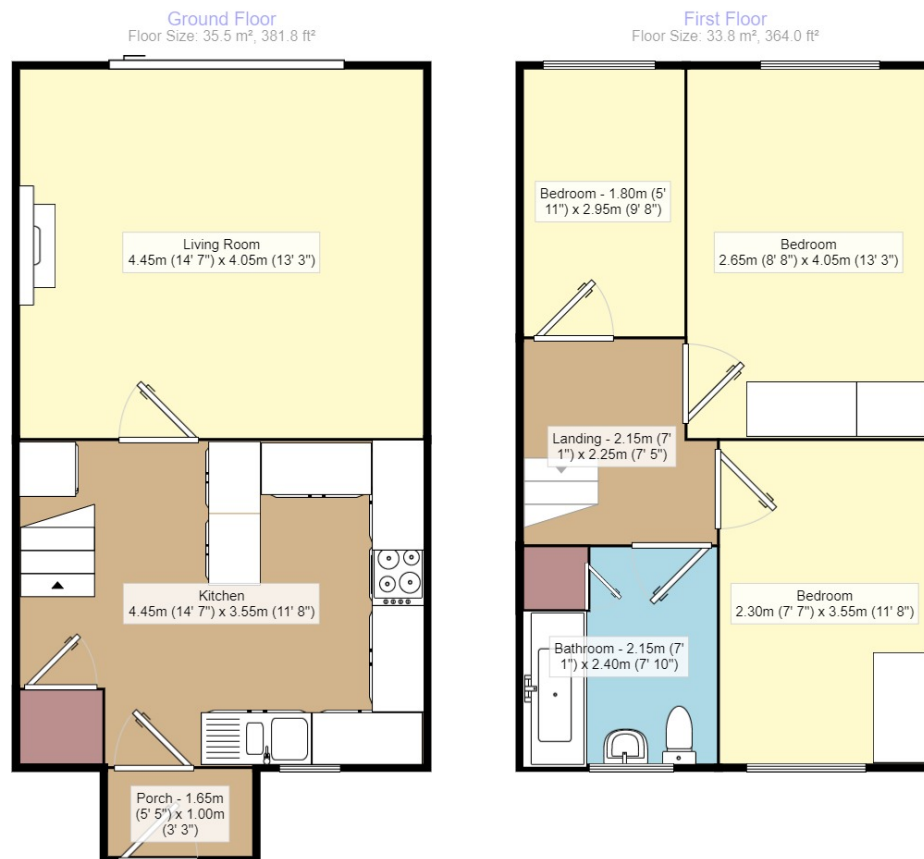

Measurements are approximate. Not to scale. For illustrative purposes only.

50 Austhorpe Road, Leeds, LS15 8DX

0113 2641664 \* LeedsEast@your-move.co.uk



**YOUR MOVE**

Barrett Hynes

[your-move.co.uk](http://your-move.co.uk)