



SUSSEX WAY, N7

£350,000

One Double Bedroom
Share of Freehold
Living Room
Separate Kitchen
No Onward Chain
Close to Amenities

@marshandparsons
marshandparsons.co.uk

MARSH &
PARSONS



ABOUT THE PROPERTY

A top-floor, one-bedroom period conversion featuring a modern bathroom, a spacious double bedroom, and a bright living room with a separate kitchen. Offered to the market with a share of freehold and no onward chain.

Sussex Way is just a short walk from Holloway Road, offering an abundance of restaurants, bars, and supermarkets, and is also within walking distance of green spaces such as Whittington Park.



STEP INSIDE SUSSEX WAY

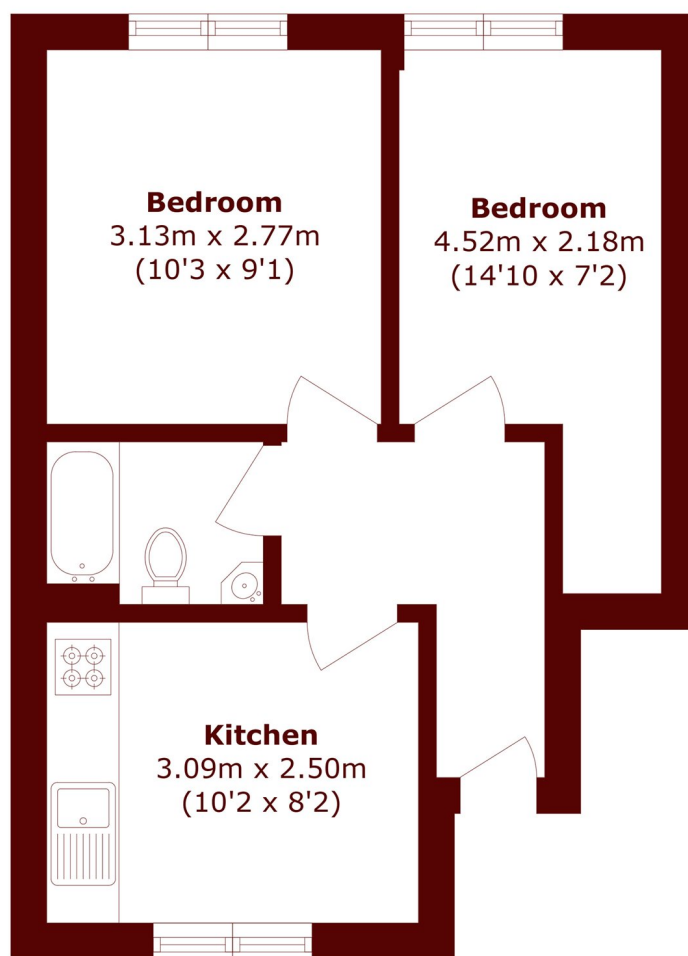

Total area (approx.): 33.1 sq. m (356.2 sq. ft)

Camden
020 7244 2200

Energy Rating: C We aim to make our particulars both accurate and reliable. However, they are not guaranteed; nor do they form part of an offer or contract. If you require clarification on any points then please contact us, especially if you're traveling some distance to view. Please note that appliances and heating systems have not been tested and therefore no warranties can be given as to their good working order

MARSH &
PARSONS