



Redmayne Arnold & Harris  
estate agents, letting agents & surveyors

rah.co.uk



TO LET



8 Knightly Avenue, Cambridge, Cambridgeshire, CB2 0AL

£2,000 Per Month

- Ground floor apartment
- Terrace
- Complete chain
- Allocated parking and bike store
- No chain
- Council tax band - E
- 2 beds, 1 recept, 2 baths
- Gas-fired heating to underfloor
- 2017
- EPC - B / 82
- Conveniently placed for Addenbrooke's and City centre

## THE PROPERTY

A beautifully presented ground floor apartment with private parking located within the award winning Ninewells Development, just a short walk/cycle from Addenbrooke's Campus and Cambridge City centre.

The open plan kitchen/dining/sitting room boasts a sunny dual aspect with French doors which lead to a north facing balcony.

There are two double bedrooms including the master bedroom with fitted wardrobes and a luxury ensuite shower room.

The property is managed by the landlord.

Council Tax: E

EPC Rating: B

Deposit: £2300

Holding Deposit: £390

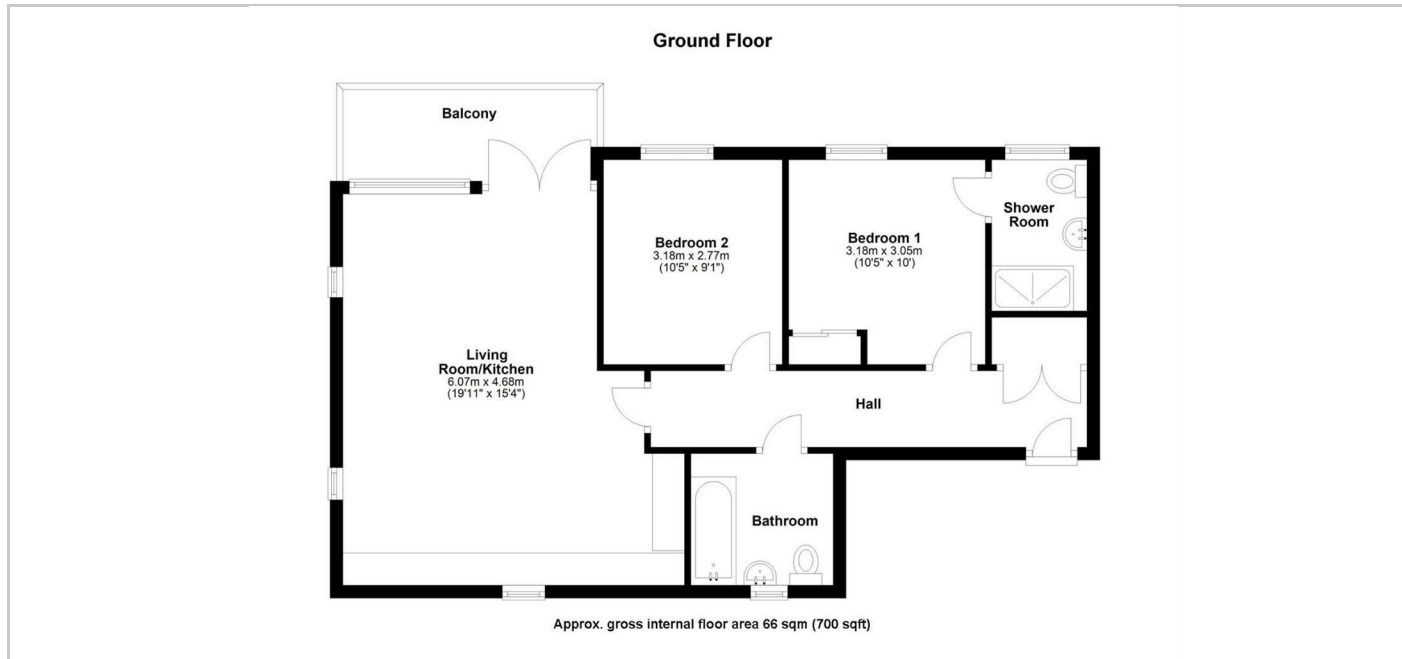

## SITUATION

## Directions

