

# 854 Uxbridge Road

Hayes • London • UB4 0RR  
PCM: £1,050 PCM



coopers  
est 1986

In a prime location close to Hayes Town Centre, with exceptional transport links to Uxbridge, Southall and Hayes. Also only a short drive to the M4, Stockley Business Park and the A40.

A bright and spacious studio apartment on Uxbridge Road, finished to a modern standard throughout. The property features an entrance hall leading into a generously sized living space, a stylish bathroom with both a bath and shower, and a separate, fully fitted kitchen.

Unfurnished.

Spacious Studio Apartment

Seperate Kitchen

Fantastic Condition

Gated Allocated Parking

Fantastic Transport Links

Unfurnished

Council Tax Band B

Lift

Close to M25

Available now

**Available Date**

1st April 2026

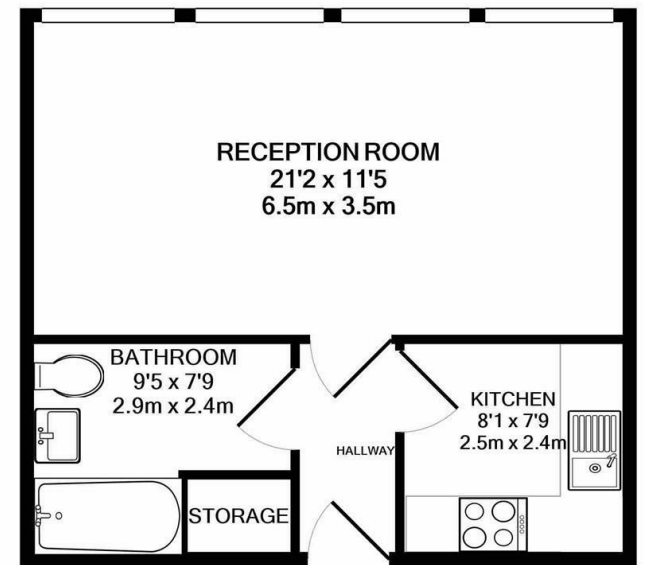

TOTAL APPROX. FLOOR AREA 404 SQ.FT. (37.5 SQ.M.)

Whilst every attempt has been made to ensure the accuracy of the floor plan contained here, measurements of doors, windows, rooms and any other items are approximate and no responsibility is taken for any error, omission, or mis-statement. This plan is for illustrative purposes only and should be used as such by any prospective purchaser. The services, systems and appliances shown have not been tested and no guarantee as to their operability or efficiency can be given  
Made with Metropix ©2020



**coopers**  
est 1986

**01895 230 103**

109 Hillingdon Hill, Hillingdon Village,  
Middlesex, UB10 0JQ  
propertymanagement@coopersresidential.co.uk

**CoopersResidential.co.uk**

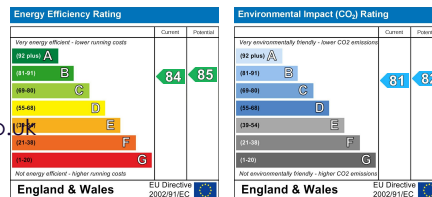

Important Notice: These particulars, whilst believed to be accurate are set out as a general outline only for guidance and do not constitute any part of an offer or contract. Intending purchasers should not rely on them as statements or representation of fact, but must satisfy themselves by inspection or otherwise has the authority to make or give any representation or warranty in respect of the property.