

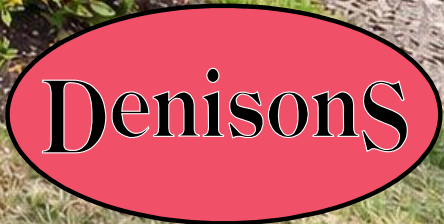

23

8

23 Burtoncroft



23 Burtoncroft

Burton, BH23 7HW

£465,000

This charming semi-detached house offers an ideal family home situated in a quiet cul-de-sac, providing a peaceful and private setting. The property boasts three well-sized bedrooms, two of which feature built-in wardrobes, offering ample storage space. The spacious, light, and airy lounge/diner is perfect for family living and features French doors that open out onto the low-maintenance rear garden, creating a seamless flow between indoor and outdoor spaces. The home presents huge potential for those looking to put their personal touch on a property, making it a fantastic opportunity for future growth. A detached garage with a convenient utility room located at the rear, along with driveway parking, add practicality and convenience. With no onward chain, the property is ready for immediate occupancy. Conveniently located close to the River Avon, local amenities, and well-regarded schools, this property is ideally positioned for both family life and outdoor enjoyment.



Entrance Hallway

Downstairs WC

Lounge/Diner 28' 7" x 11' 0" (8.72m x 3.36m)

Kitchen 11' 10" x 7' 8" (3.60m x 2.34m)

First Floor Landing

Bedroom One 15' 4" x 11' 0" (4.67m x 3.36m)

Bedroom Two 13' 5" x 11' 0" (4.08m x 3.36m)

Bedroom Three 8' 0" x 7' 8" (2.43m x 2.34m)

Family Bathroom 7' 8" x 6' 7" (2.34m x 2m)

Garden Store/Utility Room 9' 6" x 7' 8" (2.90m x 2.34m)

Garage 18' 1" x 7' 8" (5.51m x 2.34m)

Driveway



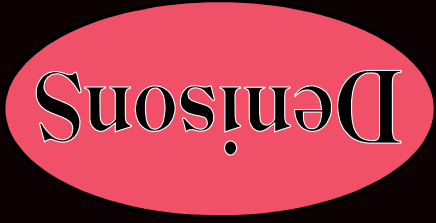

Denisons for themselves and for the Vendors or lessors of this property, whose Agents they are, give notice that these particulars are produced in good faith, are set out as a general guide only and do not constitute any part of a Contract. No person in the employment of Denisons has any authority to make or give any representation or warranty whatever in relation to this property.

www.denisons.com

Mayfair
 Cashel House, London, W1U 3JT
0870 112 7099
 mayfair@denisons.com

Christchurch
 12 Castle Street, Christchurch BH23 1DT
01202 484748
 christchurch@denisons.com

Score	Energy rating	Potential
1-20	G	
21-38	F	
39-54	E	
55-68	D	
69-80	C	75 C
81-91	B	88 B
92+	A	

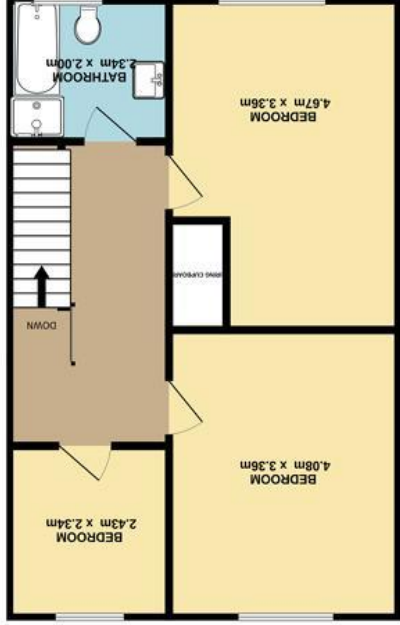

1ST FLOOR
 49.9 sq. m. approx.



GROUND FLOOR
 71.8 sq. m. approx.

