

Castles



OFFERS IN EXCESS OF

£189,950

Hickory Close

Edmonton, N9 7PZ

PROPERTY SUMMARY

A one bedroom first floor purpose built Apartment situated on this popular development located on the Galliard Estate N9. The property comprises of Hall, bathroom, lounge kitchen and bedroom and has features to include, allocated parking and double glazing.

Information regards the property have been given to us by the owner





APPROXIMATE GROSS INTERNAL AREA
32.90 sqm / 354.13 sqft

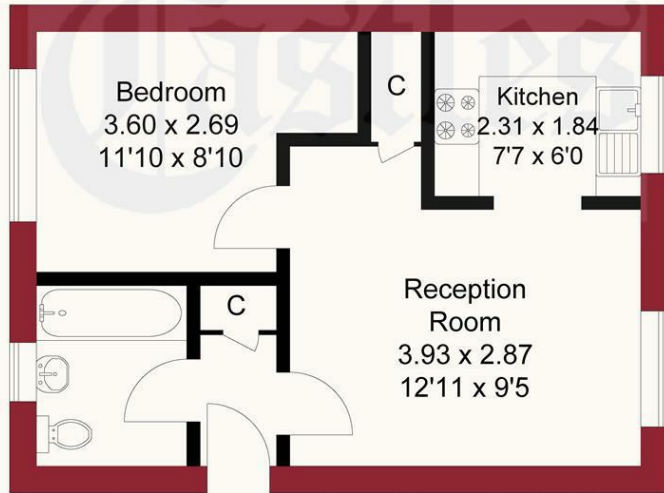

FIRST FLOOR

THIS PLAN IS FOR ILLUSTRATION ONLY AND MAY NOT BE
REPRESENTATIVE OF THE PROPERTY

For a guide to the area
please scan this code for
more information

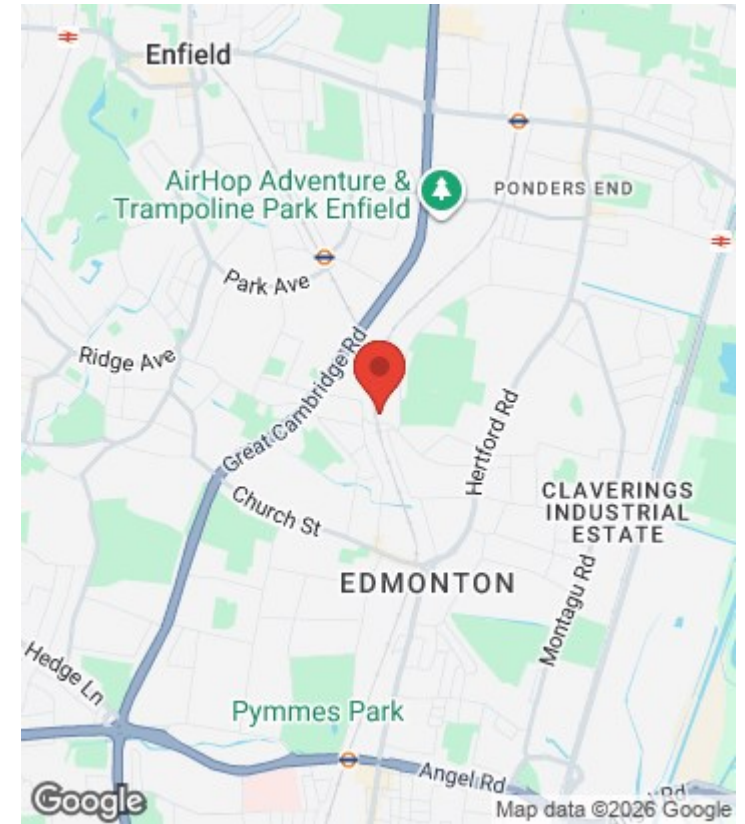

Apartment - First Floor

Leasehold

Council:

Council Tax Band: B

Agents Note: Whilst every care has been taken to prepare these particulars, they are for guidance purposes only. All measurements are approximate and are for general guidance purposes only and whilst every care has been taken to ensure their accuracy, they should not be relied upon and potential buyers/tenants are advised to recheck the measurements



OFFICE ADDRESS

438 Hertford Road
Edmonton
London
N9 8AB

OFFICE DETAILS

020 8804 8123
edmonton@castles.london
<https://www.castles.london/>

