

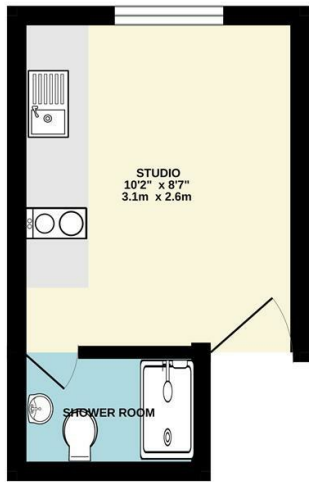

GROUND FLOOR
108 sq.ft. (10.0 sq.m.) approx.

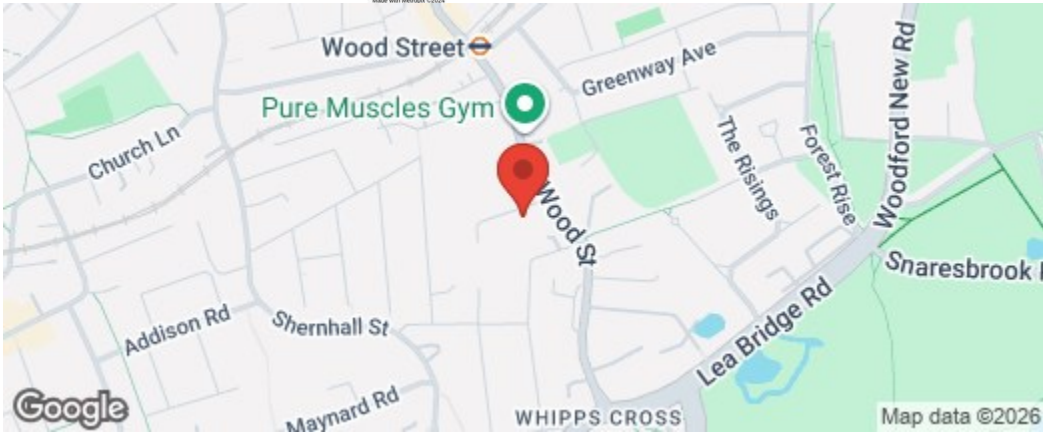

TOTAL FLOOR AREA: 108 sq.ft. (10.0 sq.m.) approx.
While every attempt has been made to ensure the accuracy of the figures contained here, measurements of plots, sections, areas and any other items are approximate and no responsibility is taken for any errors, omissions or misstatements. This plan is for guidance purposes only and should be used as a guide only. Prospective purchasers should verify the accuracy of the figures and measurements themselves. Map data ©2026



EPC | D

Council Tax | INCLUSIVE

5 Week Security Deposit |
£980.00

12 Month Tenancy | 6 Month
Break Clause

The Agent has not tested any apparatus ,equipment, fixtures and fittings or services and so cannot verify that they are in working order or fit for the purpose. A buyer is advised to obtain verification from their solicitor or surveyor.
References to the tenure of a property are based on information supplied by the seller. The agent has not had the sight of the title documents. A buyer is advised to obtain verification from their solicitors.



CHURCHILL
estates

Chestnut Avenue North, London, E17 3NF
£825 Per Calendar Month

Bedrooms: 1 | Reception Rooms: 1 | Bathrooms: 1



Request a Viewing: **0208 503 6060** Email: **walthamstow@wearechurchills.co.uk**

CHURCHILL
estates

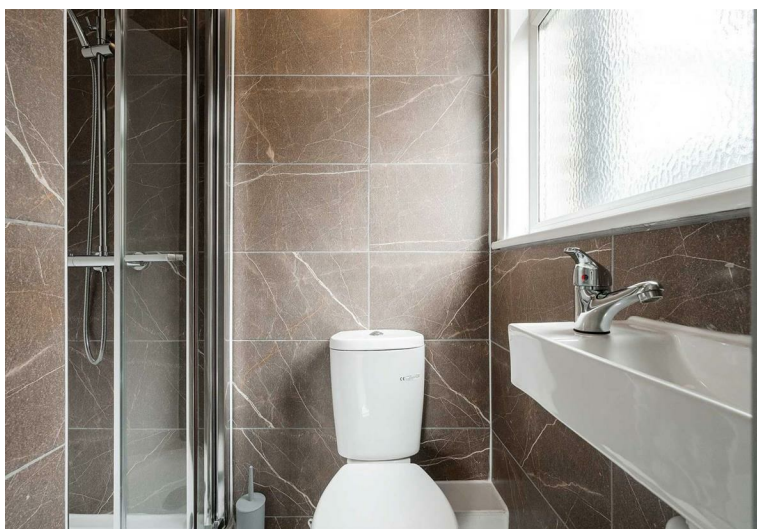
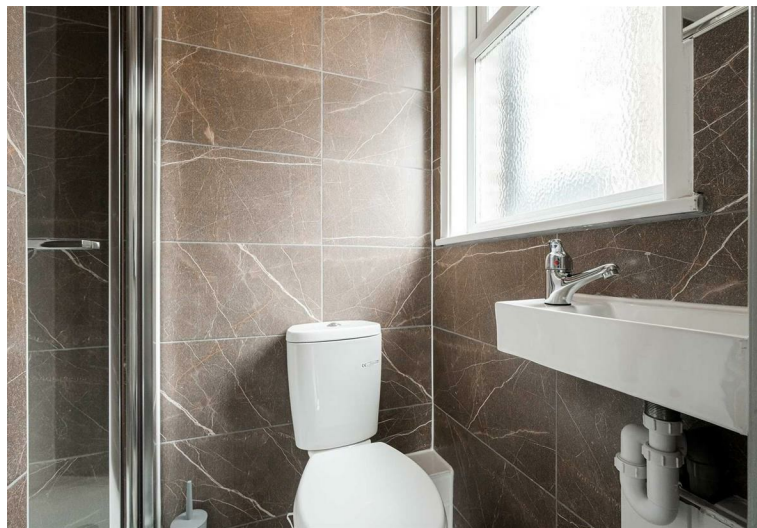

Available End of July- Fully Furnished or Unfurnished - ALL BILLS INCLUDED including WIFI (Washing Machine / Dryer Coin Operated) Churchill Estates are pleased to offer this Self-Contained Studio Apartment within a shared house. The property offers a private bathroom room and kitchenette as well as use of Communal Kitchen & Communal Garden. The property has been recently decorated throughout and offers in-built storage.

The property is well located for access to Wood Street Overground Station as well as Lloyd Park William Morris Gallery, Blackhorse Beer Mile and other local shops / restaurants.

Early Viewings Advised

