



Connells

The Oak Little Walcot Lane
Swindon



Property Description

Oakfield has something for everyone. Whether you're just starting out, need a bit of space for your growing family, want a roof terrace to relax and soak up the sun or you after some lovely outdoor space, you'll find it here!

You'll also be able to live the way you want. That could mean taking advantage of the spacious layout to create an office space and work from home. You'll feel at home and part of the community at Oakfield.

Every home in Oakfield is designed from scratch by award-winning architects and designers. This means they're not mass-produced house types that get built everywhere, they're bespoke, unique and contemporary.

Ground Floor

Kitchen / Dining Area

11' 2" x 9' 8" (3.40m x 2.95m)
High quality Scandinavian Velfac double glazed composite to the rear aspect. Double glazed door to access the enclosed rear garden. Beautifully presented fully fitted kitchen built with a range of base and wall mounted units comprising of cupboards and drawers. Ample storage. Fitted with modern appliances inclusive of Induction Hob and Integrated Fridge/Freezer unit. , Washing Machine, Dishwasher, Cooker-hood located above the hob. Tiling to all water sensitive areas.

Living Space - Open Plan

11' 2" x 10' 7" (3.40m x 3.23m)

Bedroom One

13' 8" x 12' (4.17m x 3.66m)

Shower Room



First Floor Accommodation

Bedroom Two

14' 1" x 11' 1" (4.29m x 3.38m)

Bedroom Three

9' 7" x 8' 11" (2.92m x 2.72m)

Bathroom

Bedroom One

13' 8" x 12' (4.17m x 3.66m)

High quality Scandinavian Velfac double glazed composite window to the front aspect

Shower Room

7' 3" x 7' 3" (2.21m x 2.21m)

Three piece suite comprising of walk in shower, Low Level W/C and wash hand basin. Tiling to all water sensitive areas.

Bedroom Two

14' 1" x 11' 1" (4.29m x 3.38m)

High quality Scandinavian Velfac double glazed composite window to the front aspect

Bedroom Three

9' 7" x 8' 11" (2.92m x 2.72m)

High quality Scandinavian Velfac Velux style double glazed composite window to the rear aspect

Bathroom

9' x 8' 6" (2.74m x 2.59m)

Three piece suite comprising of bath with mixer taps, Low Level W/C and wash hand basin. Tiling to all water sensitive areas.





Ground Floor

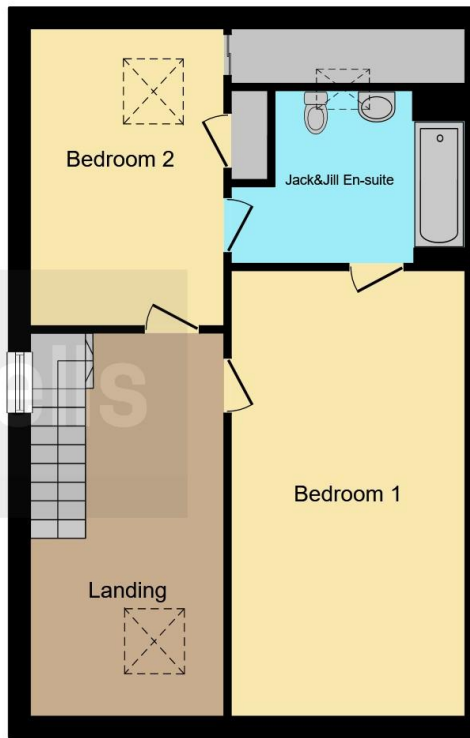

First Floor

This floor plan is for illustrative purposes only. It is not drawn to scale. Any measurements, floor areas (including any total floor area), openings and orientation are approximate. No details are guaranteed, they cannot be relied upon for any purpose and they do not form part of any agreement. No liability is taken for any error, omission or misstatement. A party must rely upon its own inspection(s). Powered by www.focalagent.com

To view this property please contact Connells on

T 01793 461757
E swindonoldtown@connells.co.uk

3-5 Victoria House, Albert St
 SWINDON SN1 3BG

EPC Rating:
 Exempt

view this property online connells.co.uk/Property/SND103286



Tenure: Freehold



1. MONEY LAUNDERING REGULATIONS Intending purchasers will be asked to produce identification documentation at a later stage and we would ask for your co-operation in order that there will be no delay in agreeing the sale. 2. These particulars do not constitute part or all of an offer or contract. 3. The measurements indicated are supplied for guidance only and as such must be considered incorrect. Potential buyers are advised to recheck measurements before committing to any expense. 4. We have not tested any apparatus, equipment, fixtures, fittings or services and it is in the buyers interest to check the working condition of any appliances.

Connells Residential is registered in England and Wales under company number 1489613, Registered Office is Cumbria House, 16-20 Hockliffe Street, Leighton Buzzard, Bedfordshire, LU7 1GN. VAT Registration Number is 500 2481 05.

See all our properties at www.connells.co.uk | www.rightmove.co.uk | www.zoopla.co.uk

Property Ref: SND103286 - 0002