



Beaufort Street
London, SW3

CHESTERTONS





This attractive two-bedroom apartment is situated within Burleigh House, a handsome period mansion block ideally positioned in SW3, close to the River Thames and the excellent amenities found along King's Road and Fulham Road.

Offering approximately 747 sq ft of well-arranged living space, the property occupies the second floor and benefits from the charm and solid construction typical of early Chelsea architecture.

The layout has been thoughtfully designed, featuring a generous reception room measuring 16'9" x 16'9", providing a central living area with ample space for both dining and relaxation. A separate, well-proportioned kitchen sits just off the reception room. The two double bedrooms are arranged at opposite ends of the apartment, creating privacy and flexibility for guests, home working, or sharers. A family bathroom completes the accommodation.

Residents of Burleigh House enjoy secure entry, well kept communal areas, and the appeal of a highly sought after Chelsea address. The nearby riverside provides attractive walking routes and green spaces, while the surrounding neighbourhood offers an excellent selection of cafés, restaurants, boutiques, galleries, and transport links.

- Prime Location
- Period Charm
- Spacious Layout
- Riverside Proximity

Offers in excess of
£600,000

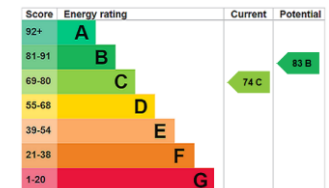

Tenure: Leasehold 81 years 6 months
Service Charge: £2607.56 per annum (paid quarterly)
Ground Rent: £10 per annum
Local Authority: Kensington and Chelsea
Council Tax Band: E

Chestertons Knightsbridge & Belgravia Sales

31 Lowndes St
 Knightsbridge
 London
 SW1X 9HX
 knightsbridge@chestertons.co.uk
 020 7235 8090

Burleigh House, SW3

Approximate gross internal area
69.40 sq m / 747 sq ft

Key :
CH - Ceiling Height

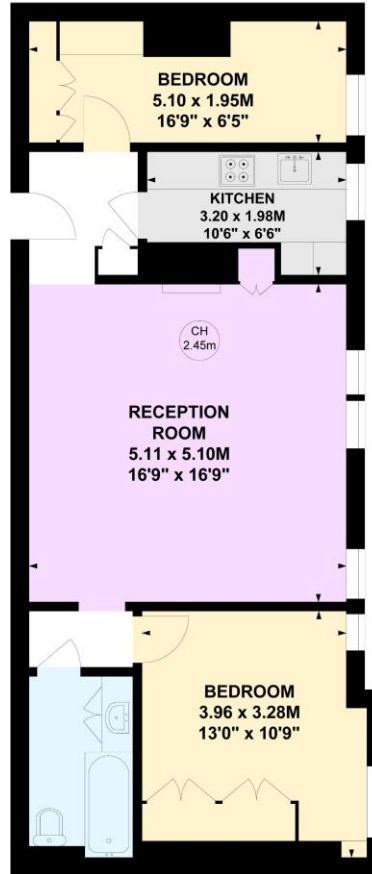

Second Floor

Not to scale, for guidance only and must not be relied upon as a statement of fact.
All measurements and areas are approximate only

Chesterton UK Services Limited trading as Chestertons for themselves and for the vendor of this property whose agents they are, give notice that (i) these particulars do not constitute any part of an offer or contract, (ii) all statements contained within these particulars are made without responsibility on the part of Chestertons or the vendor, (iii) whilst made in good faith, none of the statements contained within these particulars are to be relied upon as a statement or representation of fact, (iv) any intending purchasers must satisfy themselves by inspection or otherwise as to the correctness of each of the statements contained within these particulars, (v) the vendor does not make or give either Chestertons or any person in their employment any authority to make or give representation or warranty whatsoever in relation to this property. Wide angle lenses may be used. ©Copyright Chestertons | Chesterton UK Services Limited | Registered Office 40 Connaught Street, Hyde Park, London W2 2AB Registered Company Number 05334580.



This paper is
100% recyclable