

**14 Sandover
East Hunsbury
NORTHAMPTON
NN4 0TS**

£240,000



- NO CHAIN
- POPULAR LOCATION
- GAS CENTRAL HEATING
- OFF ROAD PARKING

- TWO BEDROOMS
- DOUBLE GLAZING
- CUL DE SAC LOCATION
- ENERGY EFFICIENCY RATING: C

To arrange a viewing call us today on 01604 639933 or visit www.horts.co.uk



PERSONAL • PROFESSIONAL • PROACTIVE

A modern two bedroom semi-detached home situated within the popular East Hunsbury development, ideally located close to a range of local amenities, schools, and excellent transport links. Offered for sale with no onward chain, this well presented property would make an ideal first time purchase, downsizing opportunity, or investment.

The accommodation comprises a welcoming entrance hall, a comfortable lounge, and a spacious kitchen/dining room with direct access to the rear garden. To the first floor are two good sized bedrooms and a modern three piece bathroom suite. Outside, the property benefits from an open plan frontage with a driveway providing parking for multiple vehicles, while the rear garden offers a private enclosed space.

Further benefits include uPVC double glazing and gas radiator heating.

Ground Floor

Entrance Hall

Providing access to the main living accommodation, with stairs rising to the first floor.

Lounge

13'4" x 10'2" max (4.08m x 3.1m max)

A bright and welcoming reception room offering a comfortable space for relaxing, with a front facing aspect.

Kitchen/Diner

13'4" x 9'2" (4.08m x 2.80)

A generous open plan style kitchen and dining area fitted with a range of wall and base units, providing ample workspace and storage. The kitchen benefits from an integrated oven and hob, tiled splashbacks, and plumbing for a washing machine. There is also useful under stair storage cupboard, space for dining furniture, and access to the rear garden.

First Floor

Landing

The first floor landing provides access to both bedrooms and the family bathroom, with a useful storage cupboard and window to the side aspect.

Bedroom One

13'4" x 9'5" (4.08m x 2.88m)

A well proportioned double bedroom featuring two windows to the front aspect. The room benefits from a built in wardrobe with sliding doors, providing useful storage space.

Bedroom Two

11'0" x 6'9" (3.37m x 2.07m)

A good sized second bedroom, ideal as a guest room, nursery, or home office.

Bathroom

6'3" x 6'3" (1.93m x 1.92m)

Fitted with a modern three piece suite comprising bath with shower over, glass shower screen, wash hand basin, and WC. The room benefits from a rear aspect window, extractor fan, and finished with practical wall tiling.

Externally

Front Garden

To the front is an open plan frontage with a driveway providing off road parking for multiple vehicles.

Rear Garden

The rear garden is fully enclosed, offering a private and low maintenance outdoor space. gated side access.

Agents Notes

West Northamptonshire Council

Council Tax Band: B





GROUND FLOOR
297 sq.ft. (27.6 sq.m.) approx.

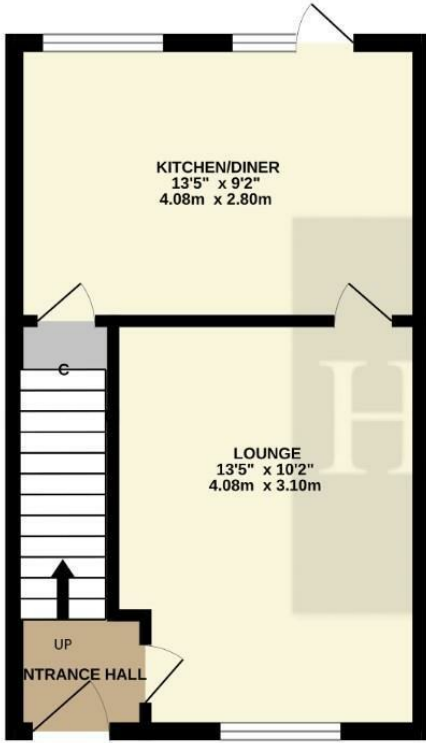

1ST FLOOR
297 sq.ft. (27.6 sq.m.) approx.

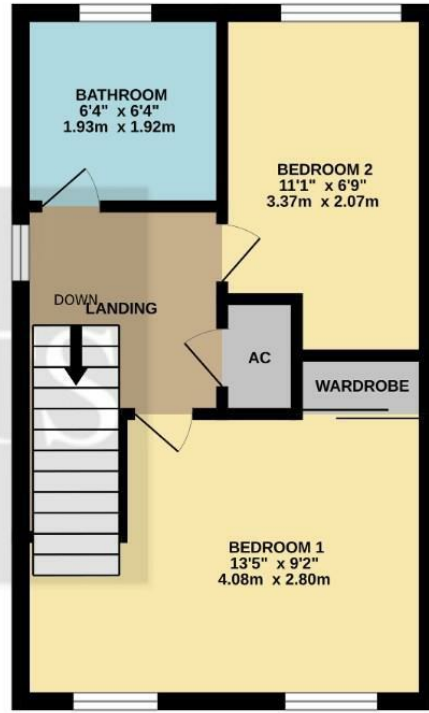

TOTAL FLOOR AREA : 594 sq.ft. (55.2 sq.m.) approx.

Whilst every attempt has been made to ensure the accuracy of the floorplan contained here, measurements of doors, windows, rooms and any other items are approximate and no responsibility is taken for any error, omission or mis-statement. This plan is for illustrative purposes only and should be used as such by any prospective purchaser. The services, systems and appliances shown have not been tested and no guarantee as to their operability or efficiency can be given.
Made with Metropix ©2026

Energy Efficiency Rating		
	Current	Potential
Very energy efficient - lower running costs		
(92 plus) A		
(81-91) B		
(69-80) C	72	78
(55-68) D		
(39-54) E		
(21-38) F		
(1-20) G		
Not energy efficient - higher running costs		
England & Wales	EU Directive 2002/91/EC	

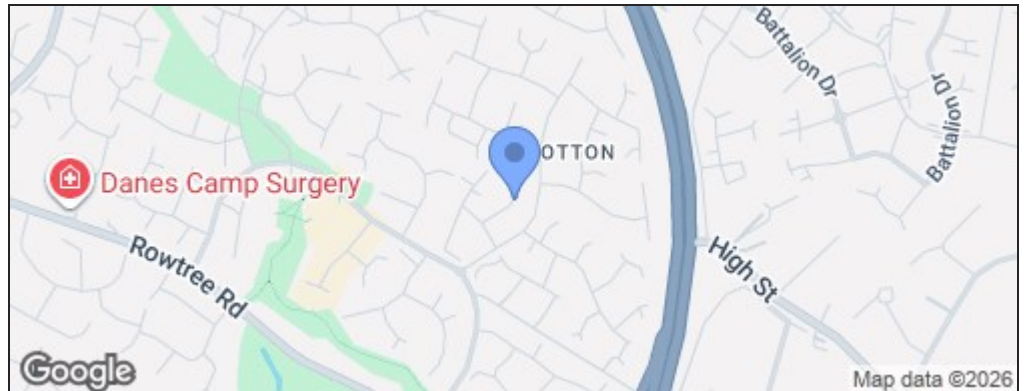

Disclaimer

These particulars, whilst believed to be accurate are set out as a general outline only for guidance and do not constitute any part of an offer or contract. Intending purchasers should not rely on them as statements or representation of fact, but must satisfy themselves by inspection or otherwise as to their accuracy. We have not carried out a detailed survey nor tested the services, appliances and specific fittings. Room sizes should not be relied upon for carpets and furnishings. The measurements given are approximate. No person in this firm's employment has the authority to make or give any representation or warranty in respect of the property.