

Jefferson Plaza, E3

£500,000

This three bedroom, two bathroom apartment is situated within the Jefferson Plaza development on the 17th floor. Features to include a fully integrated kitchen, en-suite master bedroom with under floor heating. This spacious apartment also offers a balcony with views towards Canary Wharf and the City.

Conveniently located just moments from Bromley-by-bow station with further benefits including on site Sainsburys, 24 hour concierge service and a residents-only gymnasium.

Features

Offers in excess of £500,000
Three bedrooms
Communal Roof Terrace
Secure Underground Allocated
Parking Space
24 Hour Concierge

Jefferson Plaza, London, E3

Sixteenth Floor

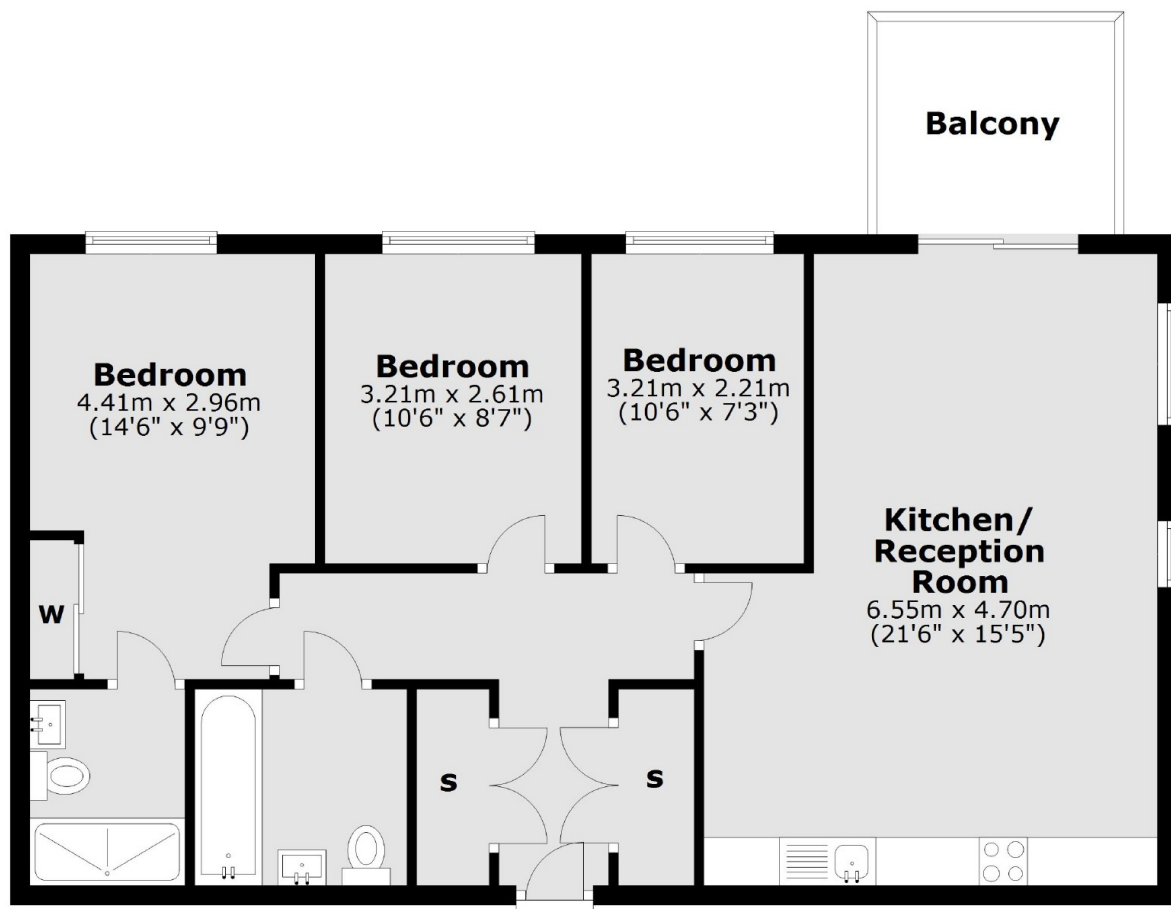

Main area: Approx. 76.6 sq. metres (824.2 sq. feet)
Plus balconies, approx. 5.7 sq. metres (61.2 sq. feet)

Contact

To arrange a viewing call our office on the number below or visit our website.



Energy Rating: B. We aim to make our particulars both accurate and reliable. However they are not guaranteed; nor do they form part of an offer or contract. If you require clarification on any points then please contact us, especially if you're traveling some distance to view. Please note that appliances and heating systems have not been tested and therefore no warranties can be given as to their good working order.