

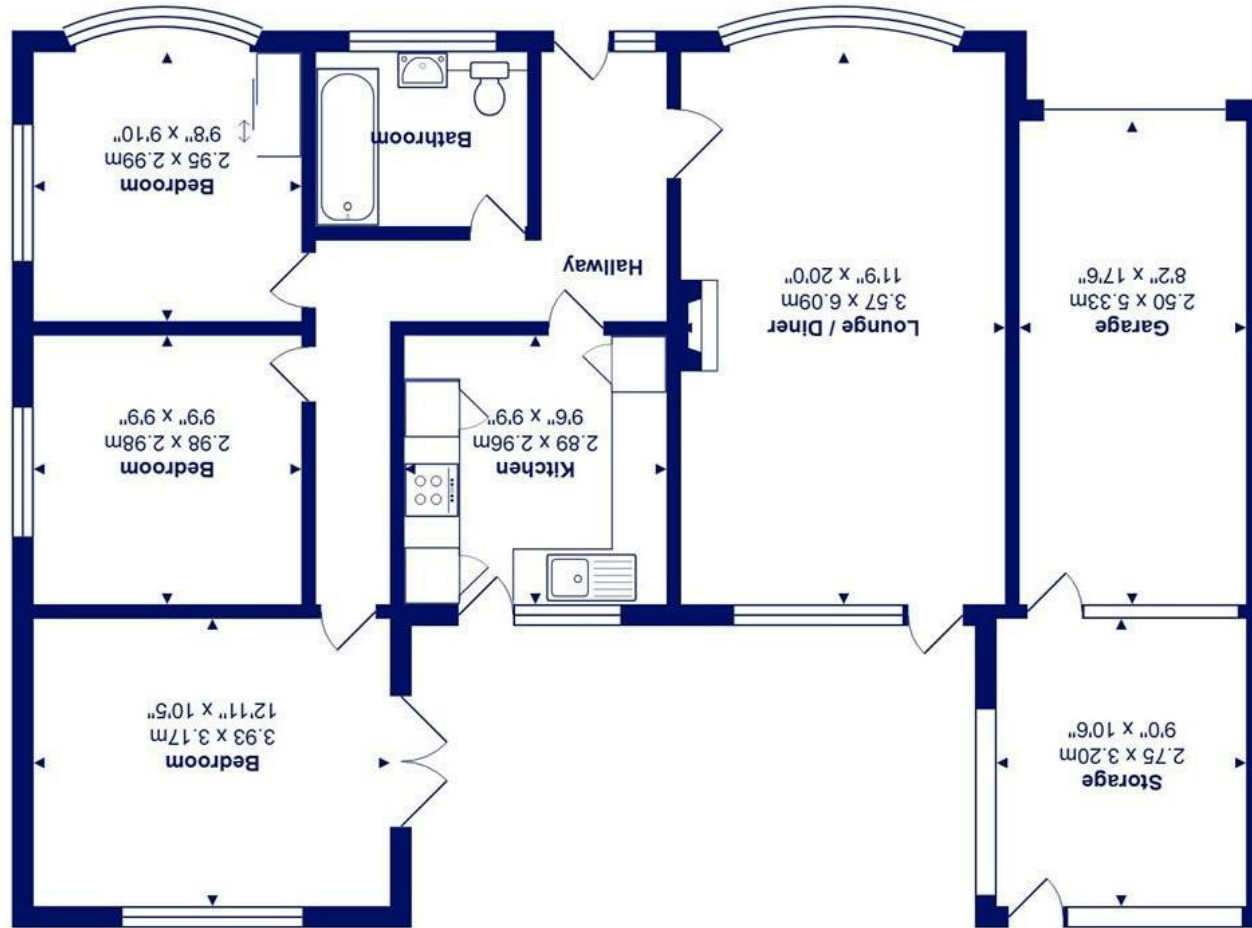

Total Area: 79.0 m² ... 850 ft² (excluding garage, storage)
All measurements are approximate and for display purposes only



22 Ricardo Crescent, Mudeford, BH23 4BX

£550,000

Mitchells
1963 — TODAY

A delightful three double bedroom detached bungalow of about 850 sq ft with scope and potential to extend and improve. Standing on a South facing plot with a sunny aspect. Situated in this lovely quiet crescent within this highly sought after pocket of Mundeford, just a short stroll from the beautiful beaches and with local shops nearby too.

- Three double bedrooms
- Dual aspect Living room
- Potential to extend (stpp)
- Useful brick storage room with potential
- Clean and tidy throughout
- Gas central heating and double glazing
- Garage and off road parking
- Great location close to the beach
- Lovely quiet Crescent

EPC Rating Band: E
Council Tax Band: D
Freehold

