



Ferrers Close, Sutton Coldfield - B75 6NG
£425,000

 **MOORHOUSE**



Ferrers Close

Sutton Coldfield

Upon entering, a welcoming hallway leads into the heart of the home. The spacious living room is bathed in natural light from a large front window and features a charming fireplace, creating a cosy focal point for relaxing evenings or family gatherings.

The fitted breakfast kitchen is a true highlight, boasting quality cabinetry, expansive worktops, and modern appliances, as well as ample space for a breakfast table - perfect for enjoying early morning coffee.

The conservatory is flooded with light and offers delightful views across the rear garden, making it an ideal spot for reading, hobbies, or simply unwinding.





Ferrers Close

Sutton Coldfield

An inner hallway provides access to two generously proportioned double bedrooms, both of which benefit from fitted wardrobes and a tranquil atmosphere that encourages restful sleep. The modern bathroom is beautifully fitted and designed with ease and accessibility in mind.

The side garage offers secure storage for vehicles, bikes, or gardening equipment, and the driveway provides additional off-road parking for multiple cars.

The rear garden is a true highlight, featuring a large patio area that is perfect for alfresco dining, summer barbeques, or simply soaking up the sun with friends and family. Beyond the patio, a well-tended lawn is bordered by mature shrubs and colourful planting, providing year-round interest and a haven for local wildlife. The garden enjoys a high degree of privacy, making it an ideal retreat for both quiet moments and lively gatherings.







FEATURES:

- Immaculately presented two bedroom bungalow
- Highly desirable cul-de-sac location
- Spacious living room and stunning conservatory
- Attractive fitted breakfast kitchen
- Two generous bedrooms both with fitted wardrobes
- Modern bathroom
- Garage and driveway
- Beautiful private rear garden

INTERESTED?

0121 308 3355

fouroaks@moorhouse-propert.co.uk



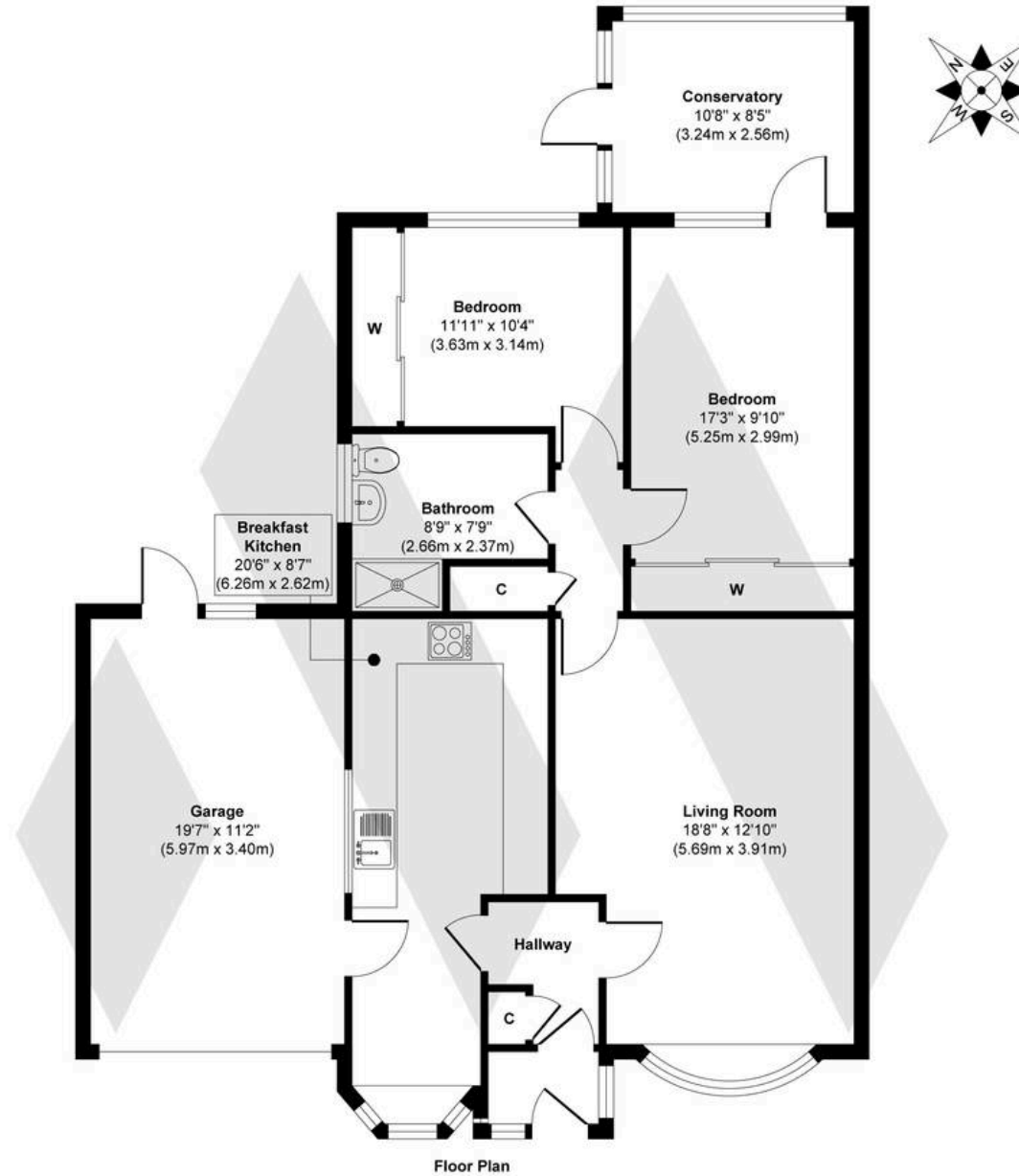

Approx. Gross Internal Floor Area 1144 sq. ft / 106.26 sq. m (Including Garage)

Illustration for identification purposes only, measurements are approximate, not to scale.

Produced by Elements Property

MOORHOUSE

