

Hazelwood Close

Harrow • • HA2 6HD
Offers In Excess Of: £350,000



coopers
est 1986

Hazelwood Close

Harrow • • HA2 6HD

Hazelwood Close is nestled on a peaceful residential road within a quiet cul-de-sac, making it an ideal choice for families, investors, and downsizers alike. Conveniently located, the property is close to excellent shopping facilities, highly regarded schools, and reliable transport links. Additional features include a well-maintained communal garden, off-street parking, and a beautifully kept interior, offering both comfort and practicality.

Two Double Bedrooms

Ground Floor Flat

One Bathroom

Living/Dining Room

Fitted Kitchen

Off-Street Parking

Communal Gardens

Close to Local Amenities and Schools

Quiet Cul De Sac Location

Approx Area: 626 sq ft

These particulars are intended as a guide and must not be relied upon as statements of fact. Your attention is drawn to the Important Notice on the last page.





GROUND FLOOR
652 sq.ft. (60.6 sq.m.) approx.

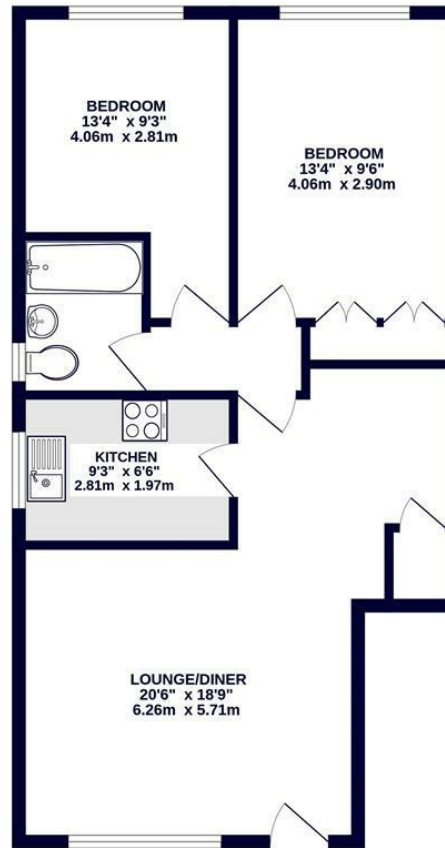

coopers
est 1986

TOTAL FLOOR AREA : 652 sq.ft. (60.6 sq.m.) approx.

Whilst every attempt has been made to ensure the accuracy of the floorplan contained here, measurements of doors, windows, rooms and any other items are approximate and no responsibility is taken for any error, omission or mis-statement. This plan is for illustrative purposes only and should be used as such by any prospective purchaser. The services, systems and appliances shown have not been tested and no guarantee as to their operability or efficiency can be given.
Made with Memopix ©2024.



coopers
est 1986

**18 Bridge Street, Pinner,
Middlesex, HA5 3JF**
pinner@coopersresidential.co.uk

CoopersResidential.co.uk

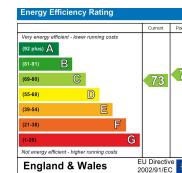

Important Notice: These particulars, whilst believed to be accurate are set out as a general outline only for guidance and do not constitute any part of an offer or contract. Intending purchasers should not rely on them as statements or representation of fact, but must satisfy themselves by inspection or otherwise has the authority to make or give any representation or warranty in respect of the property.