



**502 Nimbus Way**  
**Newmarket, CB8 7BW**  
**£320,000**



## 502 Nimbus Way, Newmarket, CB8 7BW

A superb modern and detached family home set on the edge of this established development and located on the outskirts of the town centre.

Extended and improved in recent years, this property boasts accommodation to include entrance hall, cloakroom, living room/dining room, conservatory, refitted kitchen with built in appliances, three good size double bedrooms and a refitted bathroom.

Externally the property offers a fully enclosed mainly south facing rear garden and garage en-bloc.

### Entrance Hall

With two storage cupboards, door leading to Kitchen and door to:

### Cloakroom/WC

Low level WC, hand wash basin, window to front aspect.

### Living Room 15'9" x 21'3" (4.81m x 6.48m )

Window to front and rear aspect. Stairs to first floor. Sliding patio doors leading to;

### Conservatory

French doors to rear garden.

### Kitchen 18'4" x 9'7" (5.61m x 2.93m)

Recently refitted kitchen with a range of matching eye and base level storage units with work top surfaces over. Sink and drainer with mixer tap over. Integrated eye level double oven with grill. Gas hob with extractor over. Integrated fridge freezer and washing machine. Tilled splashbacks. French doors to rear patio area. Window to rear and large skylight

### First Floor Landing

Window to front aspect. Storage cupboard and airing cupboard housing gas boiler. Doors to all bedrooms and bathroom.

### Bedroom 1 13'8" x 10'1" (4.18m x 3.09m)

Built in wardrobes. Window to rear aspect.

### Bedroom 2 8'10" x 9'10" (2.70m x 3.02m)

Built in wardrobes. Window to rear aspect.

### Bedroom 3 8'10" x 8'3" (2.70m x 2.54m)

Window to rear aspect.

### Bathroom

Three piece bathroom comprising of a L-shaped bath with shower over. Low level WC and hand wash basin. Window to front aspect.

### Outside

Enclosed front and rear gardens. The rear garden is mainly laid to lawn with patio area, flower beds and a timber storage shed. Gated access. En-Bloc single garage.

### Location

Newmarket, Suffolk, is a historic market town renowned for its horse racing heritage, being home to the famous Newmarket Racecourse. The town offers a blend of amenities, including shops, restaurants, and cafes, community theatre/cinema, as well as parks and recreational

facilities. Key attractions include the National Horseracing Museum and various race-related events. In terms of distance to other cities, Newmarket is approximately 15 miles northeast of Cambridge, about 15 miles from Bury St Edmunds, and roughly 40 miles from Ipswich. Newmarket train station offers an hourly service in to Cambridge City in 25 minutes, with onwards links in to London, making it accessible for commuters and visitors alike.

### Property Information

EPC - C

Tenure - Freehold

Council Tax Band - C - West Suffolk

Property - Detached House

Property Construction – Standard

Number & Types of Room – Please

refer to the floorplan

Square Meters - 94 SQM

Parking – Driveway

Electric Supply - Mains

Water Supply – Mains

Sewerage - Mains

Heating sources - Gas

Broadband Connected - TBC

Broadband Type – Ultrafast available, 1000Mbps download, 100Mbps upload

Mobile Signal/Coverage – Ofcom

advise good on all networks

Rights of Way, Easements, Covenants

– None that the vendor is aware of



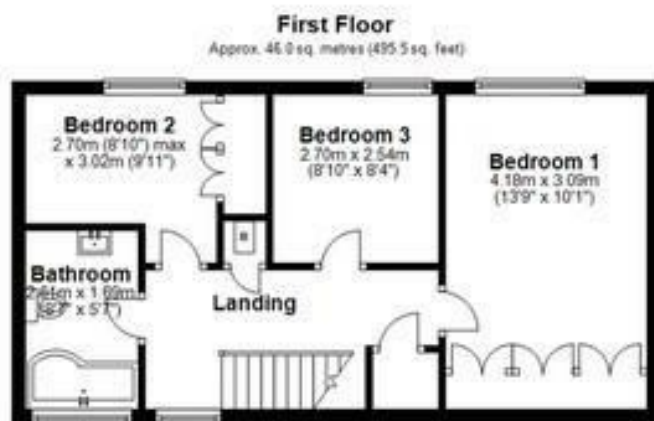

**Total area: approx. 112.6 sq. metres (1211.8 sq. feet)**

Whilst every attempt has been made to ensure the accuracy of the Floorplan contained here, measurements of doors, windows, rooms and any other items are approximate and no responsibility is taken for any error, omission or mis-statement. This plan is for illustrative purposes only and should be used as such by any prospective purchaser. The services, systems and appliances shown have not been tested and no guarantee as to their operability or can be given. Copyright Clarke Phillips Ltd 2021.  
Plan produced using PlanUp.

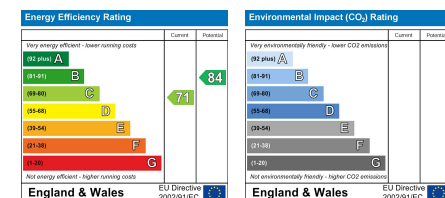
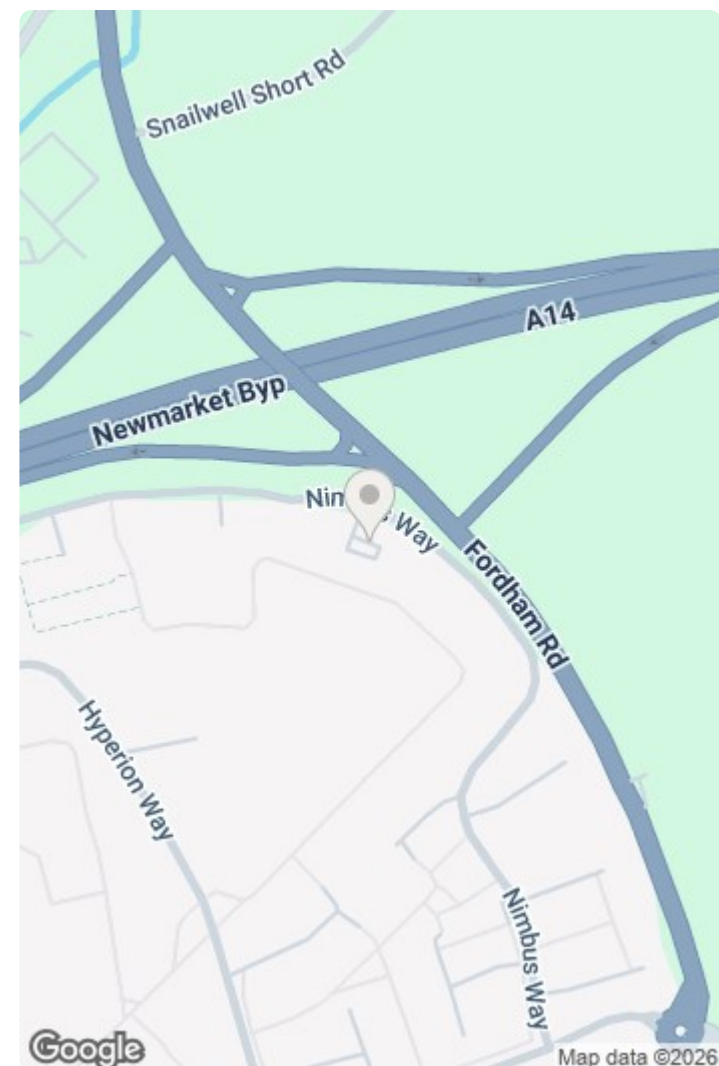

This document and any marketing relating to the property has been prepared in good faith to give a fair overall view of the property and must not be relied upon as statements or representations of fact. It is suggested that undertake enquiries by inspections, survey or other investigation to ascertain the viability of any purchase. Any areas, measurements or distances referred to are given as a guide only and are not precise and no liability can be accepted for errors arising them therefrom. Photographs are not necessarily comprehensive nor current; no assumption should be made that any contents shown are included in the sale. Morris Armitage have not tested any services or equipment and nothing in these particulars should be deemed to be a statement that they are in good working order nor that the property is in good structural condition.



