



Neal Close, Plymouth PL7 1YY

welcome to

Neal Close, Plymouth

Well-presented two-bedroom terraced home situated in the popular Neal Close area of Plympton. The property benefits from a modern fitted kitchen, driveway parking and a private rear garden, making it an ideal choice for first-time buyers, downsizers or investors.



Entrance Porch

Door access into the lounge. Coat hooks to left hand side wall.

Lounge

Gas fire, double glazing to the front elevation, radiator, stairs to first floor landing, door access to the kitchen.

Kitchen

Double glazing to the rear with door access to the garden, breakfast bar, space for fridge/freezer and appliances, integrated cooker, hob, fan and hood. Ample cupboard space.

First Floor Landing

Door access to bedroom 1,2, bathroom and loft hatch and a radiator.

Bedroom 1

Double glazing to the front elevation, radiator and fitted wardrobe.

Bedroom 2

Radiator and double glazing to the rear.

Bathroom

Vanity sink, wc, radiator, shower and electric body dryer.

Rear Garden

Patio, laid lawn and decking.

Driveway

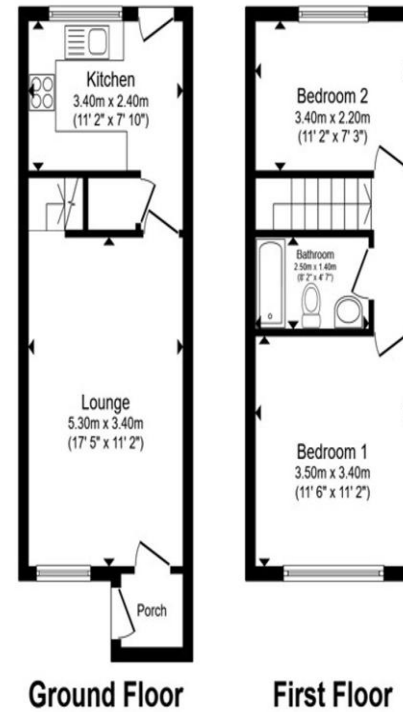

Total floor area 57.9 m² (624 sq.ft.) approx

This floor plan is for illustrative purposes only. It is not drawn to scale. Any measurements, floor areas (including any total floor area), openings and orientation are approximate. No details are guaranteed, they cannot be relied upon for any purpose and they do not form part of any agreement. No liability is taken for any error, omission or misstatement. A party must rely upon its own inspection(s). Powered by www.propertybox.io

fox & sons



view this property online fox-and-sons.co.uk/Property/PYP104671



welcome to

Neal Close, Plymouth

- Well-presented throughout
- Modern fitted kitchen
- Two-bedroom terraced home
- Bright and comfortable living space
- Enclosed rear garden

Tenure: Freehold EPC Rating: C
Council Tax Band: B

guide price

£200,000



Please note the marker reflects the
postcode not the actual property

view this property online fox-and-sons.co.uk/Property/PYP104671



Property Ref:
PYP104671 - 0003

1. MONEY LAUNDERING REGULATIONS Intending purchasers will be asked to produce identification documentation at a later stage and we would ask for your co-operation in order that there is no delay in agreeing the sale. 2. These particulars do not constitute part or all of an offer or contract. 3. The measurements indicated are supplied for guidance only and as such must be considered incorrect. Potential buyers are advised to recheck measurements before committing to any expense. 4. We have not tested any apparatus, equipment, fixtures or services and it is in the buyers interest to check the working condition of any appliances. 5. Where an EPC, or a Home Report (Scotland only) is held for this property, it is available for inspection at the branch by appointment. If you require a printed version of a Home Report, you will need to pay a reasonable production charge reflecting printing and other costs. 6. We are not able to offer an opinion either written or verbal on the content of these reports and this must be obtained from your legal representative. 7. Whilst we take care in preparing these reports, a buyer should ensure that his/her legal representative confirms as soon as possible all matters relating to title including the extent and boundaries of the property and other important matters before exchange of contracts.

fox & sons



01752 344349



plympton@fox-and-sons.co.uk



143 Ridgeway, Plympton, PLYMOUTH, Devon,
PL7 2HJ



fox-and-sons.co.uk