



## Elthorne Avenue, W7

£475,000

A beautifully presented ground floor garden flat with over 600 sq ft of well-proportioned space.

The property offers two double bedrooms, family bathrooms, a bright reception room, and a private garden.

Located in a sought-after area, it is offered with no onward chain and a share of freehold.



Ideally located for an abundance of local amenities including Elthorne park which is only a short stroll away which provides an amazing family amenity. Ofsted outstanding schools locally including Oaklands and Elthorne High. Excellent transport links including the Elizabeth Line at Hanwell station, Piccadilly at Boston Manor station and many varied and frequent bus routes along Boston Manor road.

- No Onward Chain • Ground Floor Flat • Private Garden •
- Ofsted Outstanding Schools • Share Of Freehold • Elizabeth Line (Hanwell) •



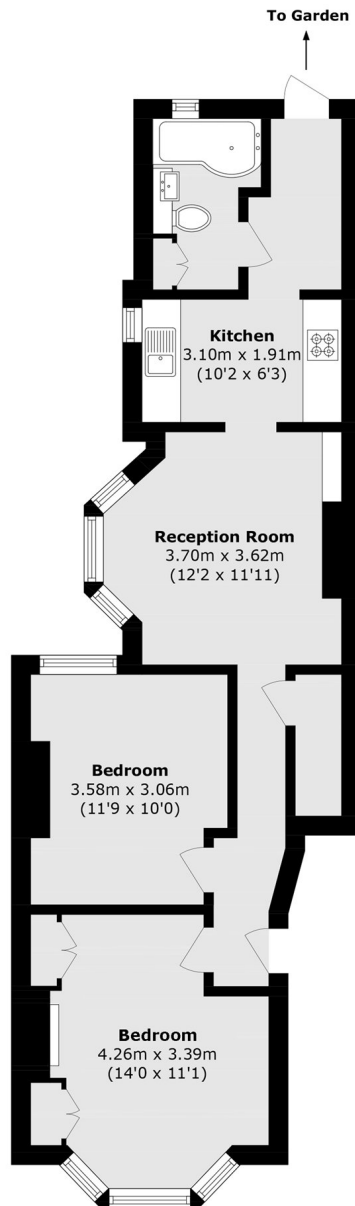

Total area (approx.): 58.1 sq. m (625.3 sq. ft)

Robertson Smith & Kempson Northfields Sales  
116 Northfield Avenue,  
London, W13 9RT  
020 8566 2340  
[northfieldssales@robertsonsmithandkempson.co.uk](mailto:northfieldssales@robertsonsmithandkempson.co.uk)

Energy Rating: C. We aim to make our particulars both accurate and reliable. However they are not guaranteed; nor do they form part of an offer or contract. If you require clarification on any points then please contact us, especially if you're traveling some distance to view. Please note that appliances and heating systems have not been tested and therefore no warranties can be given as to their good working order.