

Guide Price

**£400,000 - £410,000**

The Cottage , Bevis Lane, Wisbech St Mary, PE13 4TY



**To arrange a viewing call us now on 01354 701000**

Offered in immaculate order and set in a desirable semi-rural location with approximately 2 acres (sts), this charming cottage has much to boast about, including two reception rooms, a refitted kitchen with appliances, ground floor WC, three bedrooms, and a four-piece first-floor bathroom. Outside, there is ample parking via two driveways, an oversized garage, a fully equipped studio, and a summerhouse overlooking the generous gardens and grounds. EPC Rating: E.

ellis winters 52 High Street, March, Cambridgeshire, PE15 9JR  
Tel: 01354 701000 Email: [info@elliswinters.co.uk](mailto:info@elliswinters.co.uk) [www.elliswinters.co.uk](http://www.elliswinters.co.uk)

**ellis winters**  
sales & lettings since 2001



**ellis winters**  
sales & lettings since 2001

Guide Price

£400,000 - £410,000

The Cottage , Bevis Lane, Wisbech St Mary, PE13 4TY



Offered in immaculate order and set in a desirable semi-rural location with approximately 2 acres (sts), this charming cottage has much to boast about, including two reception rooms, a refitted kitchen with appliances, ground floor WC, three bedrooms, and a four-piece first-floor bathroom. Outside, there is ample parking via two driveways, an oversized garage, a fully equipped studio, and a summerhouse overlooking the generous gardens and grounds. EPC Rating: E.

#### Ground Floor

**Dining Room**  
4.74m (15'7") x 3.30m (10'10")  
Window to front, two windows to side, radiator, stairs to first floor and landing.

**Lounge**  
5.63m (18'6") x 3.58m (11'9")  
Window to front, two radiators, patio doors to garden, ornamental fire surround.

**Kitchen**  
4.62m (15'2") x 2.16m (7'1")  
Refitted with wall and base units with integral double oven, hob, hood, microwave, plumbing for washing machine, boiler, sink unit with mixer tap, two windows to rear, radiator.

**WC**  
Fitted with vanity wash hand basin and WC, window to side.

#### First Floor & Landing

Window to rear, radiator, access to loft which is part boarded.

**Bedroom 1**  
3.82m (12'6") x 3.40m (11'2")  
Window to front, radiator.

**Bedroom 2**  
3.60m (11'10") x 3.40m (11'2")  
Window to side, radiator.

**Bedroom 3**  
3.60m (11'10") x 2.11m (6'11")  
Window to front, radiator.

#### Family Bathroom

Refitted and fully tiled. Fitted with a four piece suite comprising bath, separate shower cubicle, vanity wash hand basin, WC, window to side and rear, radiator.

#### Outside

A gravel driveway to the front of the property provides off road parking leading to a gated area with further parking. The South east facing garden is laid to a raised patio area that extends to the side and rear. A step leads down to further garden which is laid mainly to lawn leading to the summerhouse with light and power, studio 6m x 3.6m, fitted with light and power with electric heater and patio doors to the garden. Behind the studio there is a second driveway accessed via double gates leading to the oversized garage which is fitted with light and power. Beyond the main garden lies an additional approximately two acres of land (STS), which is registered as agricultural land.

Freehold  
Council tax band B

The property has LPG central heating and private drainage. The home boasts a semi rural location with field views and easy access to both March, Wisbech and Peterborough.

#### Buyer ID Checks

To meet legal requirements, we must verify the identity of all buyers. Our partner, Simplify, will handle this process and will contact you directly once your offer is accepted, subject to contract, to collect the necessary details and payment. The cost is £66.67 plus VAT per transaction (£80 inc VAT), payable upon offer acceptance. A memorandum of sale can only be issued once these checks are complete.

Our team will guide you through the process when you make an offer on a property.

#### Disclaimer

All property details, photographs, floorplans, and other marketing materials produced by Ellis Winters are for general guidance only and do not form part of any contract. While we strive for accuracy, measurements, descriptions, and other information are provided in good faith but should be independently verified. We recommend that prospective buyers conduct their own due diligence before making any decisions.

Ellis Winters also provides professional Lettings, Property Management, Estate Management and Block Management services. Whether you are considering renting your property to support your next move, exploring buy-to-let opportunities, seeking a review of your existing portfolio, or looking for expert management support, our experienced team is on hand to assist. Please contact us using the details above to discuss your requirements.

**Ground Floor**  
Approx. 49.0 sq. metres (527.4 sq. feet)

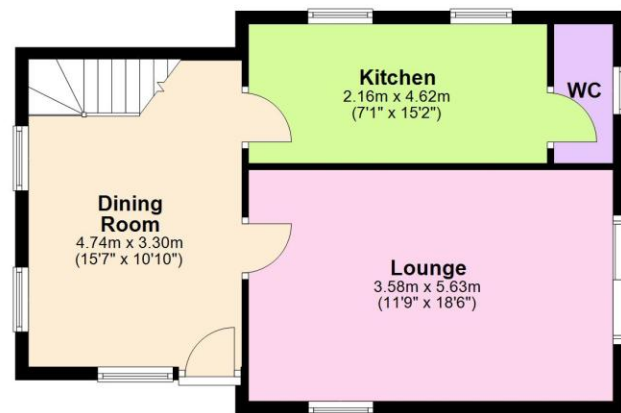

**First Floor**  
Approx. 49.4 sq. metres (531.4 sq. feet)

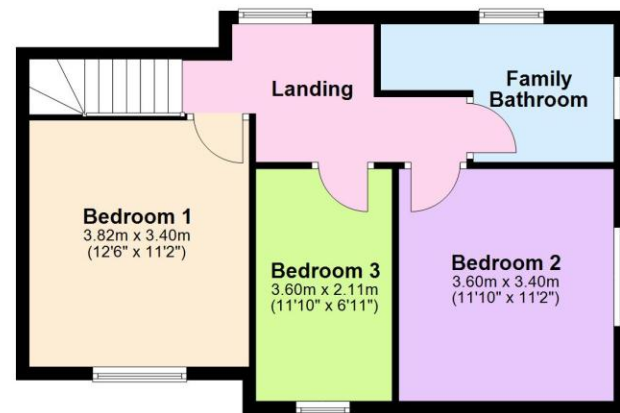

Total area: approx. 98.4 sq. metres (1058.8 sq. feet)

**ellis winters**  
sales & lettings since 2001