



27 Barley Street

Padiham, Burnley

Council Tax band: A

Tenure: Leasehold

EPC Energy Efficiency Rating: F

EPC Environmental Impact Rating: F

- Three Double Bedrooms
- Two Reception Rooms
- Large Kitchen
- Log Burner
- Council Tax Band A - Leasehold Tenure
- Popular Location
- Well Presented



Ground Floor

Step inside and you are welcomed by a bright entrance hall that sets the tone for the rest of the home. To the front, the dining room enjoys a pleasant outlook and offers a lovely setting for everyday meals or hosting friends and family. Moving through, the living room sits at the heart of the home. This is a comfortable and inviting space, centred around a charming multi fuel burner that creates a warm and cosy atmosphere, especially during the cooler months. To the rear, the kitchen is a real highlight. Larger than typically found in this style of property, it provides an excellent amount of workspace and storage, with plenty of room for modern appliances. It is a practical and sociable space that naturally lends itself to busy family life.

First Floor

Upstairs, the property continues to impress with three well-proportioned double bedrooms. Each room offers comfortable accommodation, with flexibility for family living, guests, or working from home. The bathroom is centrally located and fitted with a bath, wash basin and WC, serving all bedrooms conveniently.

External

To the rear, there is a private enclosed yard that has been thoughtfully arranged to create a low maintenance outdoor seating area. With space for outdoor furniture and decorative planting, it offers a pleasant spot to relax and enjoy some fresh air. As an end of terrace property, there is also a greater sense of space and openness to the side, adding to the overall appeal.





FARDELLA
& BELL



FARDELLA
& BELL



FARDELLA
& BELL



FARDELLA
& BELL

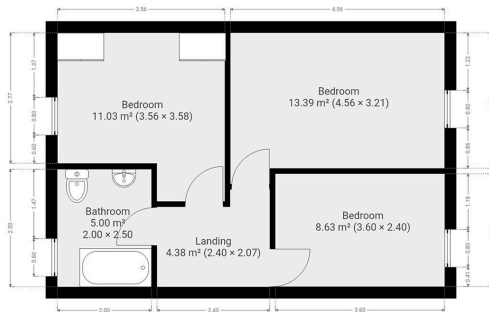
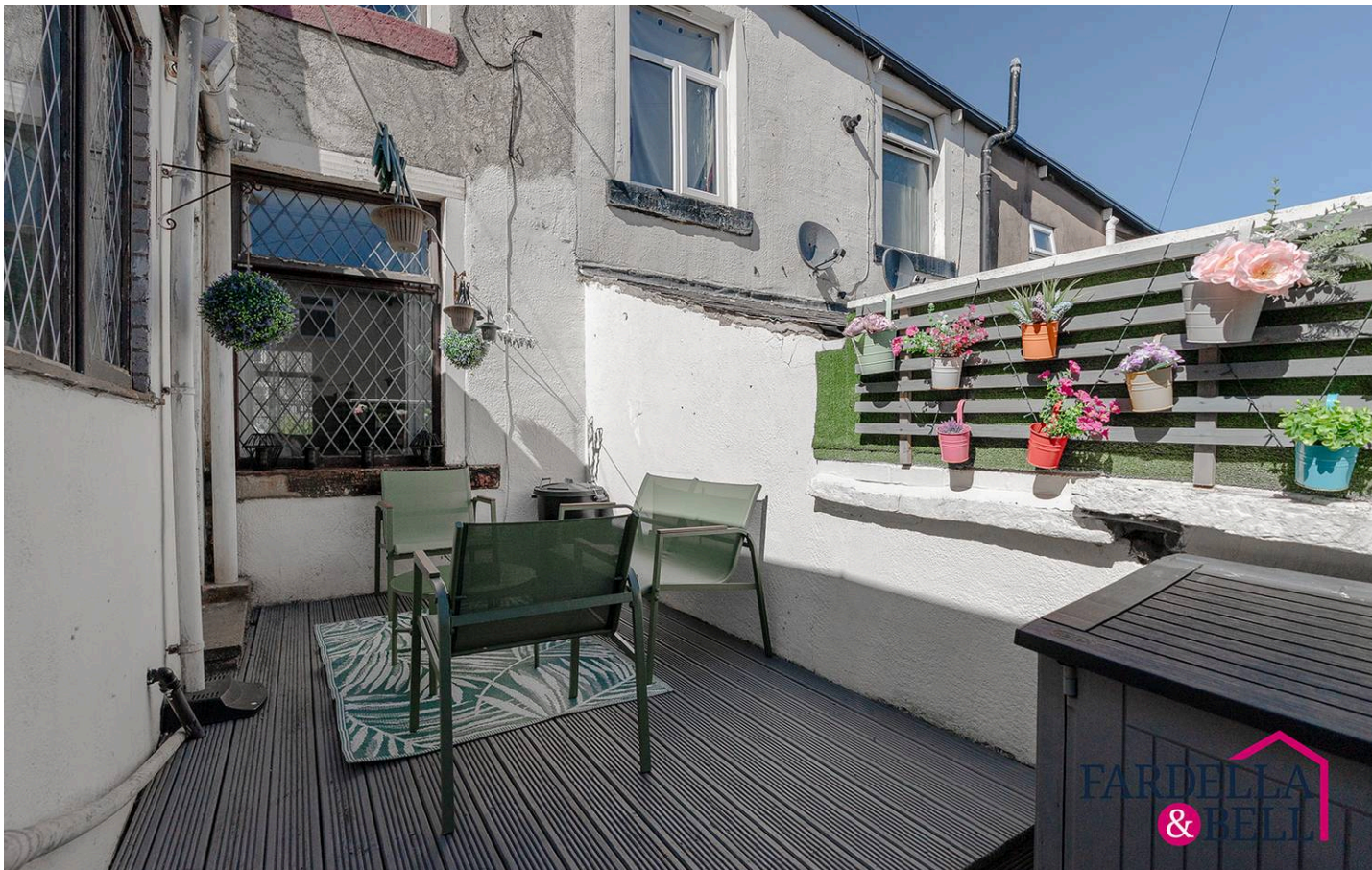

Total Property Area: approx - 101.74 Sq Meters (1,095.12 Sq Feet)

This floor plan is for illustrative purposes only. It is not to scale. Any measurements, floor areas including any built floor areas, openings and orientations are approximate. No liability is taken for any errors and they do not form part of any agreement. No liability is taken for any errors.



Total Property Area: approx - 101.74 Sq Meters (1,095.12 Sq Feet)

This floor plan is for illustrative purposes only. It is not to scale. Any measurements, floor areas including any built floor areas, openings and orientations are approximate. No liability is taken for any errors and they do not form part of any agreement. No liability is taken for any errors.



BRITISH
PROPERTY
AWARDS

2025
★★★★★

GOLD WINNER

ESTATE AGENT
IN BURNLEY



BRITISH
PROPERTY
AWARDS

2025
★★★★★

GOLD WINNER

ESTATE AGENT
IN NORTH WEST
(CUMBRIA & LANCASHIRE)

**FARDELLA
& BELL**

Fardella & Bell Estate Agents

143 Burnley Road,, Padiham - BB12 8BA

01282 968 668 • info@fbestateagents.co.uk • fbestateagents.co.uk/

