



## De Beauvoir Crescent, N1

### £485,000

A spacious one bedroom property set on the first floor of the much sought after Grand Canal Apartments. This flat benefits from open plan kitchen & living room, modern appliances, underfloor heating with hardwood floors and a large private terrace.

Located in De Beauvoir town with Haggerston Station 0.3 miles away, several bus routes on Kingsland Road & Southgate Road this property is within easy reach of the City. The green spaces of Shoreditch Park, De Beauvoir Square and Rosemary Gardens are also within easy reach.

### Features

Open Plan Living  
Private Terrace  
Modern  
Wooden Floors  
Under Floor Heating

# De Beauvoir Crescent, London, N1

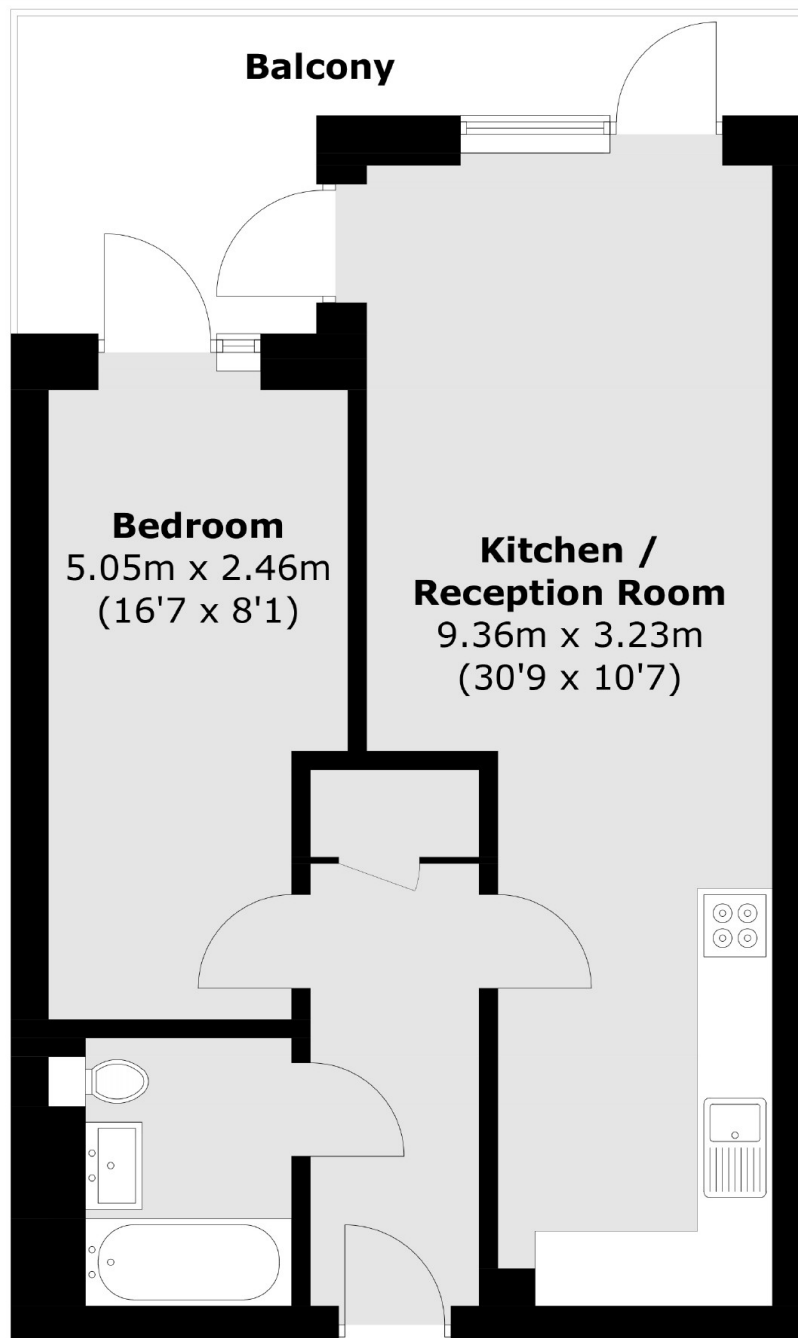

Total area (approx.): 49.5 sq. m (532.8 sq. ft)  
Balcony: 9.2 sq. m (99 sq. ft)

## Dexters

Islington  
76 Upper Street  
London  
N1 0NU  
Sales  
020 7483 6373

Energy Rating: B. We aim to make our particulars both accurate and reliable. However they are not guaranteed; nor do they form part of an offer or contract. If you require clarification on any points then please contact us, especially if you're traveling some distance to view. Please note that appliances and heating systems have not been tested and therefore no warranties can be given as to their good working order.

 **RICS** | Regulated  
Estate Agent  
and Letting Agent

[dexters.co.uk](https://www.dexters.co.uk)