



RIVA LILY.
POWERED BY
exp UK

hello@rivalily.co.uk | 0116 298 3911
rivalily.co.uk

86 Dorothy Avenue,
£239,000

3 1 2



- Three Bedrooms
- Extended Ground Floor
- Driveway
- Close to local town centre
- Solar Panels
- Large Garden
- Garden Room
- Downstair WC



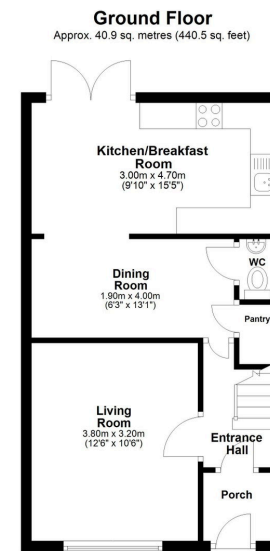

Total area: approx. 77.4 sq. metres (833.1 sq. feet)

An immaculate and extended Three-Bedroom Semi-Detached home in Melton Mowbray, offering spacious and versatile living throughout. The ground floor features an Entrance Porch, Hallway, Lounge, Dining Room, Downstairs WC, Pantry and steps leading to a superb rear extension with an open-plan Kitchen area. Upstairs are Two Double Bedrooms, One Single Bedroom, and a modern Shower room. Externally, the property boasts a large, beautifully maintained rear garden with patio, decking, a generous lawn and an impressive bar room converted from one half of the garage, with the remaining half providing useful storage. To the front, a block-paved driveway accommodates several vehicles, and the home also benefits from solar panels.

