



THORPE & CO.
ESTATE AGENTS

Ladywell Point, Pilgrims Way, Salford, M50 1AW

£1,050 Per month



Ladywell Point is situated next to Ladywell Metro Station providing direct transport links to MediaCity, Manchester city centre and the wider Greater Manchester area. Bus and train stations are just a short walk away in Eccles town centre and access to the northwest motorway network is provided via the Eccles Junction of the M602 - transport links really couldn't be better!

Newly redecorated, this fantastic apartment provides spacious accommodation including entrance hall, large open plan lounge/kitchen, 2 double bedrooms, master en-suite and bathroom. The development is gated and there is an allocated parking space.

The property is offered To Let on a part furnished basis and is available immediately. The rent will be payable monthly in advance and is exclusive of council tax and all other utilities. A security deposit of 5 weeks rent will be payable.

EPC D- Right to Rent in the UK checks will be completed via our referencing agency, before a tenancy can be granted. All tenants over the age of 18 must provide original relevant identification documents at the point of submitting an application to rent.

- 1st floor Apartment
- Part furnished
- Gated development
- 2 double bedroom
- Lift access
- Excellent transport links
- Master en-suite
- Allocated parking
- Ladywell Metro station 2 min walk
- Close to Salford Royal Hospital

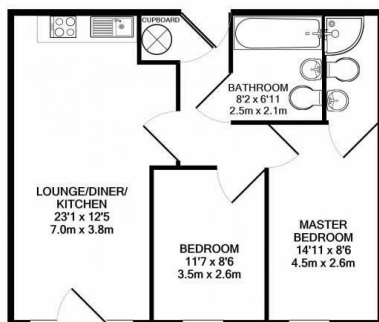

TOTAL APPROX. FLOOR AREA 633 SQ.FT. (58.8 SQ.M.)
Whilst every attempt has been made to ensure the accuracy of the floor plan contained here, measurements of doors, windows, rooms and any other items are approximate and no responsibility is taken for any error, omission, or mis-statement. This plan is for illustrative purposes only and should be used as such by any prospective purchaser. The services, systems and appliances shown have not been tested and no guarantee as to their operability or efficiency can be given.



THORPE & Co.
ESTATE AGENTS

Telephone: 01617367300 Email: enquiries@thorpeandcoliving.co.uk