



60. Vaagen Road



60. Vaagen Road Canvey Island Essex SS8 9DP

Guide Price £440,000



Spacious Family Home – Cul-de-Sac Position – No Onward Chain

Set at the end of a cul-de-sac, just up the road from the local school and around the corner from Canvey town centre, this generously proportioned family home offers plenty of living space and occupies a wide plot with a pleasant rear garden.

Offered with no onward chain, the property provides an excellent opportunity for a growing family and for buyers looking to personalise a home over time.

The ground floor features a large lounge, separate dining room, and a bright conservatory overlooking the garden, creating a great layout for both everyday living and entertaining. There is also a versatile additional room on the ground floor, ideal as a study, guest room or playroom, together with a cloakroom.

Upstairs the property offers four good size double bedrooms and a family bathroom, providing comfortable accommodation for the whole household.

Homes offering this amount of space and such a convenient location rarely remain available for long.



Front

The property benefits from a driveway providing off street parking leading to an integral garage. The front garden is mainly laid to lawn with shrub borders and enclosed by a low brick wall, with a covered porch area giving access to the front entrance.

Cloakroom

Comprising a low level WC and pedestal wash hand basin with tiled splashback. Radiator, patterned vinyl flooring and obscure double glazed window to the side providing natural light and ventilation

Hall

Spacious entrance hallway with double glazed front door with decorative glass panels, patterned vinyl flooring, radiator and stairs leading to the first floor with useful understairs storage cupboard. Doors leading to the main living accommodation

Kitchen

9'3 x 7'7 (2.82m x 2.31m)

Fitted with a range of wall and base units with work surfaces incorporating a stainless steel sink unit with mixer tap and drainer. Space and plumbing for washing machine and further appliance, space for cooker with extractor hood above. Tiled splashbacks and double glazed window to the side elevation providing natural light. Patterned vinyl flooring and door leading to the hallway.

Lounge

20'11 x 13'5 (6.38m x 4.09m)

A spacious and bright reception room featuring a large double glazed window to the front elevation, radiator and fitted carpet. Attractive feature fireplace with decorative surround, wall light points and archway leading through to the dining room. Patio doors giving access to the conservatory.

Dining room

17'1 x 10'1 (5.21m x 3.07m)

A good size dining area featuring a large floor to ceiling double glazed window

overlooking the rear garden and patio doors providing direct access to the garden. Radiator, fitted carpet, feature fireplace with decorative surround and door leading to the kitchen. Built-in storage cupboard housing the boiler.

Study / bedroom

6'10 x 6'8 (2.08m x 2.03m)

A versatile room suitable for use as a study or occasional bedroom, with fitted flooring and radiator. Doors providing access to the garage and conservatory

Conservatory

12'10 x 11'4 (3.91m x 3.45m)

A bright and spacious conservatory with double glazed windows and polycarbonate roof, providing attractive views over the rear garden. Double glazed doors leading to the garden, tiled flooring and ample space for seating or dining, making it an ideal additional reception area.

Landing

Bright and spacious landing with window to the side providing natural light, fitted carpet, radiator and balustrade staircase leading to the ground floor. Doors lead to bedrooms and bathroom.

Bedroom One

10 x 9'10 (3.05m x 2.77m)

A bright double bedroom featuring a large double glazed window to the side elevation and a circular porthole-style window to the front, allowing plenty of natural light.

Fitted carpet, radiator and a range of built-in wardrobes, cupboards and drawer units providing excellent storage space.

Bedroom Two

11'4 x 10'11 (3.45m x 3.33m)

Double Glazed window and Radiator

Bedroom Three

11'4 x 9 (3.45m x 2.74m)

Double Glazed window and Radiator

Bedroom Four

8'9 x 8'7 (2.67m x 2.62m)

Double Glazed window and Radiator

Bathroom

Comprising a panelled bath with mixer tap and shower attachment, pedestal wash hand basin and low level WC. Part tiled walls, radiator and obscure double glazed window to the side providing natural light and ventilation. Finished with a contrasting black and white tiled floor.

Garden

A pleasant and well-maintained rear garden, mainly laid to lawn with attractive shrub and flower borders. The garden features a paved patio area immediately to the rear of the property providing an ideal space for outdoor seating and entertaining, with the remainder laid to lawn and complemented by decorative features and mature planting. The garden is enclosed by fencing offering a good degree of privacy and includes a side access gate leading to the front of the property.

Garage

19'8 x 6'10 (5.99m x 2.08m)

Up and over door and door into the study / bedroom



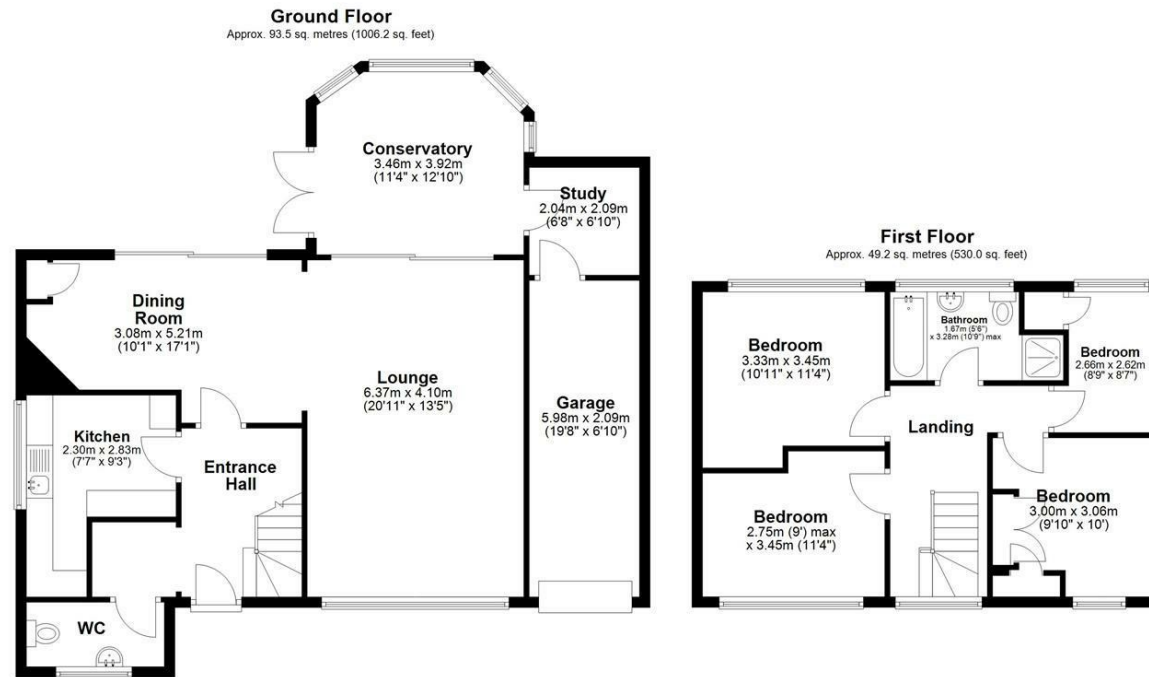

Total area: approx. 142.7 sq. metres (1536.2 sq. feet)

This floor plan has been created by a third party and should be used as a general outline for guidance only. Any areas, measurements or distances quoted are approximate and any intending purchaser or lessee should satisfy themselves by inspection, searches, enquiries and/or full survey as to the correctness of each statement. We accept no responsibility or liability for any loss whatsoever that may arise as a result of this plan and the information contained within.

© @modephoto.uk | www.modephoto.co.uk
Plan produced using PlanUp.

Vaagen Road

Misrepresentation Act 1967: These details are prepared as a general guide only, and should not be relied upon as a basis to enter a legal contract or commit expenditure. And any interested party should rely solely on their own Surveyor, Solicitor/Conveyancer or other professionals before committing themselves to any expenditure or other legal commitments. If any interested party wishes to rely upon any information from the Agent, then a request should be made and specific written confirmation can be provided. The Agent will not be responsible for any verbal statement made by the Agent or any member of Staff, as only a specific written confirmation can be provided. The Agent will not be responsible for any loss other than what specific written confirmation has been requested.

Property Misdescription Act 1991 The Agent has not tested any apparatus, equipment, fixture, fittings or services and so does not verify they are in working order, fit for purpose, or within ownership of the sellers, therefore the buyer must assume the information is incorrect. Neither has the Agent checked the legal documentation to verify legal status of the property. A buyer must assume the information is incorrect until it has been verified by their own Solicitors/Conveyancers. Nothing concerning the type of construction or the condition of the structure is to be implied from the photograph or plans for the property. Photographs of the interior of the property are given purely to give an indication of décor/style etc. and does not imply that any furniture/fittings etc., are included. A fixtures & fittings list will be provided by the Solicitors/Conveyancers in due course. The sales particulars may change in the course of time and any interested party is advised to make a final inspection of the property prior to exchange of contracts



Tel No: 01268 699 599 | Fax: 01268 699 080 | Email: rp@richardpoyntz.com
Registered Office: Richard Poyntz & Company, 11 Knightswick Road, Canvey Island SS8 9PA

Partners: Richard P. Poyntz F.N.A.E.A., James R. Poyntz M.N.A.E.A., Anna L. Poyntz & Sara Poyntz • V.A.T No: 731 4287 45
Richard Poyntz & Co (Partnership) is an introducer appointed representative of Stonebridge Mortgage Solutions Ltd for mortgage and insurance introductions.
Stonebridge Mortgage Solutions Ltd is authorised and regulated by the Financial Conduct Authority.

