

Desborough Road

High Wycombe • Buckinghamshire • HP11 2FP
PCM: £1,200 PCM



coopers
est 1986

This immaculate one bedroom second floor apartment located in the heart of High Wycombe town centre. This exclusive development is positioned close to Eden Shopping Centre and within a short walk of the railway station. The accommodation comprises of entrance hallway with storage cupboards; shower room; open plan living/kitchen with fitted units and appliances and double bedroom. Benefits include gated allocated parking, entry phone system and lift. Available furnished.

Gated Parking Space

Lift

Entryphone System

2nd floor

Immaculate Throughout

Town Centre Location

Close to Railway Station

Fully Fitted Kitchen With Appliances

Moments From Eden Shopping Centre

Furnished

Available Date

11th April 2026

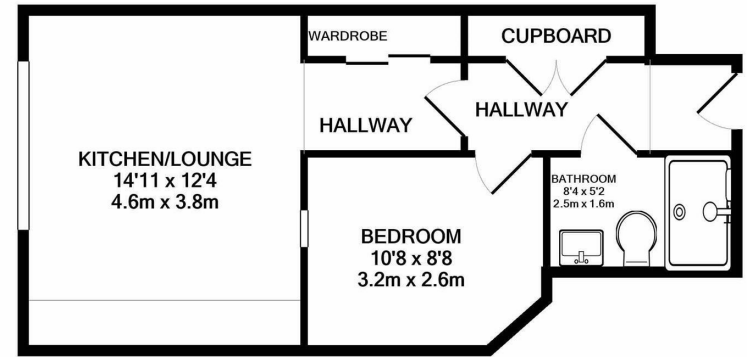

TOTAL APPROX. FLOOR AREA 427 SQ.FT. (39.7 SQ.M.)

Whilst every attempt has been made to ensure the accuracy of the floor plan contained here, measurements of doors, windows, rooms and any other items are approximate and no responsibility is taken for any error, omission, or mis-statement. This plan is for illustrative purposes only and should be used as such by any prospective purchaser. The services, systems and appliances shown have not been tested and no guarantee as to their operability or efficiency can be given. Made with Metropix ©2020



01895 257 566

**1 Vine Street, Uxbridge,
Middlesex, UB8 1QE**

propertymanagement@coopersresidential.co.uk

CoopersResidential.co.uk

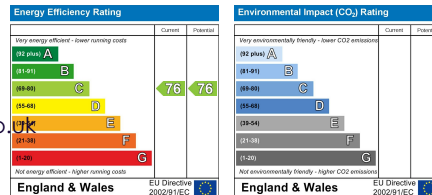

Important Notice: These particulars, whilst believed to be accurate are set out as a general outline only for guidance and do not constitute any part of an offer or contract. Intending purchasers should not rely on them as statements or representation of fact, but must satisfy themselves by inspection or otherwise has the authority to make or give any representation or warranty in respect of the property.

coopers
est 1986