



## 29 Cheesemans Green Lane

Kingsnorth, TN25 7EX

Offers In Excess Of £500,000

A most impressive detached family home on the popular Bridgefield development.

Much enhanced by the current owners, this lovely property offers an inviting entrance hall, sitting room, modernised kitchen/dining room, family room/study and cloakroom. To the first floor are four well proportioned bedrooms and contemporary en suite & family bathroom.

A well maintained garden can be found to the rear which enjoys a secluded feel with further benefits including gas central heating, double glazing, double garage & driveway.

There are some lovely countryside walks nearby with local schools and shops easily accessible also.

### Viewing

Please contact our Ashford Office on 01233 646411 if you wish to arrange a viewing appointment for this property or require further information.

- IMPRESSIVE DETACHED FAMILY HOME
- FOUR BEDROOMS
- MODERNISED EN SUITE & FAMILY BATHROOM
- KITCHEN/BREAKFAST ROOM
- STUDY/FAMILY ROOM
- DOUBLE DETACHED GARAGE & DRIVEWAY
- TASTEFULLY DECORATED
- UTILITY & GROUND FLOOR CLOAKROOM
- NEARBY COUNTRYSIDE WALKS





Floor Plan

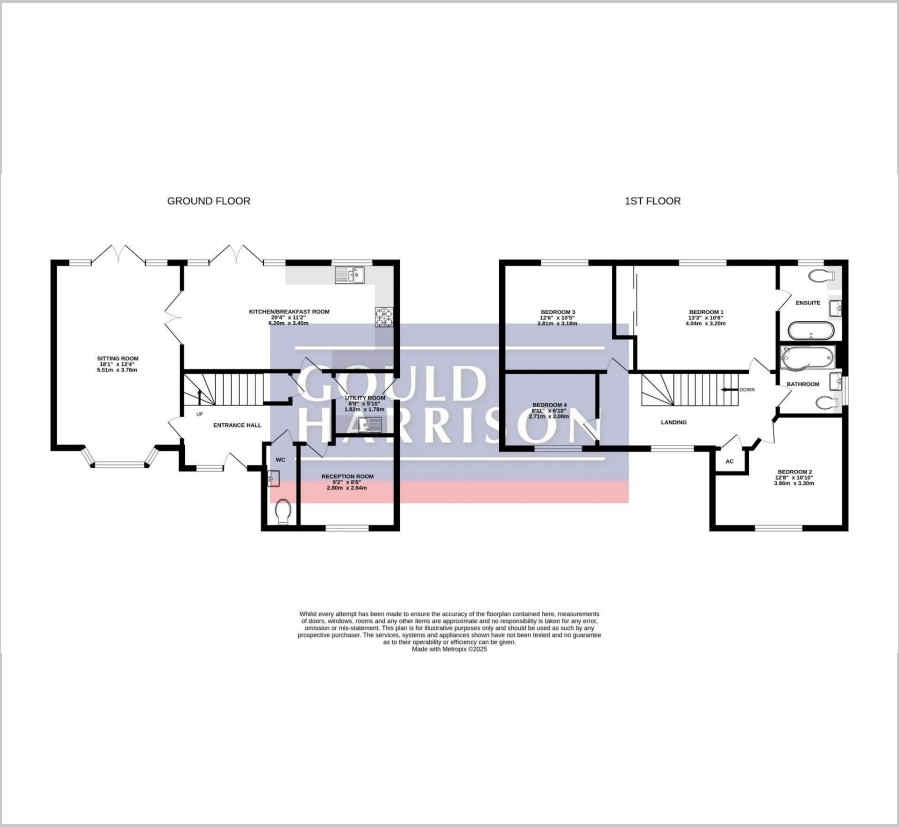

Area Map



Energy Efficiency Graph

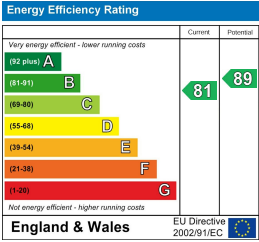

These particulars, whilst believed to be accurate are set out as a general outline only for guidance and do not constitute any part of an offer or contract. Intending purchasers should not rely on them as statements of representation of fact, but must satisfy themselves by inspection or otherwise as to their accuracy. No person in this firms employment has the authority to make or give any representation or warranty in respect of the property.