



jordan fishwick

Barnes Street New Mills

Barnes Street New Mills SK22 4AB

£365,000



The Property

Beautifully presented throughout and located on the popular High Hill View development in New Mills, a 2025 Wain Homes built, four-bedroom semi-detached home. Versatile, upgraded accommodation arranged over three floors with a lovely landscaped rear garden. Ample driveway parking, high energy efficiency and NHBC Warranty. Comprising: entrance hall, wc, living room, fitted dining kitchen with French doors, three first floor bedrooms and contemporary bathroom, second floor master bedroom with en-suite shower room. Double glazing, central heating and Viewing is a must!



- Stunning Semi-Detached Home
- Four Bedrooms
- Popular Modern Development in New Mills
- 2025 Built and NHBC Warranty
- Ample Driveway Parking and Landscaped Garden
- Beautifully Presented Throughout
- High Energy Efficiency
- Pvc Double Glazing and Gas Central Heating
- Arranged Over Three Floors

Postcode SK22 4AB
 EPC Rating B
 Local Authority High Peak
 Council Tax C

Energy Efficiency Rating		
	Current	Potential
Very energy efficient - lower running costs		
(92 plus) A		95
(81-91) B	85	
(69-80) C		
(55-68) D		
(39-54) E		
(21-38) F		
(1-20) G		
Not energy efficient - higher running costs		
England & Wales		EU Directive 2002/91/EC 



GROUND FLOOR

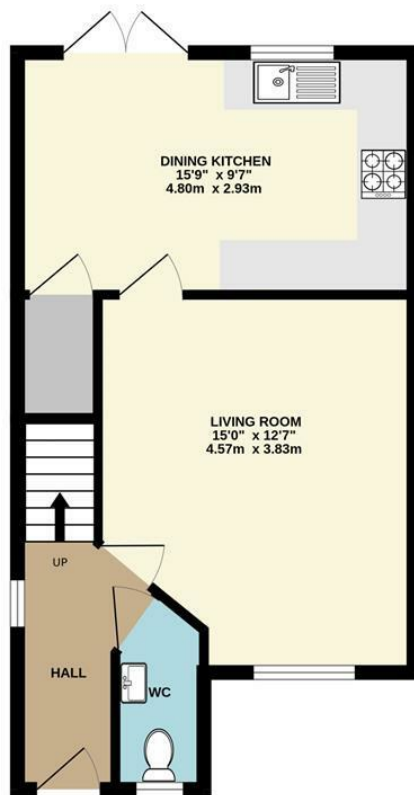

1ST FLOOR

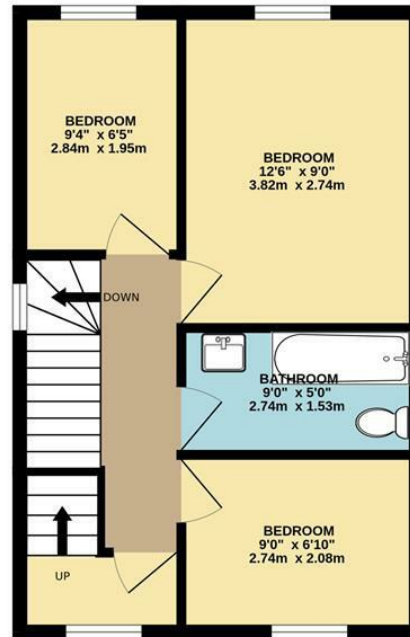

2ND FLOOR

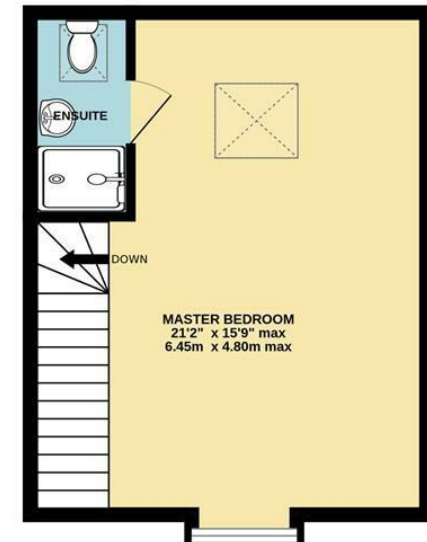

Whilst every attempt has been made to ensure the accuracy of the floorplan contained here, measurements of doors, windows, rooms and any other items are approximate and no responsibility is taken for any error, omission or mis-statement. This plan is for illustrative purposes only and should be used as such by any prospective purchaser. The services, systems and appliances shown have not been tested and no guarantee as to their operability or efficiency can be given.
Made with Metropix ©2026



These particulars are believed to be accurate but they are not guaranteed and do not form a contract. Neither Jordan Fishwick nor the vendor or lessor accept any responsibility in respect of these particulars, which are not intended to be statements or representations of fact and any intending purchaser or lessee must satisfy himself by inspection or otherwise as to the correctness of each of the statements contained in these particulars. Any floorplans on this brochure are for illustrative purposes only and are not necessarily to scale.

Offices at: Chorlton, Didsbury, Disley, Hale, Glossop, Macclesfield, Manchester Deansgate, Manchester Whitworth Street, New Mills, Sale, Wilmslow and Withington

14 Market St, Disley, Cheshire, Stockport SK12 2AA

01663 767878

disley@jordanfishwick.co.uk

www.jordanfishwick.co.uk