



01947 601301



BIRCH COTTAGE, LEALHOLM

3 BED COTTAGE



WWW.HOPEANDBRAIMESTATEAGENTS.CO.UK



PROPERTY FEATURES

- Semi-Detached Stone Cottage with a Yard
- Well Presented with Modern Fixtures & Fittings
- Lounge with Feature Fireplace & Beamed Ceiling
- Open Plan Kitchen/Diner with Integrated Appliances
- 3 Bedrooms & 2 Bathrooms including an En-Suite
- Oil Central Heating & Double-Glazing Throughout
- Village Setting with a Primary School, Pub & Shop
- Located in the Heart of the North York Moors

Type: **COTTAGE**

Availability: **FOR SALE**

Bedrooms: **3**

Bathrooms: **1**

Reception Rooms: **1**

Parking: **ON ROAD PARKING**

Outside Space: **PATIO**

Tenure: **FREEHOLD**

01947 601301

www.hopeandbraimstateagents.co.uk



BIRCH COTTAGE, LEALHOLM- 3 bed Cottage -£295,000



Hope & Braim Estate Agents are pleased to present Birch Cottage, a well-presented semi-detached stone cottage situated in the heart of Lealholm, one of the most charming villages in the North York Moors National Park. Combining character features with contemporary comforts, the property offers an appealing prospect for those seeking a home in this sought-after rural setting. The ground floor accommodation opens with a lounge of considerable warmth and character, centred on a feature fireplace and retaining an exposed beamed ceiling that speaks to the cottage's origins. To the rear, an open plan kitchen and dining area provides a sociable and practical everyday space, fitted with integrated appliances and finished to a modern standard that complements the building's traditional fabric. A shower room or cloakroom completes the ground floor. To the first floor, three bedrooms are arranged across the upper level, the principal room benefiting from an en-suite facility. A further family bathroom serves the remaining bedrooms. Oil-fired central heating and double-glazing throughout ensure year-round comfort and energy efficiency. Externally, the property enjoys the benefit of a private yard, a welcome outdoor space that suits both everyday use and relaxed entertaining in the warmer months. Lealholm is a thriving North Yorkshire village offering daily amenities including a primary school, public house and village shop, all within easy reach of the property. The village sits within the National Park boundary, with walking country immediately to hand and the market towns of Whitby and Guisborough accessible within a short drive.

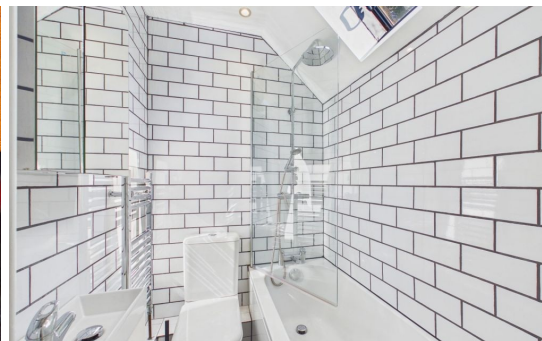

BIRCH COTTAGE, LEALHOLM- 3 bed Cottage -£295,000

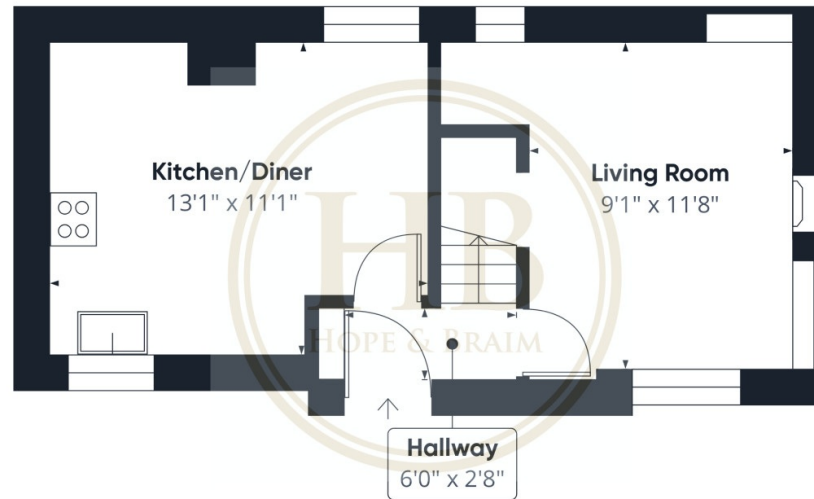

Floor 0

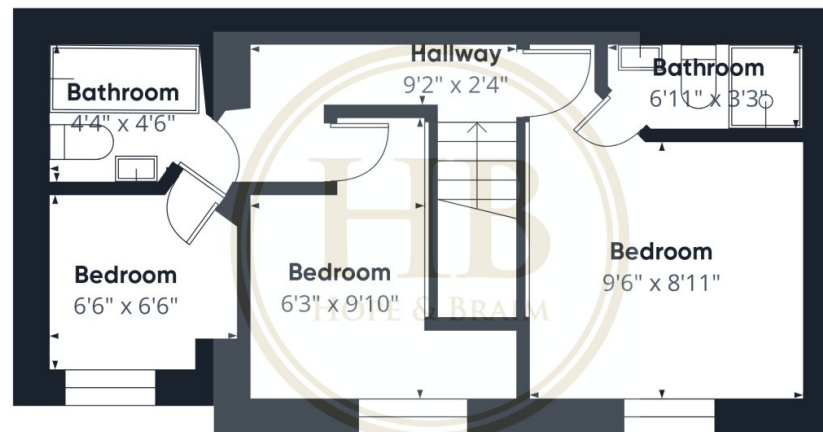

Floor 1



Approximate total area⁽¹⁾
556 ft²

(1) Excluding balconies and terraces

Calculations reference the RICS IPMS 3C standard. Measurements are approximate and not to scale. This floor plan is intended for illustration only.

GIRAFFE360

Energy Efficiency Rating		Current	Potential
Very energy efficient - lower running costs	A		
Energy efficient - lower running costs	B		
Decent energy efficiency - lower running costs	C		
Some energy efficiency - higher running costs	D		
Not very energy efficient - higher running costs	E	48	52
Very poor energy efficiency - highest running costs	F		
Least energy efficient - highest running costs	G		

England, Scotland & Wales EU Directive 2002/91/EC

Disclaimer: This brochure and property details are a representation of the property offered for sale or rent, as a guide only.

Brochure content must not be relied upon as fact and does not form any part of a contract. Measurements are approximate.

No fixtures or fittings, heating system or appliances have been tested, nor are they warranted by Hope & Braim or any staff member in any way as being functional or regulation compliant.

Hope & Braim do not accept any liability for any loss that may be caused directly or indirectly by the brochure content, all interested parties must rely on their own, their surveyor's or solicitor's findings.

We advise all interested parties to check with the local planning office for details of any application or decisions that may be consequential to your decision to purchase or rent any property.

Any floor plans provided should be used for illustrative purposes only and should be used as such by any interested party.

