



Forest Road, Witham, CM8 2PF



welcome to

Forest Road, Witham

A spacious and well-presented three-bedroom family home offering two reception rooms, a modern kitchen, a ground-floor WC, and a versatile garden cabin—perfect for home working or hobbies. Ideally located close to schools, shops and transport links.



Hallway

Stairs leading to first floor. Under stairs storage cupboard. Radiator. Pendant lighting. Door leading to:

Ground Floor Cloakroom

Obscure double glazed window. Low level WC. Wall mounted hand wash basin with vanity unit.

Lounge

12' 9" x 10' 2" (3.89m x 3.10m)

Double glazed bay window. Double glazed French doors leading to rear garden. Radiator. Carpets.

Pendant lighting,

Dining Room

10' 6" x 11' 6" (3.20m x 3.51m)

Double glazed window. Radiator. Laminate flooring. Pendant lighting.

Kitchen

12' 5" x 9' 6" (3.78m x 2.90m)

Double glazed window and door to rear garden.

Range of matching base and eye level units with work surface over incorporating a sink drainer with hot and cold mixer tap. Plumbing and space for washing machine. Electric hob and over head extractor fan. Built in double oven. Space for fridge freezer. Part tiled walls.

Landing

Loft access. Doors leading to:-

Bedroom One

12' 9" x 11' 6" (3.89m x 3.51m)

Double glazed window. Radiator. Built in wardrobes. Carpets. Pendant lighting.

Bedroom Two

12' 9" x 9' 10" (3.89m x 3.00m)

Double glazed window. Radiator. Built in wardrobes. Carpets. Pendant lighting.

Bedroom Three

10' 6" x 7' 3" (3.20m x 2.21m)

Double glazed window. Radiator. Carpets. Pendant lighting.

Bathroom

5' 7" x 9' 6" (1.70m x 2.90m)

Obscure double glazed window. Side panel bath with over head shower. Pedestal hand wash basin. Low level WC. Laminate flooring. Part tiled walls.

Garden

Commencing with patio seating area with pergola.

Remainder laid to lawn with shrub borders.. Enclosed by panel fencing. Gate. Cabin.

Cabin

5' 11" x 9' 9" (1.80m x 2.97m)



view this property online williamhbrown.co.uk/Property/BTR109869



welcome to

Forest Road, Witham

- Three Bedroom Home
- Two Spacious Reception Rooms
- Ground-Floor WC
- Private Rear Garden
- Detached Garden Cabin

Tenure: Freehold EPC Rating: C
Council Tax Band: B

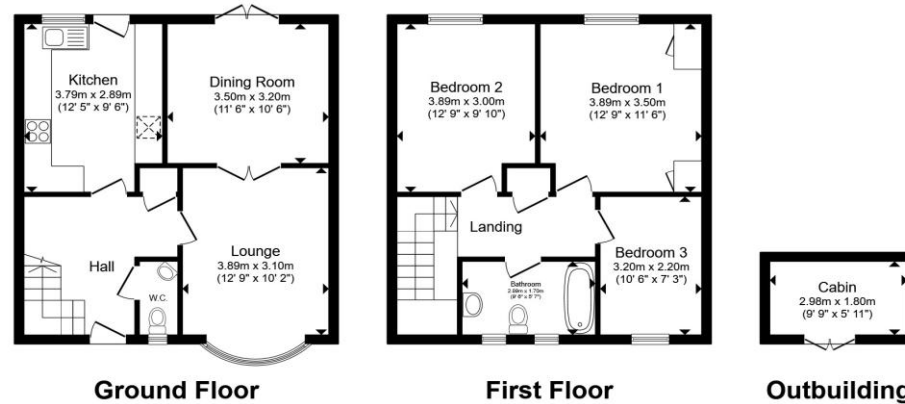

£340,000

Total floor area 100.9 m² (1,086 sq.ft.) approx
This floor plan is for illustrative purposes only. It is not drawn to scale. Any measurements, floor areas (including any total floor area), openings and orientation are approximate. No details are guaranteed, they cannot be relied upon for any purpose and they do not form part of any agreement. No liability is taken for any error, omission or misstatement. A party must rely upon its own inspection(s). Powered by www.propertybox.io



Please note the marker reflects the postcode not the actual property

view this property online [williamhbrown.co.uk/Property/BTR109869](https://www.williamhbrown.co.uk/Property/BTR109869)



Property Ref:
BTR109869 - 0002

1. MONEY LAUNDERING REGULATIONS Intending purchasers will be asked to produce identification documentation at a later stage and we would ask for your co-operation in order that there is no delay in agreeing the sale. 2. These particulars do not constitute part or all of an offer or contract. 3. The measurements indicated are supplied for guidance only and as such must be considered incorrect. Potential buyers are advised to recheck measurements before committing to any expense. 4. We have not tested any apparatus, equipment, fixtures or services and it is in the buyers interest to check the working condition of any appliances. 5. Where an EPC, or a Home Report (Scotland only) is held for this property, it is available for inspection at the branch by appointment. If you require a printed version of a Home Report, you will need to pay a reasonable production charge reflecting printing and other costs. 6. We are not able to offer an opinion either written or verbal on the content of these reports and this must be obtained from your legal representative. 7. Whilst we take care in preparing these reports, a buyer should ensure that his/her legal representative confirms as soon as possible all matters relating to title including the extent and boundaries of the property and other important matters before exchange of contracts.

William H Brown is a trading name of Sequence (UK) Limited which is registered in England and Wales under company number 4268443, Registered Office is Cumbria House, 16-20 Hockliffe Street, Leighton Buzzard, Bedfordshire, LU7 1GN. VAT Registration Number is 500 2481 05.

william h brown



01376 320018



braintree@williamhbrown.co.uk



51-53 High Street, BRAINTREE, Essex, CM7 1JX



[williamhbrown.co.uk](https://www.williamhbrown.co.uk)