



Roland Mews, E1

£3,000 Per calendar month

A two double bedroom house is ideally situated within a secure gated mews. Arranged over two floors with a private garden. Available for a Short Let this property would be ideal for a professional couple or sharers.

Stepney Green Station is a short walk away with Bethnal Green and Whitechapel stations also within close proximity for links around the city and beyond.

Features

- Two Double Bedrooms
- Furnished
- Private Garden
- Split Level
- Natural Sunlight
- Short Let

Roland Mews, London, E1

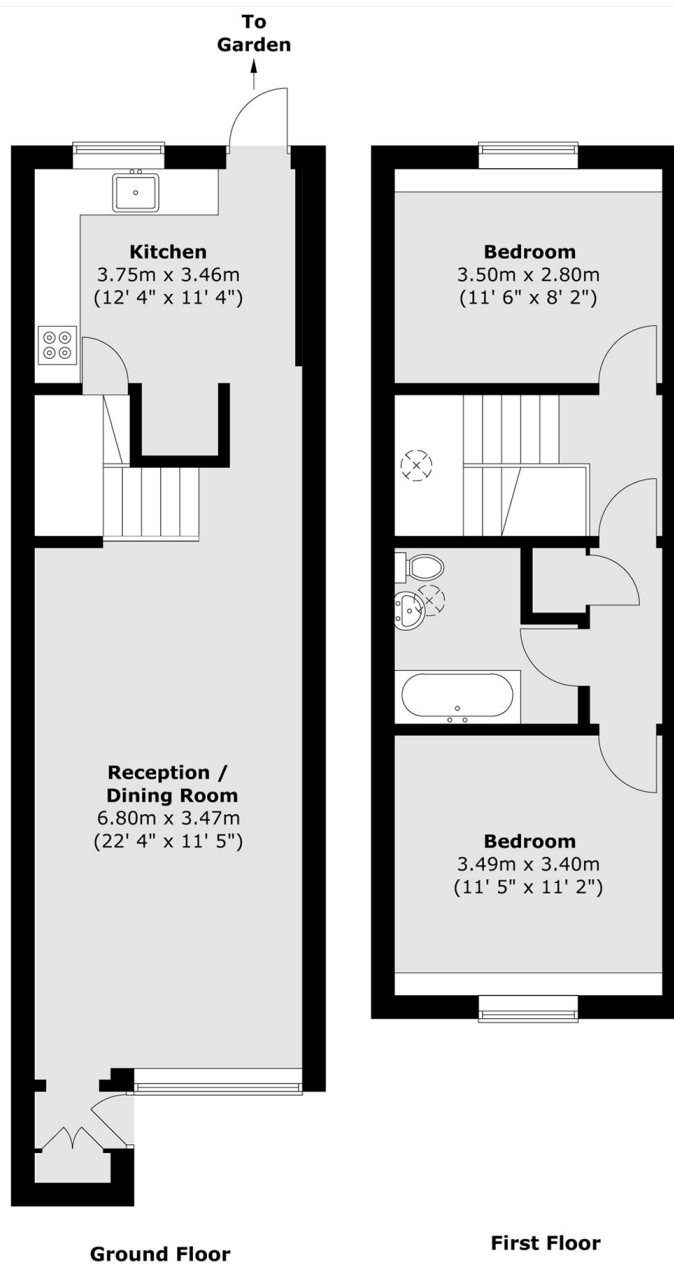

Total area (approx.) : 81.3 sq. m (875 sq. ft)