

# Southampton, Hampshire, SO45

**Quickmove**  
PROPERTIES



Price as listed

 x 1

 x 1

This brand new, fully-furnished luxury park home is perfect for those looking for a detached, easy to maintain, bungalow-style property. The home has one double bedroom and an open-plan kitchen and living area.

The M27, a few miles away, provides a link to the national motorway system. Marchwood, 2 miles away, has a Supermarket, Post Office and Doctor. Southampton has an excellent shopping centre together with cinema and theatre, etc. Milk is delivered daily on the park and a Hairdresser visits regularly. There are many local places of interest to visit, including the New Forest, Isle of Wight, Winchester and Salisbury. Local sports facilities include golf, swimming, bowls and of course sailing.

Age restriction: Over 50s

Pet friendly: Cats only

Site fees: £310 per month

Residential license

### Key Features

- High spec
- Brand new home
- Community Living
- Fully Fitted Kitchen
- One Double Bedroom
- Over 50s
- Part Exchange Available
- Modern home
- Garden space
- Semi-Rural Location

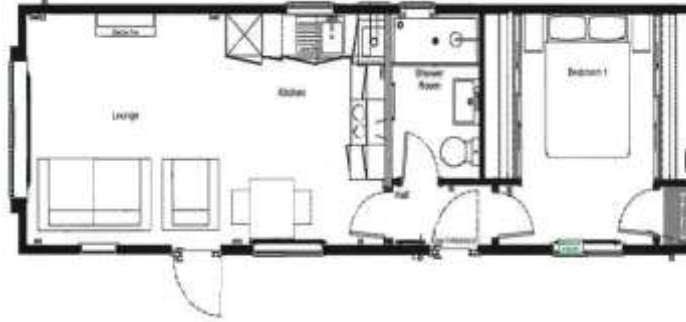

### House to sell?

Hassle-free Property Part-Exchange is available from Quickmove Properties, with no estate agent fees, no solicitor's fees and no market uncertainty.

### CONTACT US

01793 840917

[advice@quickmoveproperties.co.uk](mailto:advice@quickmoveproperties.co.uk)

