



# 41 St Andrew's Lodge, Chippenham, SN15 3HN

An immaculately presented two bedroom top floor apartment within a purpose built retirement development just a stones throw from the town centre. The apartment occupies a quiet position at the side of the building, near the lift, and is presented in show home condition throughout the accommodation offers a spacious reception hall with two useful storage cupboards, a sitting/dining room which leads to a well appointed kitchen with a range of high gloss units, integrated oven, hob and fridge/freezer, master bedroom includes a spacious walk-in wardrobe, there is a second double bedroom with built-in double wardrobe, quality shower room and a separate guest cloakroom.

All heating and hot water supplies are provided by a ground source heat pump which means the cost of this is included as part of the annual service charges. Other benefits include a 24 hour emergency response system, as well as an intruder alarm system and double glazing. There are also a number of on-site facilities which include a delightful residents' lounge with coffee/wine bar, lodge manager, 24 hour emergency response system and a guest suite for friends and family.

## Situation

The town is just south of the M4 motorway, giving easy access to London, Bristol and South Wales. Chippenham boasts that it is one of the West Country's most dynamic and thriving market towns. Surrounded by history and nestled on the banks of the River Avon, Chippenham lies between the Marlborough Downs to the east, the Cotswolds to the north and west, and Salisbury Plain to the south. Surrounding the town are a number of villages including Lacock, Biddestone and Castle Combe. Chippenham is easily accessible by bus and rail. It is on the mainline route from London Paddington to the West Country and offers regular bus services to Bath, Trowbridge, Swindon, Calne and Devizes. Further, there is a national coach service connecting Chippenham to London, Wales, the South West, Midlands and East Anglia.

## Accommodation Comprising:

Entrance door to:

## Reception Hall

Radiator. Deep storage cupboard. Storage cupboard. Coving. Telephone entry system. Doors to:

## Sitting Room

Double glazed window to side with a view over the rooftops. Radiator. Coving. Door to:

## Communal Gardens

The property enjoys the use of a landscaped communal garden.

## Onsite Facilities

- \* Secure entry system and internal telephone system (no charges to phone other residents)
- \* 24 hour emergency response and Intruder Alarm included in service charges.
- \* Services of a Lodge Manager (Mon- Fri 9-5pm)
- \* Lift
- \* Scooter Storage spaces
- \* Private parking
- \* Owners Lounge with television and coffee / wine bar
- \* Guest Suite for owners' family/friends
- \* Social Activities (organised by residents and lodge manager)

## Service Charge

The cost of the service charge includes all heating, water, window cleaning, gardening and rubbish collections.

## ENERGY PERFORMANCE GRAPHS

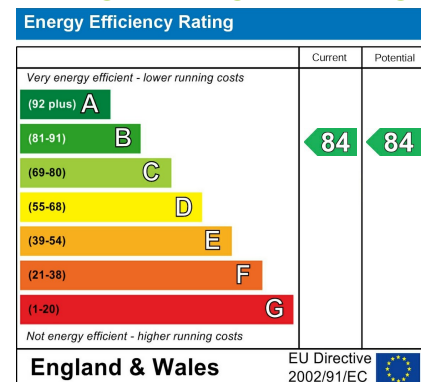

Council Tax Band: D

Tenure: Leasehold

## GOODMAN WARREN BECK

64 Market Place

Chippenham, Wiltshire SN15 3HG

Tel 01249 444449 | Fax 01249 448989

Email [info@goodmanwb.co.uk](mailto:info@goodmanwb.co.uk)

Price Guide £315,000

## Kitchen

Range of high gloss drawer and cupboard base units and matching wall mounted cupboards with under unit lighting. Worksurfaces with tiled splashbacks and inset single bowl single drainer stainless steel sink unit with chrome mixer tap. Built-in electric hob with stainless steel extractor over. Built-in eye level oven. Integrated fridge/freezer. Spotlights.

## Bedroom One

Double glazed window to side. Radiator. Access to roof space. Coving. Deep walk-in cupboard with shelving, hanging rails and automatic lights.

## Bedroom Two

Double glazed window to side. Radiator. Built-in double wardrobe. Coving.

## Shower Room

Extra wide shower cubicle. Vanity wash basin with cupboard under and mixer tap. Close coupled WC with concealed cistern. Fitted cupboards with mirror and light. Chrome ladder radiator. Fully tiled walls.

## Guest Cloakroom

Electric chrome ladder radiator. Wall hung wash basin with chrome mixer tap and tiled splashbacks. Close coupled WC with concealed cistern. Mirror.

## Directions

From the Market Place proceed along The Causeway where the property will be found on the right hand side.

SECOND FLOOR  
746 sq.ft. (69.3 sq.m.) approx.

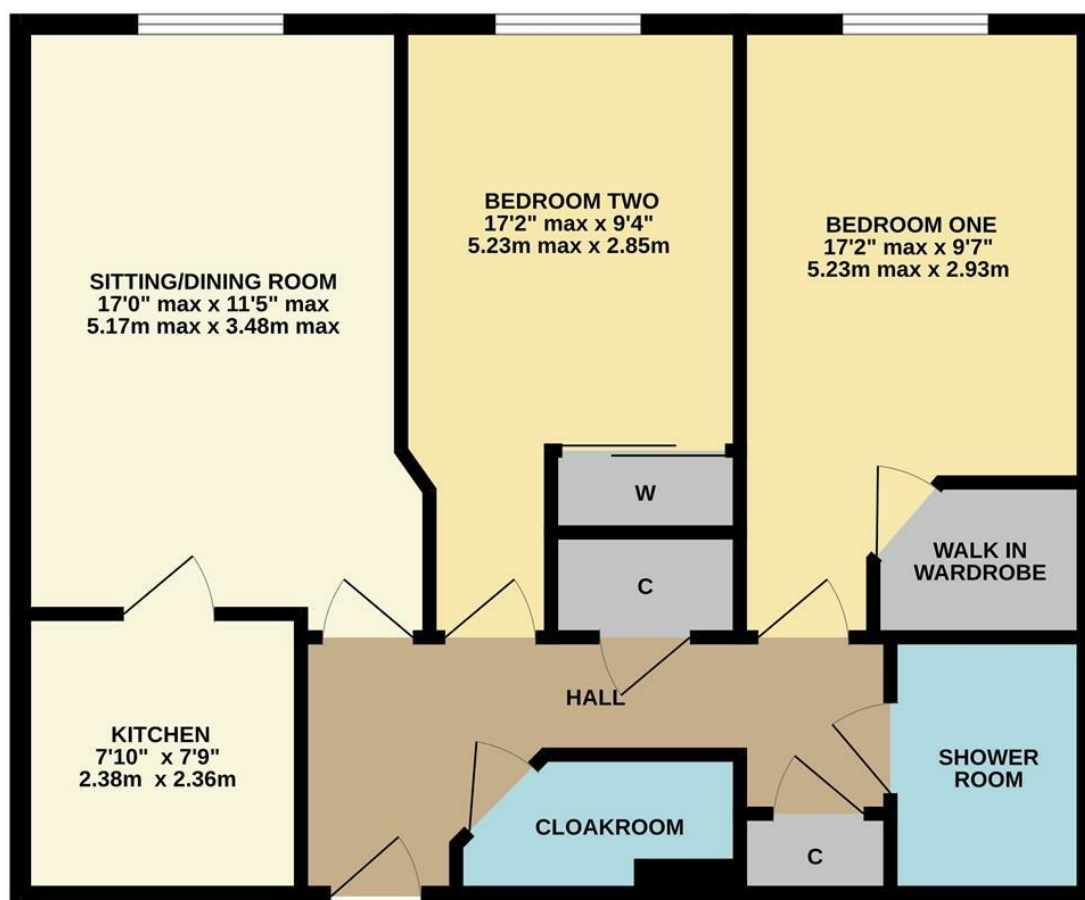

TOTAL FLOOR AREA: 746 sq.ft. (69.3 sq.m.) approx.

Whilst every attempt has been made to ensure the accuracy of the floorplan contained here, measurements of doors, windows, rooms and any other items are approximate and no responsibility is taken for any error, omission or mis-statement. This plan is for illustrative purposes only and should be used as such by any prospective purchaser. The services, systems and appliances shown have not been tested and no guarantee as to their operability or efficiency can be given.  
Made with Metropix ©2005.