



CRAWFORD MANSIONS, W1H

£1,000,000

Two double bedrooms
Beautifully finished
First floor
Balcony off kitchen
Lovely bathroom
Energy rating: c

@marshandparsons
marshandparsons.co.uk

MARSH &
PARSONS



ABOUT THE PROPERTY

Set on the first floor of the sought-after Crawford Mansions in the heart of Marylebone, this beautifully presented two-bedroom, one-bathroom flat has been finished to an exceptional standard throughout. The property boasts a meticulously designed interior, featuring a high-end kitchen, a luxurious, contemporary bathroom and large bright reception room . A standout feature is the private balcony leading directly off the kitchen.

Crawford Mansions is located on Crawford Street itself which is a quiet road in the heart of Marylebone and offers a wonderful selection of amenities.



STEP INSIDE CRAWFORD MANSIONS

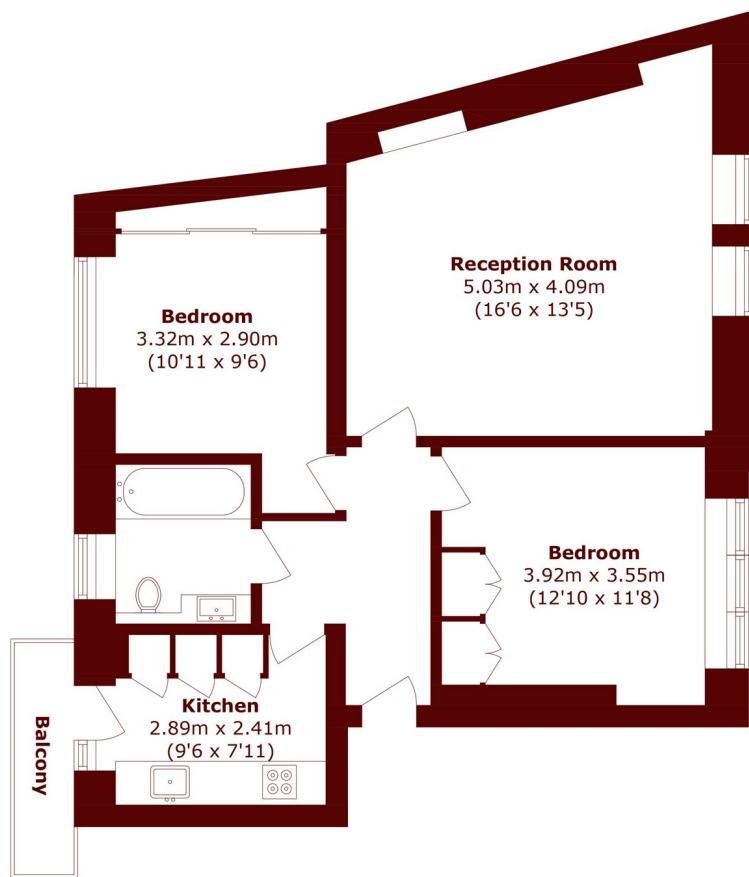

First Floor

Total area (approx.): 73.1 sq. m (786.8 sq. ft)
Balcony area (approx.): 2.6 sq. m (28.1 sq. ft)

Marylebone & Mayfair
020 7935 1775

Energy Rating: C We aim to make our particulars both accurate and reliable. However, they are not guaranteed; nor do they form part of an offer or contract. If you require clarification on any points then please contact us, especially if you're traveling some distance to view. Please note that appliances and heating systems have not been tested and therefore no warranties can be given as to their good working order

MARSH &
PARSONS