

Navigators Walk, E3

£3,250 Per week

A beautifully presented two double bedroom two bath apartment in Lorimer House. This first floor apartment comes with a large open plan reception, underfloor heating, floor to ceiling windows and large private balcony overlooking the canal.

Located within the heart of Hackney Wick in Fish Island. Close to Victoria Park and the Regents Canal, as well as a number of local independent bars and restaurant.

Features

- Two Double Bedroom
- Two Bathroom
- Open Plan
- Canal Views
- Floor to Ceiling Windows
- Two Private Balconies

Navigators Walk, London, E3

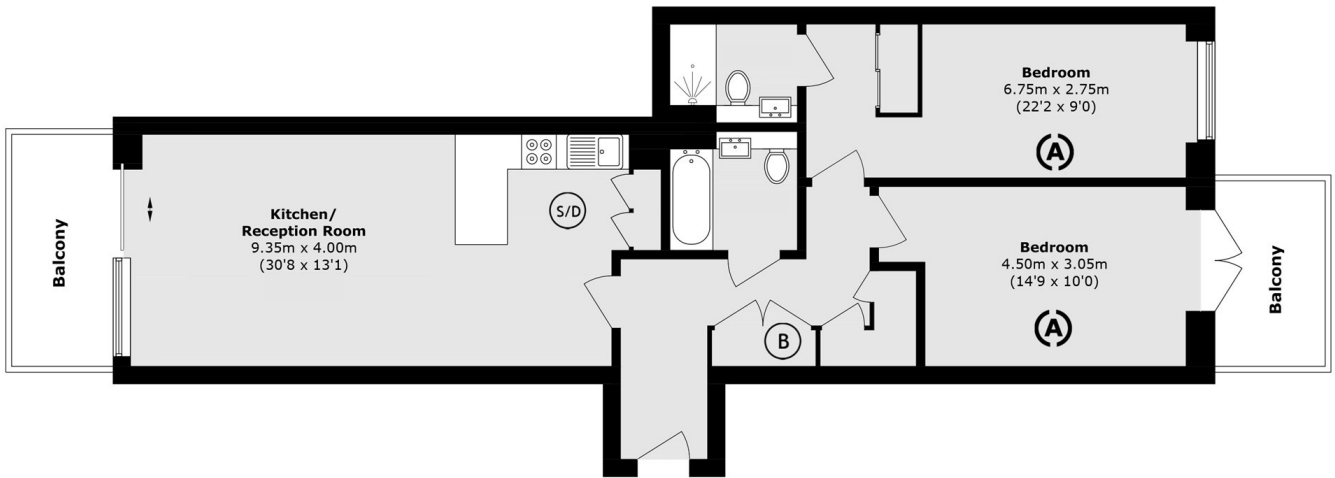

Total area (approx.): 93.2 sq. m (1003.2 sq. ft)
Balcony area (approx.): 13.0 sq. m (139.9 sq. ft)