



**Connells**

Broad Rush Green  
Leighton Buzzard



## Property Description

This recently refurbished three-bedroom end-terraced home offers contemporary living throughout, ideal for families, first-time buyers, or anyone seeking a move in ready property in a desirable location.

The ground floor features an impressive open-plan lounge and dining area, creating a bright and welcoming space perfect for both everyday living and entertaining. The layout flows seamlessly into the stylish modern kitchen, fitted with sleek units and quality finishes, making it the perfect spot for cooking and socialising.

Upstairs, the property offers three well-proportioned bedrooms and a family bathroom, all presented in excellent condition following the refurbishment.

To the rear, you'll find a private garden-a great space for children to play, summer dining, or simply relaxing outdoors. The property also benefits from a garage and driveway parking to the rear, providing practical off road parking and useful storage.

Just a short walk away are the picturesque Bluebell Woods, offering beautiful walking trails-ideal for families, dog walkers, and anyone who loves the outdoors.

## Entrance Hall

Carpeted flooring.

## Lounge/ Diner

Double glazed window. Radiator. Feature gas fireplace. Patio doors to rear. Space for table and chairs. Carpeted flooring.

## Kitchen

Double glazed window. Fitted kitchen with wall and base units, partly tiled walls. 1.5 bowl stainless steel sink and drainer. Space for fridge freezer. Plumbing for dishwasher. Integrated oven. Plumbing for washing machine. Integrated gas hob with cooker hood over. Patio doors to rear.

## Landing

Double glazed window. Loft access. Carpeted flooring.

## Bedroom One

Double glazed window. Radiator. Carpeted flooring.

## Bedroom Two

Double glazed window. Radiator. Carpeted flooring.

## Bedroom Three

Double glazed window. Radiator. Carpeted flooring.

## Bathroom

Double glazed window. Bath with shower over. Wash hand basin. WC. Tiling to water sensitive areas. Radiator.

## Front Garden

Mainly laid to lawn. Pathway to front door. Access to rear garden.

## Rear Garden

Patio area. Stairs down to lawn area. Patio area. Side access. Outside tap. Courtesy door to garage. Wooden panelled fencing and brick wall to borders. Block paved patio to rear. Covered Pergola.

## Garage

Up & over door. Courtesy door to garden.







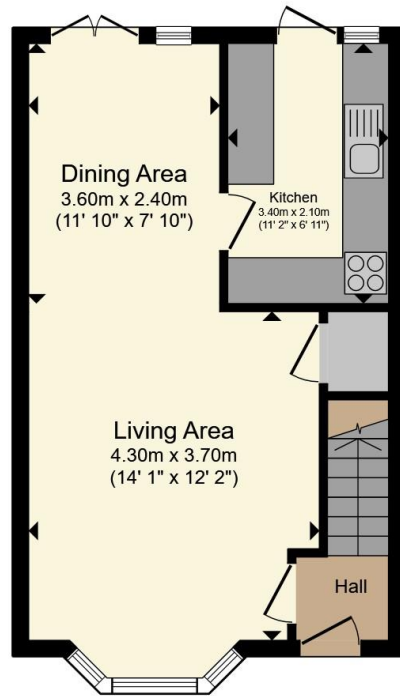

**Ground Floor**

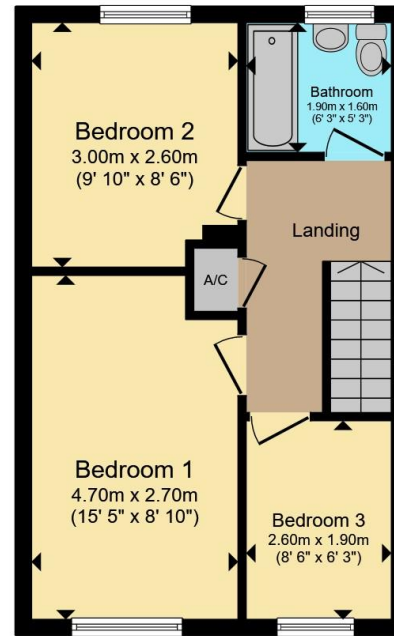

**First Floor**

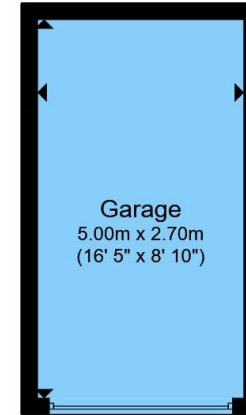

**Garage**

Total floor area 87.6 m<sup>2</sup> (943 sq.ft.) approx

This floor plan is for illustrative purposes only. It is not drawn to scale. Any measurements, floor areas (including any total floor area), openings and orientation are approximate. No details are guaranteed, they cannot be relied upon for any purpose and they do not form part of any agreement. No liability is taken for any error, omission or misstatement. A party must rely upon its own inspection(s). Powered by [www.propertybox.io](http://www.propertybox.io)

**Connells**

To view this property please contact Connells on

**T 01525 372 588**  
**E [leightonbuzzard@connells.co.uk](mailto:leightonbuzzard@connells.co.uk)**

4 Market Square  
 LEIGHTON BUZZARD LU7 1HA

EPC Rating: C Council Tax  
 Band: C

Tenure: Freehold

**view this property online [connells.co.uk/Property/LBC311524](http://connells.co.uk/Property/LBC311524)**



1. MONEY LAUNDERING REGULATIONS Intending purchasers will be asked to produce identification documentation at a later stage and we would ask for your co-operation in order that there will be no delay in agreeing the sale. 2. These particulars do not constitute part or all of an offer or contract. 3. The measurements indicated are supplied for guidance only and as such must be considered incorrect. Potential buyers are advised to recheck measurements before committing to any expense. 4. We have not tested any apparatus, equipment, fixtures, fittings or services and it is in the buyers interest to check the working condition of any appliances.

Connells Residential is registered in England and Wales under company number 1489613, Registered Office is Cumbria House, 16-20 Hockliffe Street, Leighton Buzzard, Bedfordshire, LU7 1GN. VAT Registration Number is 500 2481 05.

**See all our properties at [www.connells.co.uk](http://www.connells.co.uk) | [www.rightmove.co.uk](http://www.rightmove.co.uk) | [www.zoopla.co.uk](http://www.zoopla.co.uk)**

Property Ref: LBC311524 - 0006