

Butler's
thoughtful estate agency



Mortimer Crescent, Worcester Park, KT4 7QN
Offers over £500,000



Floor Plan

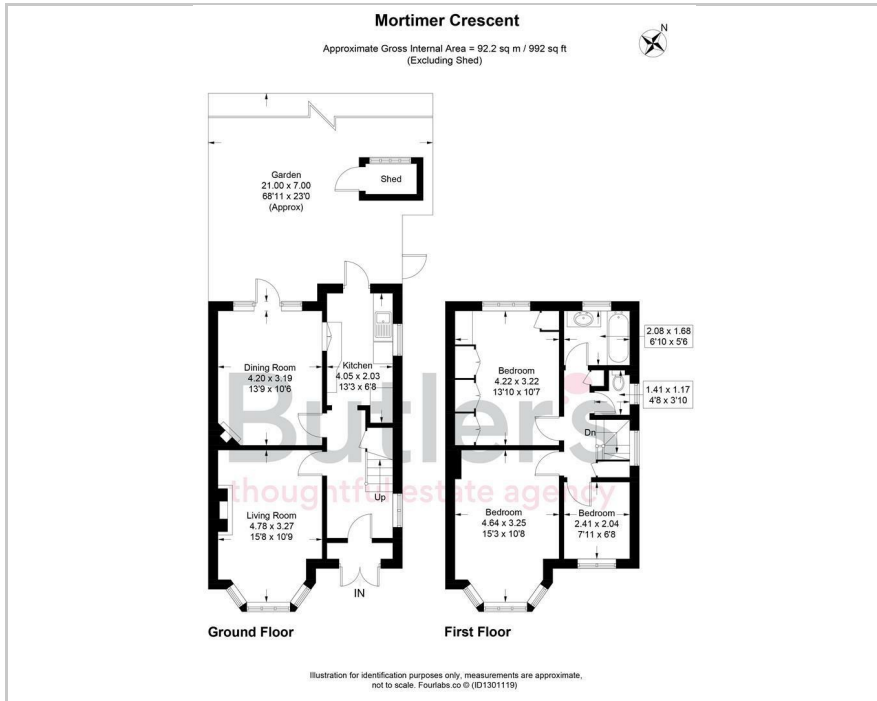

Area Map

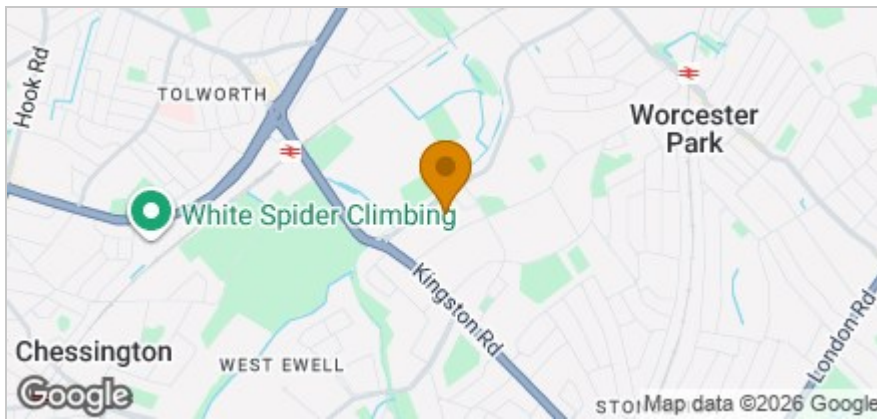

Accommodation

- Attractive 3 Bedroom semi-detached house
- Seller suited
- In need of modernisation
- Brimming with amazing potential
- 2 Reception rooms
- Front & rear gardens
- Fantastic extension possibilities to rear and into the loft - subject to the relevant permissions
- Coveted location close to excellent schooling, transport links & amenities

Viewing

Please contact our Butler's Worcester Park Office on 020 39 069 169 if you wish to arrange a viewing appointment for this property or require further information.

Energy Efficiency Graph

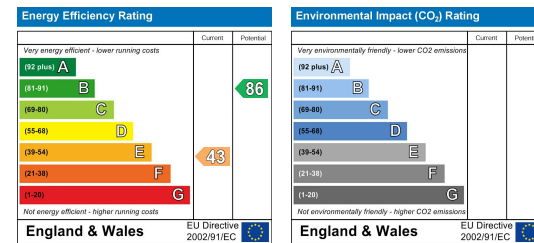

These particulars, whilst believed to be accurate are set out as a general outline only for guidance and do not constitute any part of an offer or contract. Intending purchasers should not rely on them as statements of representation of fact, but must satisfy themselves by inspection or otherwise as to their accuracy. No person in this firm's employment has the authority to make or give any representation or warranty in respect of the property.