



## 19 ARUNDELL ROAD, WSM

---

### ASKING PRICE OF £190,000

**COOKE & CO**  
*your local property expert*

#### PROPERTY FEATURES

- NO ONWARD CHAIN
- TOP FLOOR APARTMENT
- PARKING AND GARAGE
- GARDEN
- SOUGHT-AFTER LOCATION
- LEASEHOLD PROPERTY

## 19 ARUNDELL ROAD, BS23 2QG



Offered with no onward chain, garage, and private garden, this ideally positioned two-bedroom top-floor apartment presents an excellent opportunity for first-time buyers, downsizers, and investors alike.

Bright, spacious, and well presented throughout, the accommodation briefly comprises a communal entrance with stairs rising to a private entrance hall, cloakroom, generous lounge/diner, well-appointed fitted kitchen, two well-proportioned double bedrooms, and a family bathroom.

Externally, the property benefits from off-street parking to the front, alongside a garage with an additional allocated storage area, providing excellent practicality.

To the rear, the apartment enjoys a private garden area accessed via a side gate. Elevated above neighbouring plots, this secluded outdoor space enjoys a pleasant outlook and serves as a wonderful sun trap, ideal for relaxing or entertaining during the warmer months.

### LOCATION

Arundell Road is a popular residential location that offers an excellent balance of convenience, community, and everyday practicality. Well placed for local shops, schools, and essential amenities, it provides everything needed for modern living within easy reach.

The area benefits from excellent transport links, making commuting and travel straightforward, while nearby parks, open spaces, and leisure facilities offer plenty of opportunities to enjoy the outdoors. Whether you're a first-time buyer, growing family, or

downsizer, the neighbourhood's established residential feel creates a welcoming and peaceful environment.

Combining accessibility with a strong sense of community, Arundell Road remains a consistently sought-after address for those looking to enjoy a well-connected lifestyle without sacrificing the comforts of a traditional residential setting.

# 19 ARUNDELL ROAD, WESTON-SUPER-MARE, BS23 2QG

## HALL

## CLOAKROOM

6' 6" x 3' 3" (2.0m x 1.0m)

## LOUNGE/DINER

17' 8" x 13' 5" (5.4m x 4.1m)

## KITCHEN

10' 5" x 8' 2" (3.2m x 2.5m)

## BATHROOM

8' 10" x 8' 6" (2.7m x 2.6m)

## BEDROOM

14' 1" x 11' 1" (4.3m x 3.4m)

## BEDROOM

13' 9" x 10' 9" (4.2m x 3.3m)



## Council Tax:

Band B

## Local Authority:

North Somerset District Council

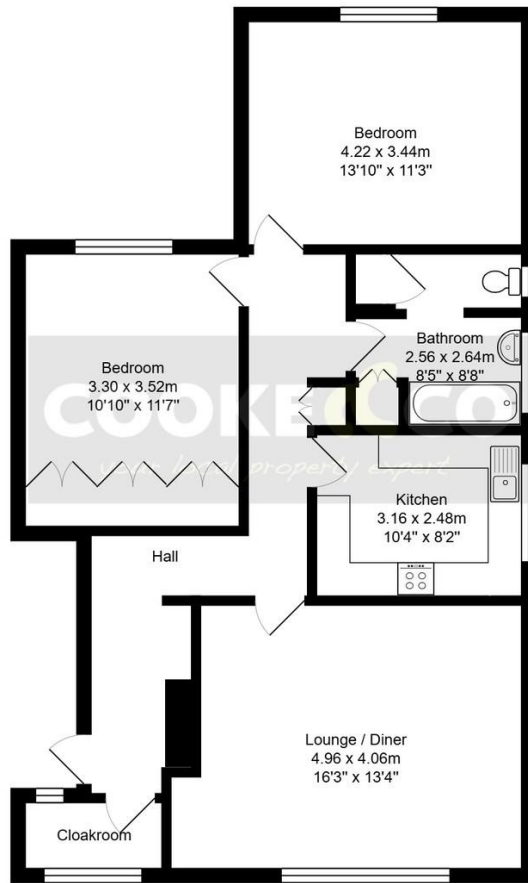

Top Floor

Total Area: 83.8 m<sup>2</sup> ... 902 ft<sup>2</sup>

All measurements are approximate and for display purposes only.



Score	Energy rating	Current	Potential
92+	A		
81-91	B		
69-80	C		76 C
55-68	D	58 D	
39-54	E		
21-38	F		
1-20	G		

[Ben.clarke@cookeproperty.co.uk](mailto:Ben.clarke@cookeproperty.co.uk)

## OFFICE CONTACT INFO

236 High Street  
Worle  
Weston-Super-Mare  
Avon  
BS22 6JE

01934 522244  
enquiries@cookeproperty.co.uk  
www.cookeproperty.co.uk

Agents Note: Whilst every care has been taken to prepare these particulars, they are for guidance purposes only. All measurements are approximate, and are for general guidance purposes only and whilst every care has been taken to ensure their accuracy, they should not be relied upon and potential buyers/tenants are advised to recheck the measurements.

**COOKE & CO**  
your local property expert