

01803 364 029

66 Torwood Street, Torquay
Devon, TQ1 1DT

e: info@hsowen.co.uk

www.hsowen.co.uk



CLARENDON COURT
TORQUAY TQ1 1QA

Guide Price: £90,000- £100,000 Leasehold



CLARENDON COURT TORQUAY TQ1 1QA

Leasehold

Guide Price £90,000- £100,000 A delightful one bedroom first floor apartment, set within a quiet residential development with off road parking. The property briefly comprises of a large double bedroom, a bathroom, living room, kitchen and an enclosed sun terrace/balcony enjoying a superb degree of privacy with a pleasant outlook. The property boasts distant sea views from principle rooms. Requiring some modernization, the property offers a purchaser the opportunity to put their own stamp on it. It also benefits from double glazing. Located on Stitchill Road, the apartment is superbly located with nearby amenities, bus stop and just a short walk to Torwood street with an array of local restaurants, bars, shops and the Harbour.



Hall

Carpet. Coving. Intercom entry phone.

Lounge

Carpet. Electric fire set in fireplace. Tv and television points. Double glazed window to front aspect with distant sea views. Coving. Night storage heater.

Kitchen

Wall and base units. Space for cooker and fridge/freezer. Double glazed tilt and turn window to front elevation. Inset sink and drainer unit. Part tiled walls.

Bathroom

Bath with electric 'Triton' shower over. WC. Electric wall mounted heater. Extractor fan. Obscure glass panel to allow for natural light. Tiled floor. Part tiled walls. Coving.

Bedroom

Large wardrobes with sliding doors. Carpet. Double glazed window to front elevation. Built-in cupboard housing water tank. Night storage heater. Wash hand basin.

Sun Terrace/Balcony

Tiled floor. Distant sea views.



GROUND FLOOR

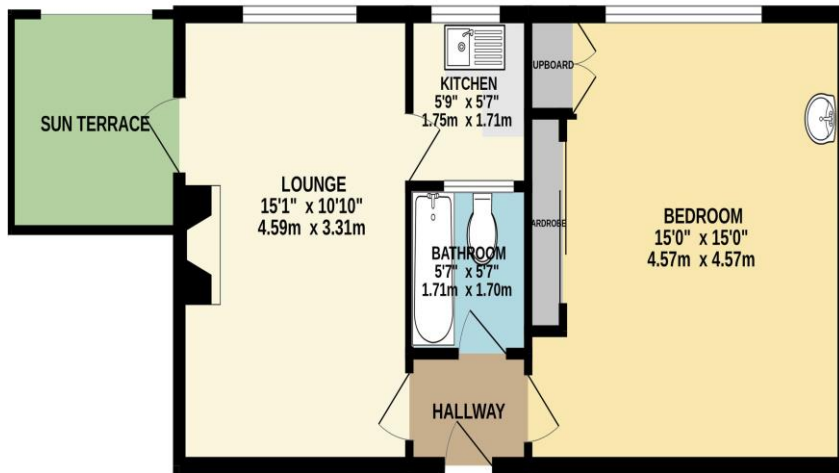

Whilst every attempt has been made to ensure the accuracy of the floorplan contained here, measurements of doors, windows, rooms and any other items are approximate and no responsibility is taken for any error, omission or mis-statement. This plan is for illustrative purposes only and should be used as such by any prospective purchaser. The services, systems and appliances shown have not been tested and no guarantee as to their operability or efficiency can be given.
Made with Memopix ©2023



IMPORTANT: we would like to inform prospective purchasers that these sales particulars have been prepared as a general guide only. A detailed survey has not been carried out, nor the services, appliances and fittings tested. Room sizes should not be relied upon for furnishing purposes and are approximate. If floor plans are included, they are for guidance only and illustration purposes only and may not be to scale. If there are any important matters likely to affect your decision to buy, please contact us before viewing the property.