



HILL STREET MAYFAIR W1J
£756 PER WEEK AVAILABLE 08/04/2026

Hamptons
THE HOME EXPERTS

{ THE PARTICULARS

Hill Street Mayfair W1J

£756 Per Week
Furnished

-  1 Bedroom
-  1 Bathroom
-  1 Reception

Features

- On site building manager, - Available furnished or unfurnished, - Period features,
- CCTV, - Lifts, - Council Tax Band E

Council Tax

Council Tax Band E

Hamptons
7 Lower Sloane Street
Sloane Square, London, SW1W 8AH
020 7824 8242
sloanesquarelettings@hamptons.co.uk
www.hamptons.co.uk

{ A LOVELY ONE BEDROOM APARTMENT IN THE HEART OF MAYFAIR.

The Property

One bedroom apartment (434sq ft) comprising of a large double bedroom, bathroom, spacious reception room with rear facing views over Hay's Mews and a unique kitchenette. The apartment is in one of London's most prestigious locations, Mayfair, neighbouring the famous Berkeley Square. This beautiful purpose built building benefits from spacious living accommodation, lift service, on-site building manager, and is nestled conveniently between two of London's parks Hyde Park and Green Park. London underground stations Green Park, Bond Street and Marble Arch are all within a short stroll away.

Location

Located on the corner of Hill Street and Waverton Street. London underground stations, Green Park, Bond Street and Marble Arch are all within close proximity with Green Park the closest at half a mile away.



HILL STREET

APPROXIMATE GROSS INTERNAL AREA
437 SQ. FT. (40.6 SQ. M.)

**This plan has been drawn from supplied plans,
strictly for use as a guide only.**

This plan is for layout guidance only. Not drawn to scale unless stated. Windows and door openings are approximate. Whilst every care is taken in the preparation of this plan, please check all dimensions, shapes and compass bearings before making any decisions reliant upon them. Please be advised that Countrywide / our agents have not seen or reviewed any building regulations or planning permission in relation to works carried out to the property (ID613528)

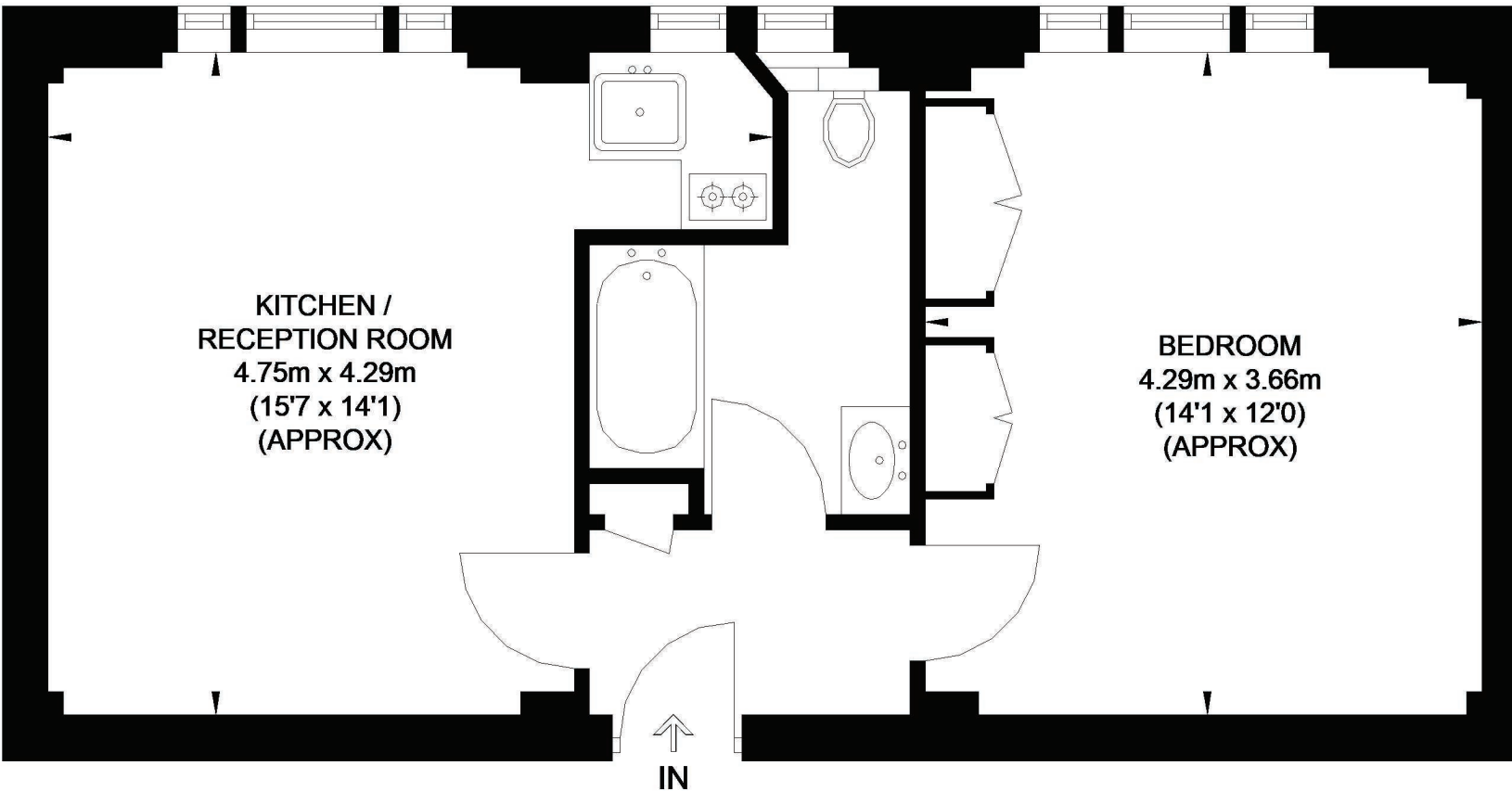

**KITCHEN /
RECEPTION ROOM**
4.75m x 4.29m
(15'7" x 14'1")
(APPROX)

BEDROOM
4.29m x 3.66m
(14'1" x 12'0")
(APPROX)

↑
IN

For Clarification

We wish to inform prospective tenants that we have prepared these particulars as a general guide and they have been confirmed as accurate by the landlord. We have not verified permissions, nor carried out a survey, tested the services, appliances and specific fittings. Room sizes are approximate and measurement figures rounded: they are taken between internal wall surfaces and therefore include cupboards/shelves, etc. Accordingly, they should not be relied upon for

carpets and furnishings. It should also be noted that all fixtures and fittings, carpeted, curtains/blinds, kitchen equipment and garden statuary, whether fitted or not, are deemed removable by the landlord unless specifically itemised with these particulars. Please enquire in office or on our website for details on holding deposit and tenancy deposit figures.

