



Harvey Road | | Evesham | WR11 3BQ

**Guide Price £250,000**

---

COOPER & CO

---

## Key features

- THREE BEDROOM MID TERRACE HOUSE
- GARAGE
- SOUGHT AFTER RESIDENTIAL LOCATION
- NATURALLY LIGHT AND SPACIOUS
- KITCHEN WITH SEPARATE DINING ROOM
- SUN ROOM
- DOWNSTAIRS WC & BATHROOM
- LOW MAINTENANCE PRIVATE REAR GARDEN
- DRIVEWAY FOR TWO CARS
- VIEWINGS 7 DAYS A WEEK

## Description

\*\*\* WELL PRESENTED & SPACIOUS 3 BEDROOM MID-TERRACED PROPERTY WITH GARAGE AND REAR GARDEN IN POPULAR RESIDENTIAL LOCATION CLOSE TO LOCAL SCHOOLS AND AMENITIES \*\*\*

Internally the property boasts Porch, hallway, living room, dining room, kitchen, utility, sun room, downstairs wc, family bathroom, landing, three bedrooms. Externally the property benefits from a secure and low maintenance rear garden, which is well kept, and provides rear access to a single garage. To the front of the property is off road parking via driveway for 2 cars.



#### Front

The property is approached via a well maintained block paved driveway for 2+ cars.

#### Porch

UPVC DG windows to side and front aspects with carpet underfoot.

#### Hallway

Vinyl flooring underfoot, radiator, stairs to first floor and door leading to living room and beyond.

#### Living Room

Carpeted flooring, radiator, UPVC DG windows to front aspect, storage cupboard and doors leading to dining room.

#### Dining Room

Wood affect vinyl flooring, radiator, UPVC DG sliding doors to Sun Room and door to Kitchen.

#### Sun Room

UPVC DG windows to rear and side aspects with UPVC DG patio doors leading to Garden.

#### Kitchen

Tiled flooring, mix of wall and base units surmounted by worktops, splash back tiles, integrated wash hand basin with mixer taps and drainer with space for white goods. Door leading to Utility Room & downstairs WC.







#### Utility

Tiled flooring, part tiled walls, plumbing and electric with ample space for multiple white goods.

#### Downstairs WC

Vinyl flooring, stand alone wash hand basin and WC.

#### Bedroom 1

Carpeted flooring, radiator, integrated double wardrobe and UPVC DG windows to rear aspect.

#### Bedroom 2

Carpeted flooring, radiator and UPVC DG window to front aspect.

#### Bedroom 3

Carpeted flooring, radiator and UPVC DG window to front aspect.

#### Family Bathroom

Fully tiled walls, wood effect vinyl flooring, stand alone wash hand basin, low flush WC, walk in shower, towel rail and UPVC DG window to rear aspect.

#### Garden

Low maintenance Garden with mix of patio and raised decking areas, rear access leading to garage.

#### Garage

Concrete based

# Floor plans

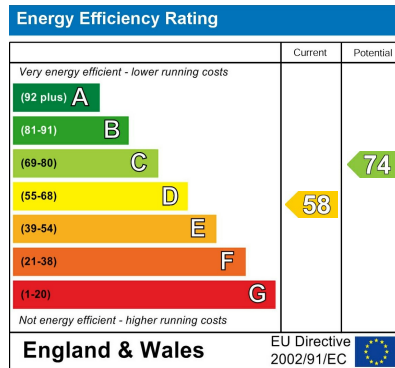
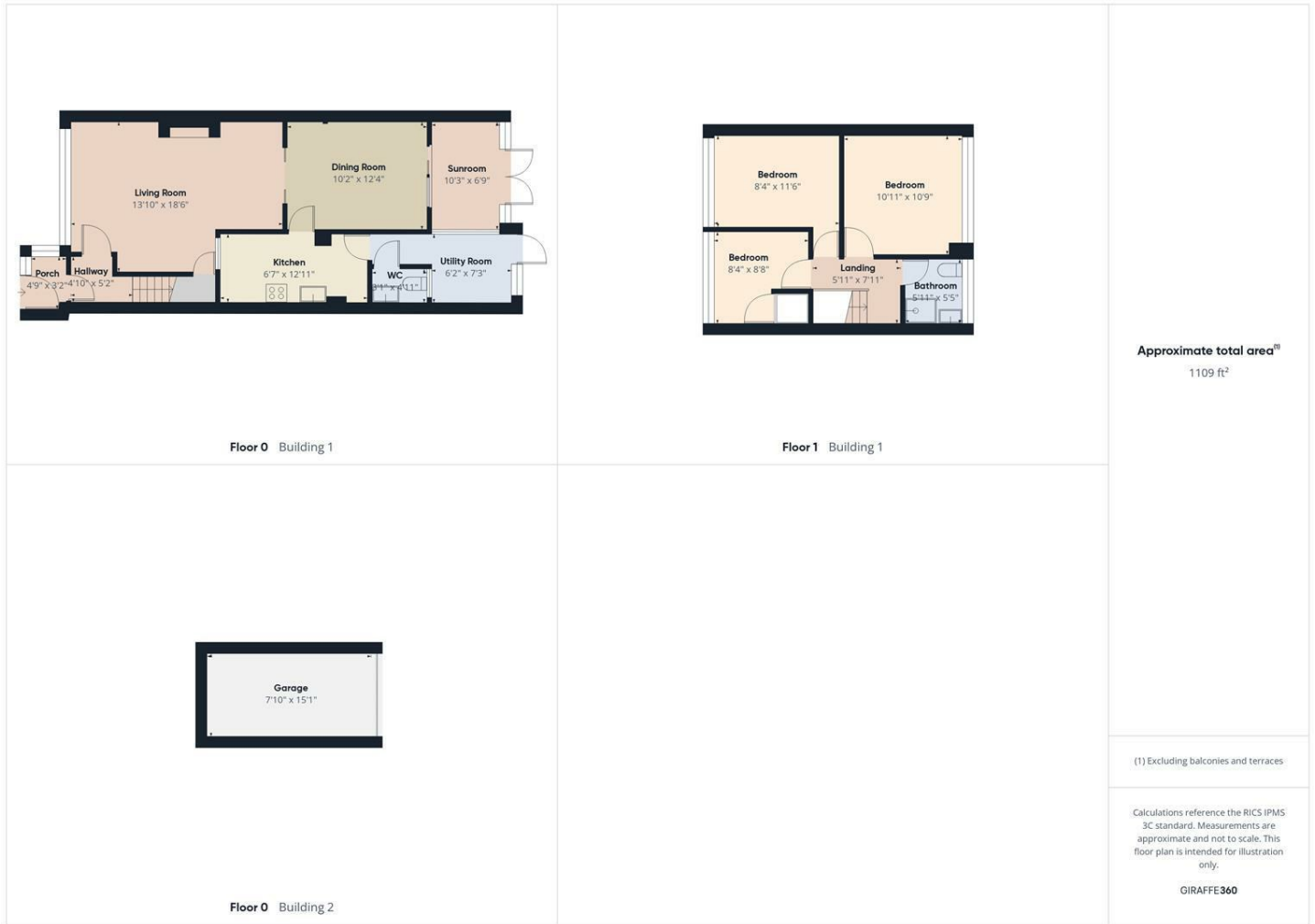

1 Port Street  
Evesham  
Worcestershire  
WR11 3LA  
01386 574 000

sales@cooperandcoestateagents.co.uk