



Harrington Road, Desborough **Freehold** £200,000 O.I.E.O.

**Pattison  
Lane**

# Key Features

 3  1   A

- No Onward Chain
- Semi-Detached Family Home
- Three Bedrooms
- Separate Living / Dining Room
- Outbuildings with an Outside W/C and Storage

Welcome to the market is this three-bedroom, semi-detached family home, offered with no onward chain! Perfectly situated in the heart of Desborough, the property enjoys excellent proximity to local amenities, including a variety of shops, well-regarded schools, and superb road links.



Stepping through the welcoming entrance hallway, you are led into a spacious, dual-aspect living and dining area. The bright living room features sliding patio doors that open directly onto the private rear garden, seamlessly blending indoor and outdoor living. Completing the ground floor is a functional kitchen, complemented by a practical outdoor storage space and an external W.C.

Upstairs, the first-floor landing leads to three well-proportioned bedrooms-including two generous doubles-and a family bathroom.

The rear garden is a standout feature, beautifully maintained with a lush lawn and a patio area perfect for alfresco dining. To the front, the property boasts an attractive front garden that enhances its curb appeal.

Viewings are highly advised to appreciate all this home has to offer!

The accommodation comprises:

ENTRANCE HALL

DINING ROOM 12'2 x 9'9 (3.70m x 2.97m)

LIVING ROOM 11'7 x 14'1 (3.53m x 4.29m)

KITCHEN 10'9 x 6'8 (3.27m x 2.03m)



GROUND FLOOR



1ST FLOOR

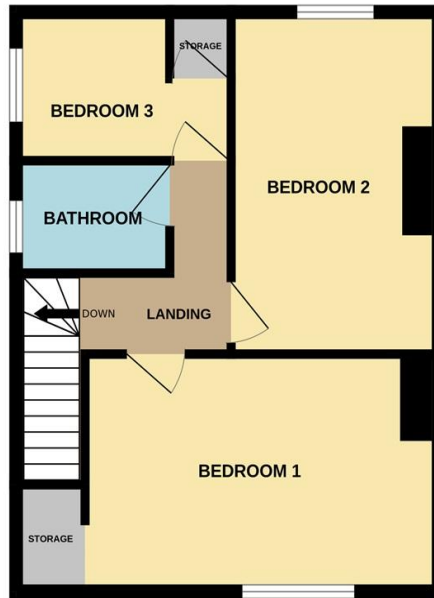

## FIRST FLOOR LANDING

BEDROOM ONE 15'4 x 9'9 (4.67m x 2.97m)

BEDROOM TWO 14'1 x 8'11 max (4.29m x 2.71m)

BEDROOM THREE 9'10 max x 6'1 (2.99m x 1.85m)

BATHROOM 4'2 x 6'8 max (1.27m x 2.03m)

OUTSIDE

FRONT GARDEN

REAR GARDEN

OUTBUILDING WITH STORAGE AND WC

## AGENTS NOTE

The sale of this property is subject to receipt of Grant of Probate. Please obtain an update from the branch with regards to the potential timeframes involved.

Whilst every attempt has been made to ensure the accuracy of the floorplan contained here, measurements of doors, windows, rooms and any other items are approximate and no responsibility is taken for any error, omission or mis-statement. This plan is for illustrative purposes only and should be used as such by any prospective purchaser. The services, systems and appliances shown have not been tested and no guarantee as to their operability or efficiency can be given.  
Made with Metropix ©2026

To view this property call Pattison Lane on:  
**01536 430527**

# Selling your property?



SCAN ME

Contact us to arrange a **FREE** home valuation.

 01536 430527

 42 Station Road, Desborough, KETTERING, Northamptonshire, NN14 2RL

 [desborough@pattisonlane.co.uk](mailto:desborough@pattisonlane.co.uk)

 [www.pattisonlane.co.uk](http://www.pattisonlane.co.uk)



SCAN ME



Sharman Quinney Holdings Limited is registered in England and Wales under company number 4174227, Registered Office is Cumbria House, 16-20 Hockliffe Street, Leighton Buzzard, Bedfordshire, LU7 1GN. VAT Registration Number is 500 2481 05.

1: These particulars do not constitute part or all of an offer or contract. 2: The measurements indicated are supplied for guidance only and as such must be considered incorrect. 3: Potential buyers are advised to recheck the measurements before committing to any expense. 4: Sharman Quinney has not tested any apparatus, equipment, fixtures, fittings or services and it is the buyers interests to check the working condition of any appliances. 5: Sharman Quinney has not sought to verify the legal title of the property and buyers must obtain verification from their legal representative. 6: Intending purchasers will be asked to produce identification documentation at a later stage and we would ask your co-operation in order that there will be no delay in agreeing the sale. Ref: DPL101719 - 0001

