



Connells

Kingfisher Drive  
Westbury





### Property Description

Mid Terrace Property in popular location on the way in to Westbury. Within walking distance of High Street, Primary School & Supermarket, a viewing is highly recommended.

Accommodation comprises Entrance Hall, Kitchen, Lounge / Diner, Landing Two Bedrooms & Bathroom. Outside there is an Enclosed Rear Garden with access to Parking Area.

This would make an Ideal First Time Property.

### Entrance

Door to front aspect. Open access to Kitchen. Door to Lounge / Diner.

### Kitchen

8' 9" x 6' 9" ( 2.67m x 2.06m )

Window to front aspect. Galley style kitchen with wall & base units with work tops over and splashback tiling. Inset sink and drainer. Inset freestanding slot in cooker. Space for appliances.

### Lounge / Diner

16' x 12' 6" ( 4.88m x 3.81m )

Sliding patio doors to rear aspect. Stairs rising to first floor. Radiator.

### Landing

Doors to Bedrooms & Bathroom. Storage cupboard. Loft access.

## Bedroom One

12' 6" x 11' 5" ( 3.81m x 3.48m )  
Window to rear aspect. Radiator.

## Bedroom Two

11' 7" x 6' 3" ( 3.53m x 1.91m )  
Window to front aspect. Radiator.

## Bathroom

Obscure window to front. Three piece suite comprising bath with shower & curtain to side, pedestal wash basin & low level wc. Tiled walls.

## Front Garden

Gravelled area to front. Path to front door.

## Rear Garden

Enclosed by fencing with gated access at the rear. Mainly laid to gravel. Raised patio forms the property.

## Parking

Two car driveway at rear.





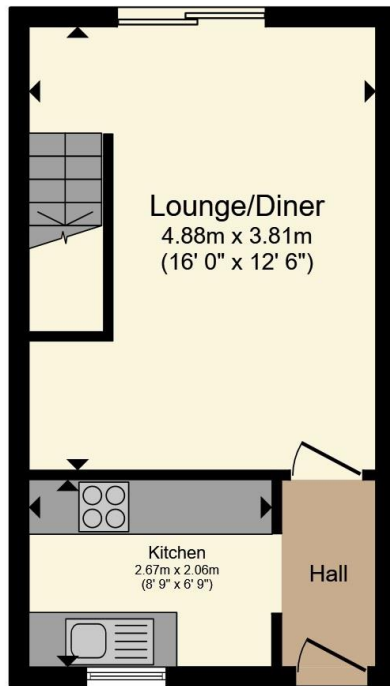

**Ground Floor**

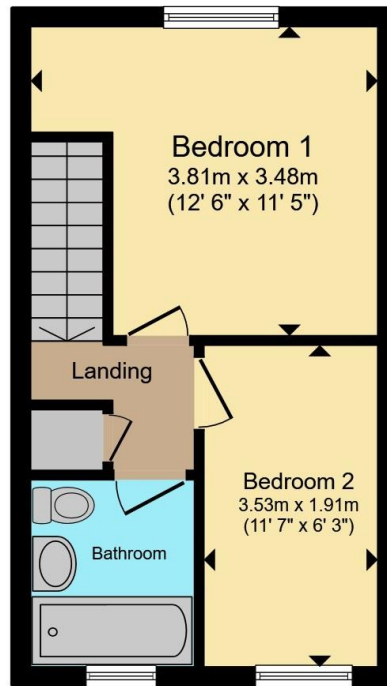

**First Floor**

Total floor area 53.6 m<sup>2</sup> (577 sq.ft.) approx

This floor plan is for illustrative purposes only. It is not drawn to scale. Any measurements, floor areas (including any total floor area), openings and orientation are approximate. No details are guaranteed, they cannot be relied upon for any purpose and they do not form part of any agreement. No liability is taken for any error, omission or misstatement. A party must rely upon its own inspection(s). Powered by [www.propertybox.io](http://www.propertybox.io)

**Connells**



To view this property please contact Connells on

**T 01225 754391**  
**E [trowbridge@connells.co.uk](mailto:trowbridge@connells.co.uk)**

11 Fore Street  
TROWBRIDGE BA14 8HA

EPC Rating: C Council Tax  
Band: B

**view this property online [connells.co.uk/Property/TWB307774](http://connells.co.uk/Property/TWB307774)**

Tenure: Freehold



1. MONEY LAUNDERING REGULATIONS Intending purchasers will be asked to produce identification documentation at a later stage and we would ask for your co-operation in order that there will be no delay in agreeing the sale. 2. These particulars do not constitute part or all of an offer or contract. 3. The measurements indicated are supplied for guidance only and as such must be considered incorrect. Potential buyers are advised to recheck measurements before committing to any expense. 4. We have not tested any apparatus, equipment, fixtures, fittings or services and it is in the buyers interest to check the working condition of any appliances.

Connells Residential is registered in England and Wales under company number 1489613, Registered Office is Cumbria House, 16-20 Hockliffe Street, Leighton Buzzard, Bedfordshire, LU7 1GN. VAT Registration Number is 500 2481 05.

**See all our properties at [www.connells.co.uk](http://www.connells.co.uk) | [www.rightmove.co.uk](http://www.rightmove.co.uk) | [www.zoopla.co.uk](http://www.zoopla.co.uk)**

Property Ref: TWB307774 - 0007