

6 Gladiator Close, Gloucester, GL3 4US

Asking Price £280,000

This spacious three-bedroom semi-detached property is ideally located in a quiet cul-de-sac and is offered with no onward chain. The home has been extended to provide a larger dining room, creating excellent space for family living and entertaining. Externally, the property benefits from a generous garden to both the side and rear, offering plenty of outdoor space. Further features include a garage and driveway parking, making this an ideal home for families or buyers seeking a well-proportioned property in a desirable, peaceful location.

- Chain Free
- Corner Plot
- Extended
- Garage & Driveway Parking
- Quiet Location
- Three Bedrooms

Approx Gross Internal Area
80 sq m / 862 sq ft

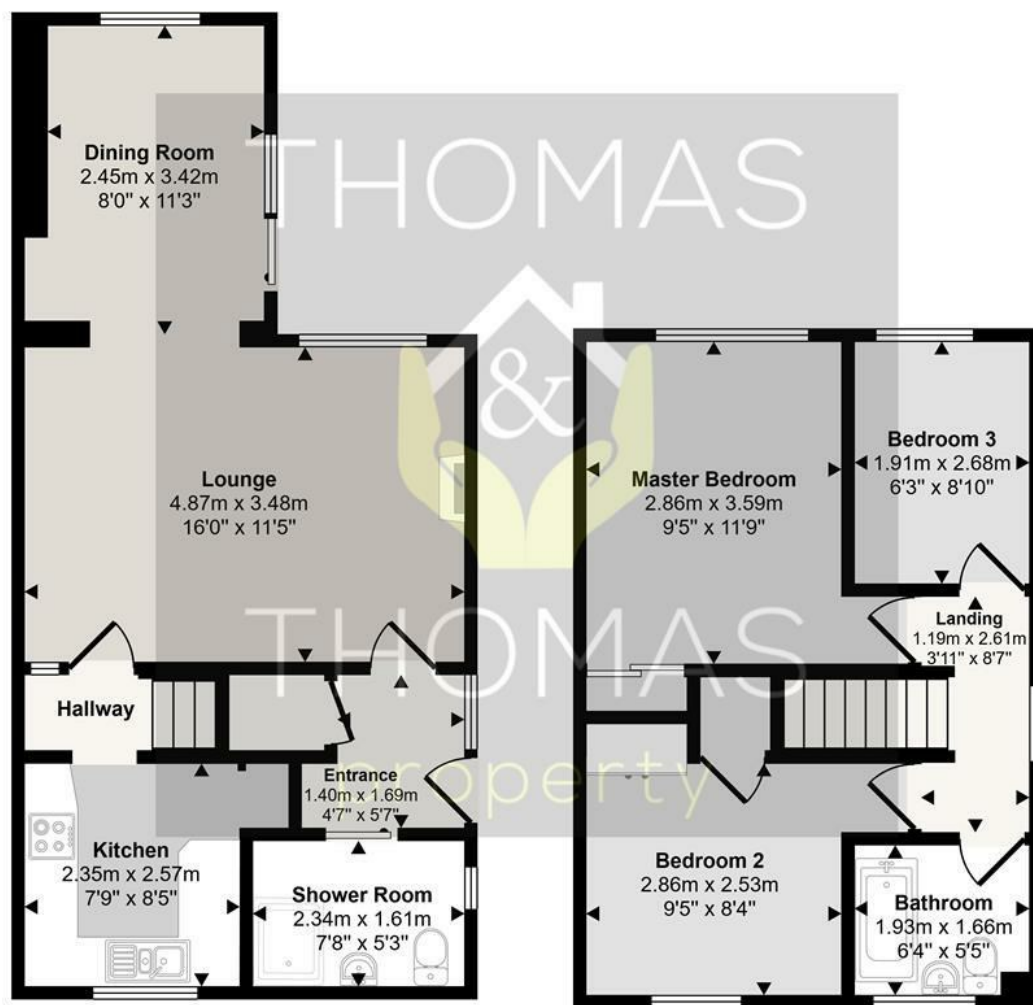

This floorplan is only for illustrative purposes and is not to scale. Measurements of rooms, doors, windows, and any items are approximate and no responsibility is taken for any error, omission or mis-statement. Icons of items such as bathroom suites are representations only and may not look like the real items. Made with Made Snappy 360.

Energy Efficiency Rating		
	Current	Potential
Very energy efficient - lower running costs		
(92 plus) A		
(81-91) B		
(69-80) C		
(55-68) D		
(39-54) E		
(21-38) F		
(1-20) G		
Not energy efficient - higher running costs		
England & Wales	73	80
EU Directive 2002/91/EC		

Environmental Impact (CO ₂) Rating		
	Current	Potential
Very environmentally friendly - lower CO ₂ emissions		
(92 plus) A		
(81-91) B		
(69-80) C		
(55-68) D		
(39-54) E		
(21-38) F		
(1-20) G		
Not environmentally friendly - higher CO ₂ emissions		
England & Wales		
EU Directive 2002/91/EC		

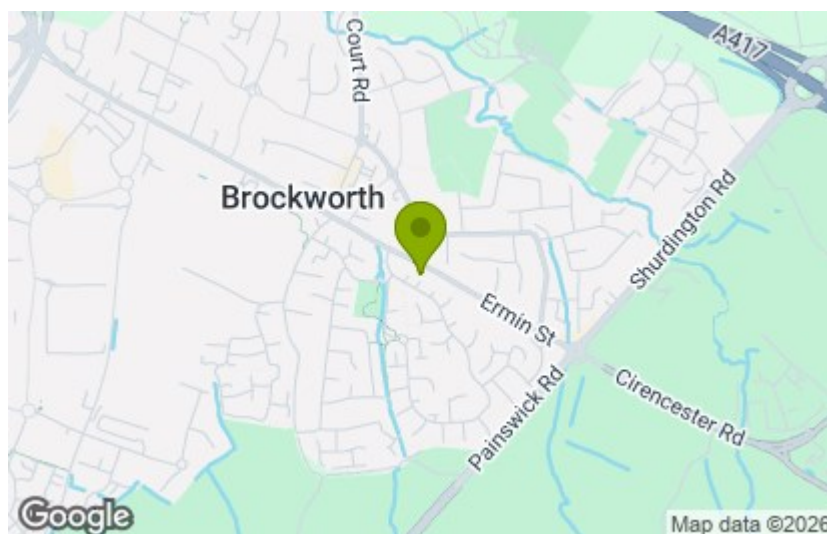

These particulars, whilst believed to be accurate are set out as a general outline only for guidance and do not constitute any part of an offer or contract. Intending purchasers should not rely on them as statements of representation of fact, but must satisfy themselves by inspection or otherwise as to their accuracy. No person in this firm's employment has the authority to make or give any representation or warranty in respect of the property.

www.thomasproperty.co.uk