



## Fountain Road, SW17

### £550,000

A charming two bedroom home with huge scope for extending and further alterations (STPP). Accommodation includes a front reception room, rear dining room, a fitted kitchen with direct access onto a private garden and two bedrooms and a three piece family bathroom.

Fountain Road is located for both central Tooting & Earlsfield with their many shops, bars and restaurants on the doorstep and excellent transport links of Tooting Broadway Underground station within walking distance.

### Features

- Two Bedrooms
- Freehold Home
- Private Garden
- Potential to Extend (STPP)
- Dining Room
- Desirable Location

# Fountain Road, London, SW17

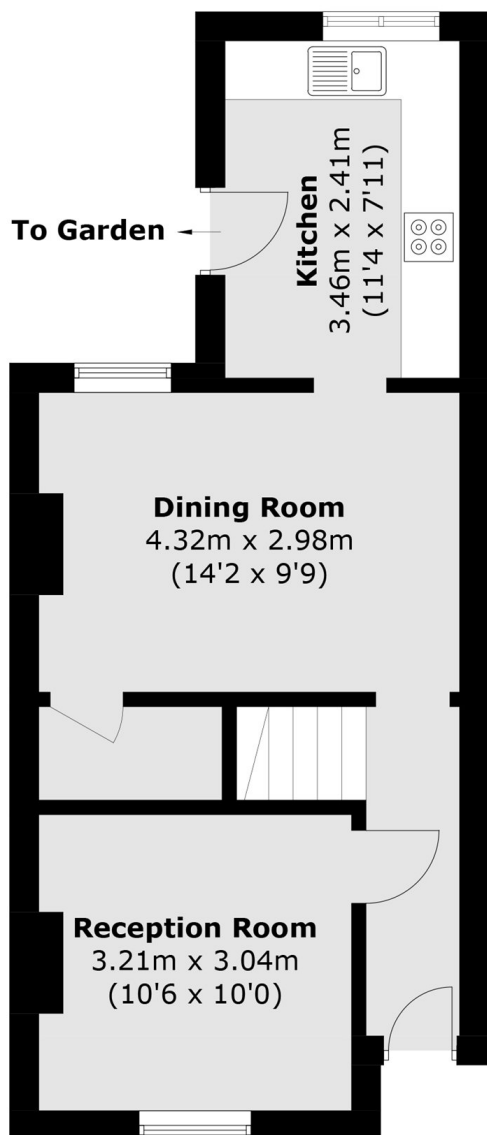

**Ground Floor**

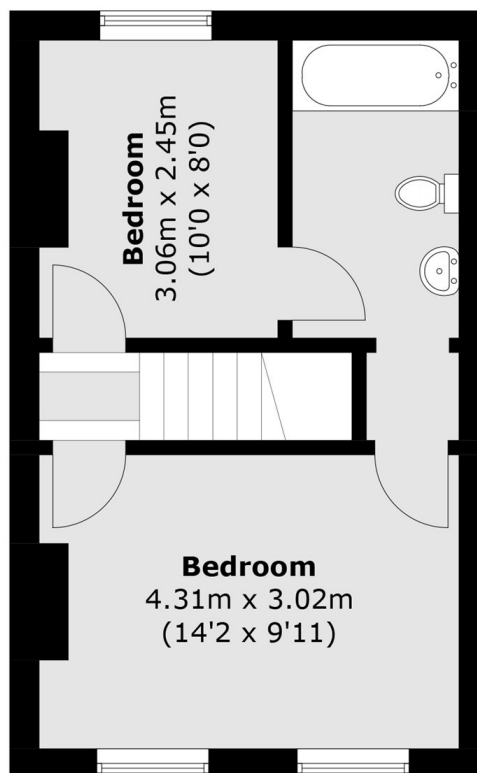

**First Floor**

Total area (approx.): 71.4 sq. m (768.5 sq. ft)