



Ennismore Gardens
Knightsbridge, SW7

CHESTERTONS





Exceptionally spacious period apartment set in a stucco fronted conversion on one of London's most sought-after garden squares.

The accommodation is circa 1,571 sq ft and benefits from two spacious double bedrooms, modern bathrooms, and a large reception/dining room with a modern open plan kitchen.

Ennismore Gardens is perfectly located opposite Hyde Park and just a short walk from both South Kensington and the amenities and popular shopping experience offer on Brompton Road and Harrods.

- Lift
- Own private entrance
- Fully furnished
- Modern
- Private courtyard

£9,500 pcm

Additional tenant charges apply (fees apply to non-AST tenancies only)

Tenancy Agreement Fee: £300

References per Tenant/Guarantor: £60

Inventory check (approx. £100 – £250 inc. VAT)

chestertons.co.uk/property-to-rent/applicable-fees

Energy Efficiency Rating		Current	Potential
92-100	A		
81-91	B		
69-80	C		
55-68	D		
39-54	E	39	55
21-38	F		
1-20	G		

Not energy efficient - higher running costs

EU Directive 2002/91/EC

Minimum Term: 6 months
Deposit Required: 6 weeks
Local Authority: Westminster
Council Tax Band: G
EPC Rating: E
Furnished

Chestertons Knightsbridge & Belgravia Lettings

31 Lowndes Street
 London
 SW1X 9HX

knightsbridgelettingsusers@chestertons.co.uk
 02072353530
chestertons.co.uk

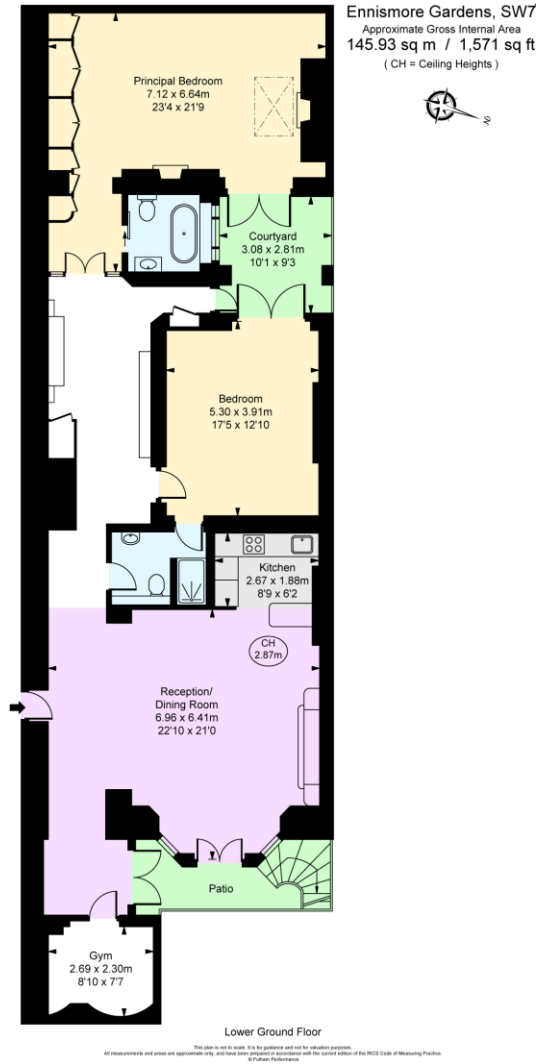

Chesterton UK Services Limited trading as Chestertons for themselves and for the vendor of this property whose agents they are, give notice that (i) these particulars do not constitute any part of an offer or contract, (ii) all statements contained within these particulars are made without responsibility on the part of Chestertons or the vendor, (iii) whilst made in good faith, none of the statements contained within these particulars are to be relied upon as a statement or representation of fact, (iv) any intending purchasers must satisfy themselves by inspection or otherwise as to the correctness of each of the statements contained within these particulars, (v) the vendor does not make or give either Chestertons or any person in their employment any authority to make or give representation or warranty whatsoever in relation to this property. Wide angle lenses may be used. ©Copyright Chestertons | Chesterton Global Ltd | Registered Office 40 Connaught Street, Hyde Park, London W2 2AB Registered Company Number 05334580.

